

Entering the vehicle

UNLOCKING THE VEHICLE

⚠ To prevent accidental or unauthorised operation, never leave children or animals unattended in the vehicle. The vehicle can be operated when the Smart key is inside the vehicle.

Note: The operational range of the Smart key will vary considerably, depending on atmospheric conditions and interference from other transmitting devices.

Note: If any door, or the tailgate, is unlocked 10 times within a short period, the latch is disabled for approximately one minute.

The vehicle is supplied with two Smart keys. The Smart keys act as remote controls for the locking and alarm system, and allow the vehicle to be locked, unlocked and driven without the use of a conventional key. See **9, KEYLESS ENTRY, 18, KEYLESS LOCKING** and **117, STARTING THE ENGINE**. Each Smart key also has an emergency key housed behind a slide off cover.

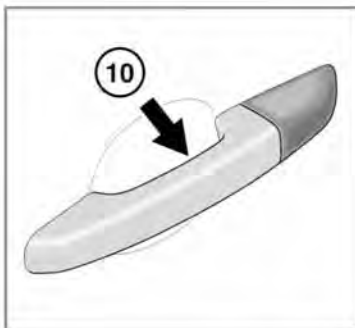
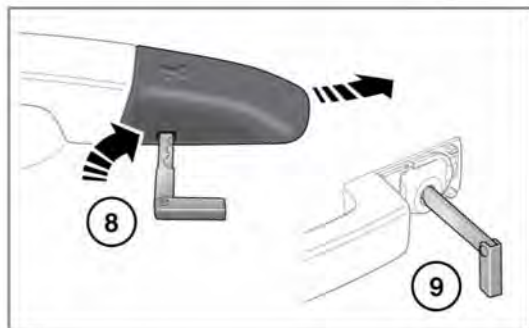
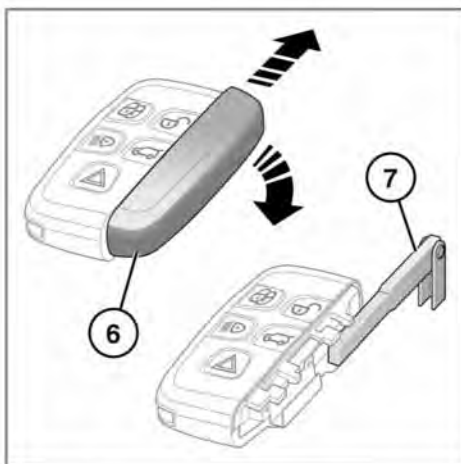
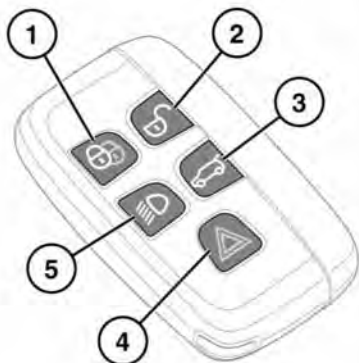

E174902

1. Lock: Press to secure the vehicle. The vehicle Single locks. In some markets, a second press Double locks the vehicle. See **17, SINGLE LOCKING, 17, DOUBLE LOCKING**. If Power-fold mirrors are fitted and enabled, they fold in. See **75, EXTERIOR MIRRORS**. Press and hold to activate Global closing. See **19, GLOBAL CLOSING**.
2. Unlock: Press briefly to unlock the vehicle and deactivate the alarm. The hazard warning lamps flash twice to indicate that the vehicle is unlocked and the alarm is deactivated. The interior lamps illuminate to assist entry to the vehicle.
If Power-fold mirrors are fitted and enabled, they unfold. Press and hold to activate Global opening. See **8, GLOBAL OPENING**.
3. Luggage compartment: Press briefly to release/open the Luggage compartment. If the vehicle is locked and armed, all other doors remain closed and the exterior alarm remains active while the vehicle is open, but intrusion and inclination sensing systems are disabled until the vehicle is closed again.
When closing, if the vehicle is already locked and armed, the hazard warning lamps flash after a few seconds to confirm that the full alarm system is reactivated. An audible sound is given when the vehicle is double locked. See **10, OPENING AND CLOSING THE TAILGATE**. See also **12, OPENING AND CLOSING THE POWERED TAILGATE**.

Note: Make sure the Smart key does not remain in the vehicle prior to closure. It may not be detected if it is placed inside a metal container, if it is shielded by a device with a back-lit LCD screen, (e.g., laptop, smartphone, etc.), or if the vehicle is in an area of localised Radio Frequency (RF) interference. If the Smart key is not detected inside the vehicle, the vehicle allows locking to take place. The vehicle does NOT automatically unlock. The vehicle now unlocks only with another valid Smart key.

4. Panic alarm:
 - Press and hold for three seconds (or press three times within three seconds) to activate the horn and the hazard lamps.
 - Once active for more than five seconds, the alarm can be cancelled by pressing the button and holding for three seconds (or pressing three times within three seconds).
 - The panic alarm is also cancelled if a valid Smart key is present when the START/STOP button is pressed.
5. Approach illumination:
 - When approaching the vehicle during darkness, press to switch on the approach illumination. Press again to switch the approach lamps off.
 - The approach illumination pre-set delay period, is 30 seconds. This delay period can be configured to provide illumination lasting between 0 and 240 seconds. See **56, INSTRUMENT PANEL MENU**.

Entering the vehicle

6. Emergency key access: Slide open the side cover to release, then remove.
7. Remove the emergency key blade and unfold.
8. If the Smart key fails to open the vehicle, insert the key blade into the slot at the base of the driver's door lock cover. Apply slight downward pressure to the top of the cover and gently lever the key blade upwards. Carefully rotate the door lock cover upwards, to lever the cover off the retaining lugs.
9. Insert the key blade into the exposed lock and turn to operate the lock. The alarm sounds until the Smart key is positioned correctly, to disarm the alarm: see **118, KEYLESS START BACKUP**.
- Note:** When replacing the door lock cover, locate the top retaining lugs first. Press down and inwards to locate the single bottom lug. The lug clicks into the locked position. Check the security of the cover. An insecure cover is likely to fall off while the vehicle is moving.*
10. Keyless entry/exit: Exterior door handles have separate unlock and lock sensors. The unlock sensor is located on the inner surface of the handle.

Note: A replacement Smart key can be obtained only from a Retailer/Authorised Repairer. The Retailer/Authorised Repairer will require proof of identification and ownership.

Notify your Retailer/Authorised Repairer immediately if a Smart key is lost or stolen.

SINGLE/MULTI-POINT ENTRY

Press the unlock button; the vehicle unlocks in one of two ways:

1. Single-point entry: On the first press, the driver's door unlocks. If a locking fuel filler flap is fitted, it also unlocks. A second press is required to unlock the remaining doors and luggage area.
2. Multi-point entry: On the first press, all of the doors, the fuel filler flap and the luggage area unlock.

To change from Single to Multi-point entry (or vice versa), press both the lock and unlock buttons simultaneously for three seconds. The hazard warning lamps flash twice to confirm the change.

This feature may also be set via **Vehicle Set-up** in the Instrument panel menu. See **56, INSTRUMENT PANEL MENU**.

Note: If an audible warning is emitted when the vehicle is unlocked, there may be a fault with the alarm sensors. Consult a Retailer/Authorised Repairer as soon as possible.

GLOBAL OPENING

Press and hold the Smart key unlock button for three seconds to unlock the vehicle and open all of the windows.

To cancel Global opening, press any of the buttons on the Smart key or operate the driver's window switches. To stop a particular window opening, operate the relevant window switch.

Note: Global opening can be enabled and disabled via the Instrument panel menu. See **56, INSTRUMENT PANEL MENU**.

KEYLESS ENTRY

Keyless entry allows the vehicle to be opened if a Smart key is within 1.0 m of the door handle or the rear external switch.

Note: *The Smart key may not be detected if it is placed within a metal container, or if it is shielded by a device with a back-lit LCD screen, such as a smartphone, laptop (including when inside a laptop bag), games console, etc. Keep the Smart key clear of such devices when attempting Keyless entry, Keyless locking or Keyless starting.*

Note: *The Smart key needs only to be on the driver's person, or in a non-metallic bag or briefcase. It does not need to be exposed or handled.*

The keyless unlocking sensor is located on the inner surface of the door handle. Grip and pull the door handle to open the door. The vehicle unlocks, the alarm system is disarmed and the hazard warning lamps flash twice as 'unlock' confirmation. If Power-fold mirrors are fitted and enabled, they fold out.

Note: *If Single-point entry is the current security setting and a door other than the driver's door is opened first, all of the doors unlock.*

When all of the open doors have been closed, after entering the vehicle, the vehicle scans the interior for a valid Smart key. If a valid Smart key is not detected, **SMART KEY NOT FOUND** is displayed in the Message centre. If this situation occurs, then use a valid Smart key to carry out the **Keyless start backup procedure**. See **118, KEYLESS START BACKUP**.

The security system fitted to this vehicle is Thatcham category 1 approved and meets EU regulations 97/116 and EU directive 95/56 EC.

INSTRUCTIONAL VIDEO



E166649

CONVENIENCE MODE

When the driver's door is opened using either the Smart key or Keyless entry, the vehicle's electrical system initiates the Convenience mode. The following systems become functional:

- Driver position memory.
- Seat and steering column adjustment.
- Interior and exterior lighting.
- Message centre.
- Auxiliary power socket.

SMART KEY SYSTEM TRANSMITTERS

 Any person fitted with an implanted medical device should make sure the device is kept at a distance of at least 22 cm away from any transmitter mounted in the vehicle. This is to avoid any possibility of interference between the system and device. Interference may cause the implanted medical device to malfunction, causing serious injury or death. For more information on the locations of the security system transmitters, see 318, SMART KEY TRANSMITTER LOCATIONS.

STEERING COLUMN LOCK

Your vehicle may be fitted with an electronic steering column lock, which locks and unlocks in conjunction with the vehicle's locking system. It also locks automatically, after a time delay, when the ignition is switched off and the Smart key is removed from the vehicle.

 During vehicle recovery, a Smart key must remain inside the vehicle, so that the electronic steering column lock remains unlocked.

Any malfunction of the steering column lock is indicated by the message **Steering Column Locked** displayed in the Message centre. If this occurs:

1. Lock and then unlock the vehicle using the Smart key.
2. Try again to unlock the steering column lock, by turning the steering wheel gently to the left and right.

Note: This situation may occur if the steering column is under load, e.g. if the vehicle is parked with the steering on full lock, the steering wheel position may inadvertently press a front tyre against a kerb, etc.

If the problem persists, seek qualified assistance immediately.

DRIVE-AWAY LOCKING

Drive-away locking automatically locks all of the doors when the vehicle reaches a set speed. This feature can be enabled/disabled via **Drive-away locking** in the Instrument menu. See 56, INSTRUMENT PANEL MENU.

Note: Pressing the unlock or lock button on the driver or front passenger door after Drive-away locking has taken place, overrides Drive-away locking for the current journey. See 20, DOOR LOCKS AND RELEASE LEVERS.

OPENING AND CLOSING THE TAILGATE

 While the tailgate is open, the locking latch is exposed. Do not attempt to manually close the latch, as it may also automatically 'soft close' and trap items or body parts.

 Make sure there is sufficient space above and at the rear of the vehicle, before operating the tailgate. Insufficient opening space may result in damage to the vehicle.

 Do not operate the tailgate if a cycle rack is fitted to the tailgate. Remove any cycles and/or racks before operating the tailgate.

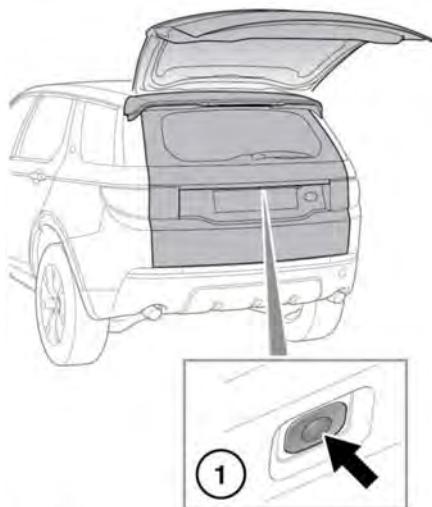

E161640

1. Tailgate release: Press to release and then lift the tailgate to open.

Note: The tailgate external release operates if all of the doors are unlocked and the gear selector is in the Park (P) position. If the gear selector is in the Neutral (N) position, the external release operates only if all of the doors are unlocked, and the ignition is in Convenience mode or switched off. It will not operate if the gear selector is in any other position.

The tailgate can also be released using the following methods:

- The interior tailgate release switch.
- The Smart key tailgate release button.

Note: The tailgate will not open if the vehicle is travelling at, or above, approximately 5 km/h (3 mph).

Closing the tailgate: As the closing tailgate reaches its lowest position, it will automatically 'soft close' to the fully closed position. Do not slam the tailgate.

Note: If a valid Smart key cannot be detected within 1 m of the rear of the vehicle, an audible warning sounds to indicate a mislock and the tailgate re-opens after approximately three seconds.

Note: If the Smart key is inadvertently left inside the loadspace and the vehicle is locked and the alarm set, an audible warning sounds to indicate a mislock and the tailgate re-opens after approximately three seconds. The Smart key may not be detected if it is placed within a metal container, or if it is shielded by a device with a back-lit LCD screen, such as a smart phone, laptop (including when inside a laptop bag), games console, etc.

Note: Make sure the tailgate is fully closed before leaving the vehicle unattended. Visible and audible warnings indicate if the vehicle is locked and the alarm armed. If there are no visible or audible warnings upon closing the tailgate, the vehicle may be unprotected.

OPENING AND CLOSING THE POWERED TAILGATE

 Before operating the tailgate, make sure anyone in the vicinity does not have any part of their body in a position where it could be trapped. Note that the 'soft-close' action does not incorporate object detection. Death or serious injury could occur, even with an object detection system. While the tailgate is open, the locking platform and latch are exposed. Do not manually close the latch as it may also automatically 'soft-close' and trap items or body parts.

 Make sure there is sufficient space above and at the rear of the vehicle, before operating the tailgate. Insufficient opening space may result in damage to the vehicle.

 Do not operate the tailgate if a cycle rack is fitted to the tailgate. Remove any cycles and/or racks before operating the tailgate.

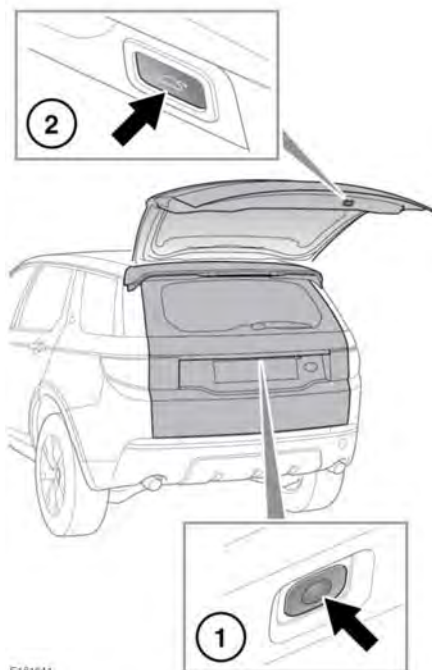

E181641

1. Tailgate open/close: Press to open, stop, reverse direction or close the tailgate.
2. Tailgate close: Press to close/stop the tailgate.

Note: The tailgate external release operates if all of the doors are unlocked and the gear selector is in the Park (**P**) position. If the gear selector is in the Neutral (**N**) position, the external release operates only if all of the doors are unlocked, and the ignition is in Convenience mode or switched off. It will not operate if the gear selector is in any other position.

The powered tailgate can also be opened or closed using the following methods:

- The interior tailgate release switch.

- The Smart key tailgate release button.

Note: The tailgate will not open if the vehicle is travelling at, or above, approximately 5 km/h (3mph).

After the tailgate has opened to its set height, it can be manually raised or lowered. If the tailgate fails to open or close correctly, close it manually and then press the tailgate release switch again.

As the closing tailgate approaches the closed position, it 'soft closes' to the fully closed position. If the vehicle was previously locked, the alarm re-arms. The hazard warning lamps flash to confirm the alarm status. An audible confirmation may also be given.

Note: If a tailgate switch is pressed while the tailgate is opening or closing, all movement stops. However, if a button is pressed during the 'soft close' stage, it will be ignored.

Object detection while opening: If an object is detected that would interfere with the tailgate opening, tailgate movement stops. Remove any obstructions and press the tailgate switch again to open.

Object detection while closing: If an object is detected that would interfere with a tailgate closing, tailgate movement stops and then reverses to the fully open position, if able to do so. An audible warning is given to indicate a mislock.

Remove any obstructions and if the tailgate is open, press the tailgate switch again to close the tailgate. If the tailgate is not open, press a tailgate release switch to open the tailgate and then remove any obstructions. Once the obstructions have been removed, press the tailgate close switch to close the tailgate.

Note: If a valid Smart key cannot be detected within 1 m of the rear of the vehicle, the tailgate will not power close. An audible warning sounds to indicate a mislock.

If the Smart key is inadvertently left inside the loadspace and the vehicle is locked and the alarm set, an audible warning sounds to indicate a mislock and the tailgate re-opens after approximately three seconds. The Smart key may not be detected if it is placed within a metal container, or if it is shielded by a device with a back-lit LCD screen, such as a smart phone, laptop (including when inside a laptop bag), games console, etc. If the tailgate is closed manually, the vehicle searches for a valid Smart key. If no Smart key can be found within 1m of the rear of the vehicle, or a Smart key remains inside the vehicle, an audible warning sounds to indicate a mislock and the tailgate re-opens after approximately three seconds.

INSTRUCTIONAL VIDEO



E166648

GESTURE TAILGATE



Make sure there is sufficient space above and at the rear of the vehicle, before operating the tailgate. Insufficient opening space may result in damage to the vehicle.



Do not operate the tailgate if a cycle rack is fitted to the tailgate. Remove any cycles and/or racks before operating the tailgate.

Entering the vehicle

Sensors, positioned within the outer parts of the rear bumper, recognise movement of a foot below the bumper level, and allow automatic opening or closing of a powered tailgate.

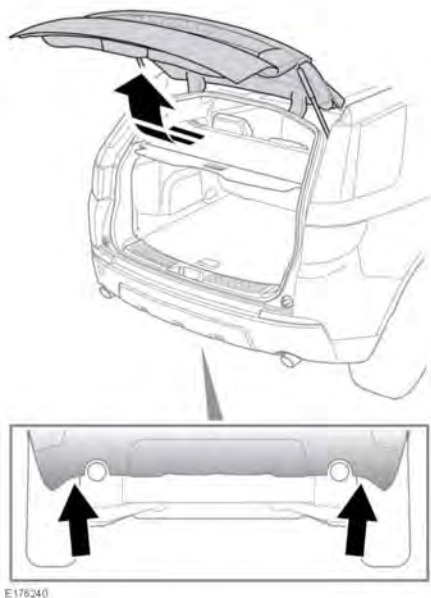

With the ignition off, approach the rear of the vehicle and perform a smooth upward kick movement, taking between one and two seconds, beneath one of the rear sensor areas. When a valid upward kick movement is recognised by the vehicle, the direction indicators flash and the tailgate operates. If an audible warning is given, the tailgate does not operate.



Make sure that the standing area is stable and not slippery, before performing the kick movement.



Do not make contact with the vehicle exhaust. It may be hot and cause injury.

Note: A valid Smart key must be within 1.2 m of the tailgate. The Smart key may not be detected if it is placed within a metal container, or if it is shielded by a device with a back-lit LCD screen, such as a smartphone, laptop (including when inside a laptop bag), games console, etc. Keep the Smart key clear of such devices when attempting hands-free tailgate operation of the powered tailgate.

Note: Certain conditions may affect the performance of the sensors, and movement beneath the bumper may not be detected. If this should happen, use the interior tailgate release switch or the Smart key tailgate release button. Check the operation of the Gesture tailgate when the vehicle is in a new location.

Unintentional opening: In exceptional circumstances, and if the Smart key is within 1.2 m of the tailgate, the powered tailgate may open unintentionally due to the following:

- Car washing / high pressure cleaning.
- Moving objects beneath the rear bumper sensors.
- While changing a rear road wheel.

TAILGATE OPENING HEIGHT

Set the maximum opening height as required:

1. Open the tailgate to the position required as the maximum height. Press any tailgate control to stop movement at the required position. The final position can be achieved manually, if required.
2. Make sure the tailgate is stationary for at least three seconds.

3. Press and hold the tailgate close switch for 10 seconds to set the required opening height.
4. Press a close switch to close the tailgate, then open again to check that it opens to the required height.

Note: If, after performing part 3 of the process, the tailgate closes automatically, the required height has not been set. Repeat the process, making sure that all steps are adhered to.

To reset the maximum opening height, repeat the process, but when the tailgate reaches its current programmed height, manually move it to the fully open position, before pressing and holding the button.

The tailgate may lose its position memory if there are multiple object detections, or if the battery voltage is low. Powered operation may be inhibited.

To reset the tailgate:

1. Manually close the tailgate.
2. Press a release switch.
3. Allow the tailgate to power fully open, or to the previously set position.
4. Press and release the close switch.
5. Allow the tailgate to power close fully. The tailgate's programmed memory is now be restored.

SMART KEY BATTERY REPLACEMENT

When the battery needs replacing, there is a significant decrease in the effective range and **SMART KEY BATTERY LOW** is displayed in the Message centre.

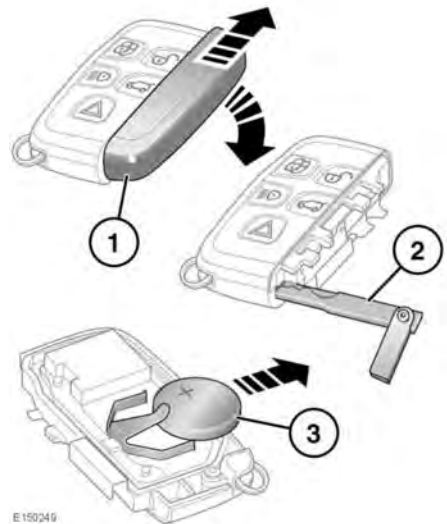

To replace the battery:

1. Remove the cover by sliding in the directions of the arrows.
2. Use the emergency key blade to separate the Smart key body.
3. Fit a new and unused CR2032 type battery (available from a Retailer/ Authorised Repairer) with the positive (+) side upwards.

Note: Avoid touching the new battery. Moisture/oil from fingers can reduce battery life and corrode the contacts.

Entering the vehicle

Note: If the low battery warning does not extinguish, this indicates that the replacement battery is not in a new and unused condition.

Refit the parts in reverse order, making sure that they click securely into place.



Battery disposal: Batteries contain harmful substances and must be disposed of correctly. Seek advice on disposal from a Retailer/Authorised Repairer and/or your local authority.

SMART KEY CARE



To prevent accidental or unauthorised operation, never leave the Smart key unattended in the vehicle. Never leave children or animals unattended in the vehicle. The vehicle can be operated when the Smart key is inside the vehicle.

Do not expose to extremes of heat, dust or humidity, or allow contact with fluids.

Do not leave the Smart key exposed to direct sunlight.

The emergency key blade number is recorded on an attached label. Peel off the label and keep it safe, but not in the vehicle.

The operational range of the Smart key will vary considerably, depending on atmospheric conditions and interference from other transmitting devices.

Note: The Radio Frequency (RF) used by the Smart key may be used by other devices (e.g., medical equipment). This may prevent the Smart key from operating correctly.