

EXTERIOR MIRRORS

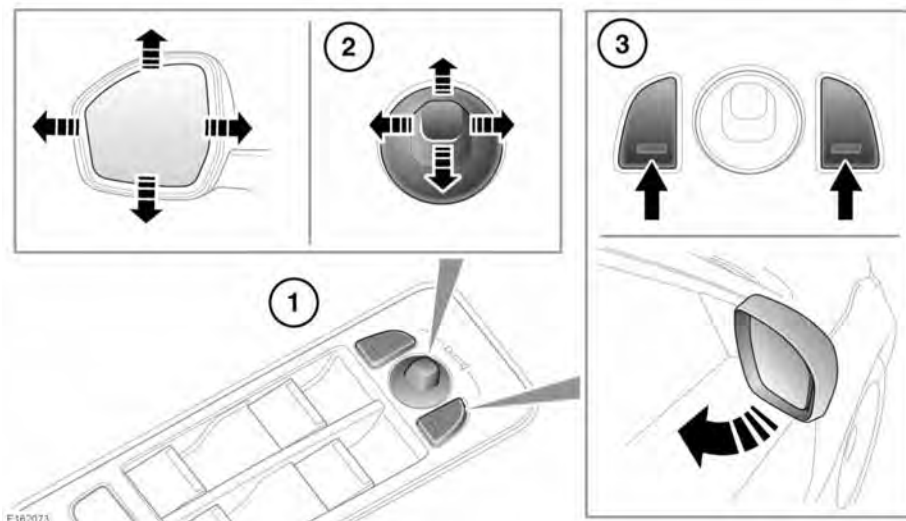

1. Mirror selector switches: Press to select the left or right mirror.
2. Mirror adjustment switch: Move up/down/left or right to adjust the mirror's glass position.
3. Press both mirror selector switches together to fold/unfold the mirrors (power-fold option).

The mirrors can be adjusted and folded when the ignition is on and for up to 5 minutes after the ignition is switched off, provided the driver's door is not opened.

Note: Power-fold will operate only if the vehicle's speed is below 113 km/h (70 mph).

Note: A thermal cut-out will temporarily disable the power-fold feature if the switches are operated repeatedly.

Note: The rear-view door mirror heaters operate automatically according to the external temperature and windscreen wiper operation.

Note: An amount of knock protection is designed into the door mirrors. If a mirror is accidentally knocked inwards or manually folded inwards, the mirror head will be disengaged from the folding mechanism. To re-engage the mechanism, fold then unfold the mirror using the switch.



The mirrors can be configured by a Retailer/Authorised Repairer to automatically fold when the vehicle is locked, and unfold when it is unlocked.

Note: If the mirrors were folded using the switches, they will not unfold when the vehicle is unlocked.

MIRROR DIP WHEN REVERSING

Selecting Reverse (**R**) gear will cause both of the door mirrors to automatically adjust, providing an improved viewing angle for reversing.

The dipped position of the mirrors is a preset position. In **R**, the mirrors can be adjusted, but the new position cannot be saved.

When the gear selector is moved out of **R**, the mirrors will return to their previous position.

Note: *If the vehicle's speed exceeds 12 km/h (7 mph) in **R**, the mirrors will return to their normal driving position for enhanced visibility.*

The automatic Mirror dip feature can be enabled/disabled in the Instrument panel menu. See **56, INSTRUMENT PANEL MENU**.

HEATED MIRRORS

The rear-view door mirror heaters operate automatically according to the external temperature and the heated rear screen operation.