

TOWING WEIGHTS

See **315, WEIGHTS**, for details of the Gross Vehicle Weight (GVW), Gross Train Weight (GTW) and axle weights.

Trailer	Variant	Maximum weight (kg)
Unbraked trailers	All vehicles	750
Braked trailer	2.2L Diesel (150PS) manual with 5 seats	1 800
	2.2L Diesel (190PS) manual with 5 seats	2 000
	2.2L Diesel (150PS) manual with 7 seats	1 750
	2.2L Diesel (190PS) manual with 7 seats	2 000
	2.2L Diesel (150PS) automatic with 5 seats	2 200
	2.2L Diesel (190PS) automatic with 5 seats	2 500
	2.2L Diesel automatic with 7 seats	2 200
Braked trailer	2.0L Diesel manual	2 000
	2.0L Diesel (150PS) automatic with 5 seats	2 200
	2.0L Diesel (180PS) automatic with 5 seats	2 500
	2.0L Diesel automatic with 7 seats	2 200
Braked trailer	All Petrol vehicles	2 000
Nose weight*	Vehicles with 5 seats	150
	Vehicles with 7 seats	100

*The nose weight can be increased to a maximum of 175 kg for vehicles with 5 seats and to a maximum of 125 kg for vehicles with 7 seats. Make sure that the maximum rear axle, the GVW and the GTW weights are not exceeded.

Europe only

When towing, the maximum permissible GVW can be increased by a maximum of 100 kg, provided that the road speed is limited to 97 km/h (60 mph) or less.

Note: When calculating the rear axle loading, remember that the trailer's nose weight, the load in the vehicle's loadspace, the weight on the rails/roof rack and the weight of rear seat passengers, must all be added together.

TOW BALL OPTIONS

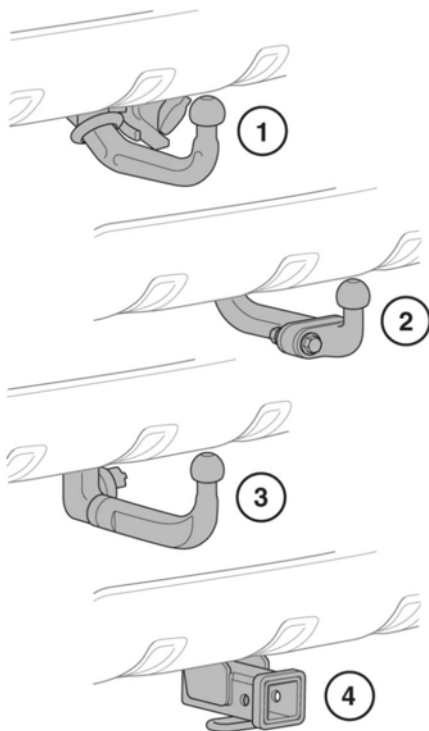

E164963

Tow ball options for 5 seat vehicles and 7 seat vehicles without a spare wheel:

1. Powered tow ball.
2. Bolt on tow ball.
3. Detachable tow ball.

4. Trailer hitch tow bar. See **109, TRAILER HITCH (Australia only)**.

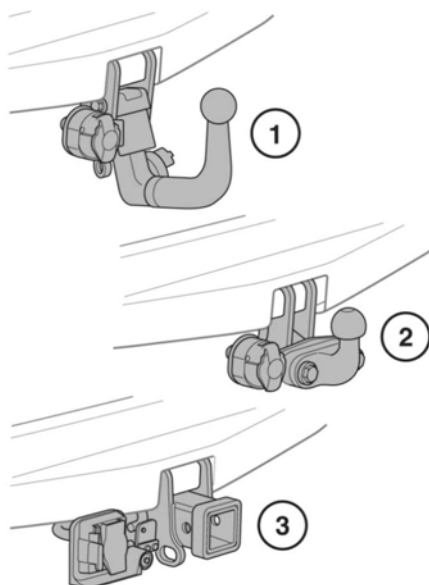

E164964

Tow ball options for 7 seat vehicles with a spare wheel:

1. Detachable tow ball.
2. Bolt on tow ball.
3. Trailer hitch tow bar. See **109, TRAILER HITCH (Australia only)**.

TRAILER STABILITY ASSIST (TSA)

When a trailer is attached, TSA will automatically detect when trailer sway is developing. It will then gradually reduce the vehicle's speed, by cutting engine power and applying the brakes to help regain control.



TSA will not operate in the event of the trailer jack-knifing.

 The ability of TSA may be reduced when travelling on slippery surfaces.

Note: TSA will not operate when Dynamic Stability Control (DSC) is switched off.

HITCH GUIDANCE

Hitch guidance is a user selectable Touch screen feature that can aid the process of guiding the vehicle to a trailer's tow hitch. Use Hitch guidance while reversing the vehicle to a trailer hitch.

Proceed, as follows:

1. Select reverse gear. Dependent on the vehicle's specification, the Touch screen will automatically display selectable icons or a menu list.
2. Touch the Hitch guidance menu or the icon, on the Touch screen, to enable the guidance lines to be displayed.
3. Reverse the vehicle towards the trailer.
4. As the vehicle closes to within 600 mm of the trailer's tow hitch, an automated zoom feature is operated to enlarge the view.
5. Continue the manoeuvre carefully until the vehicle and trailer are as close as required.

TOW ASSIST

Note: Tow assist requires a connected trailer to be fitted with a tracking target sticker, which **must** be attached according to specific instructions. Ask a Retailer/ Authorised Repairer for details.



E134952

Note: This feature may not operate with all trailer designs.

Tow assist aids trailer reversing, by displaying guidance lines on the Touch screen.

Tow assist becomes active when a trailer/ caravan is attached to the vehicle and the trailer's electrical plug is attached to the vehicle's socket.

Note: The driver's door must be opened and closed after the trailer/caravan is connected to the electrical socket, before the system will detect the connection.

The screen will display a choice for connection. Select **YES** to move to the setup screen. Select **NO** to return to the previous screen.

Note: If the connection is not detected, setup can be manually prompted by touching the Tow assist soft key on the **Camera** menu. See **143, SURROUND CAMERA SYSTEM**.

On first use, the setup screens take the user through a series of configuration options for the connected trailer. Information such as trailer hitch length, number of axles and camera preference, is required to finalise setup. Once completed, the details are stored for future use.

When a new or existing trailer configuration is selected, Tow assist automatically displays on the Touch screen when Reverse (**R**) gear is selected. Coloured lines are displayed to indicate the predicted path of both the trailer and the vehicle.

FITTING THE DETACHABLE TOW BALL

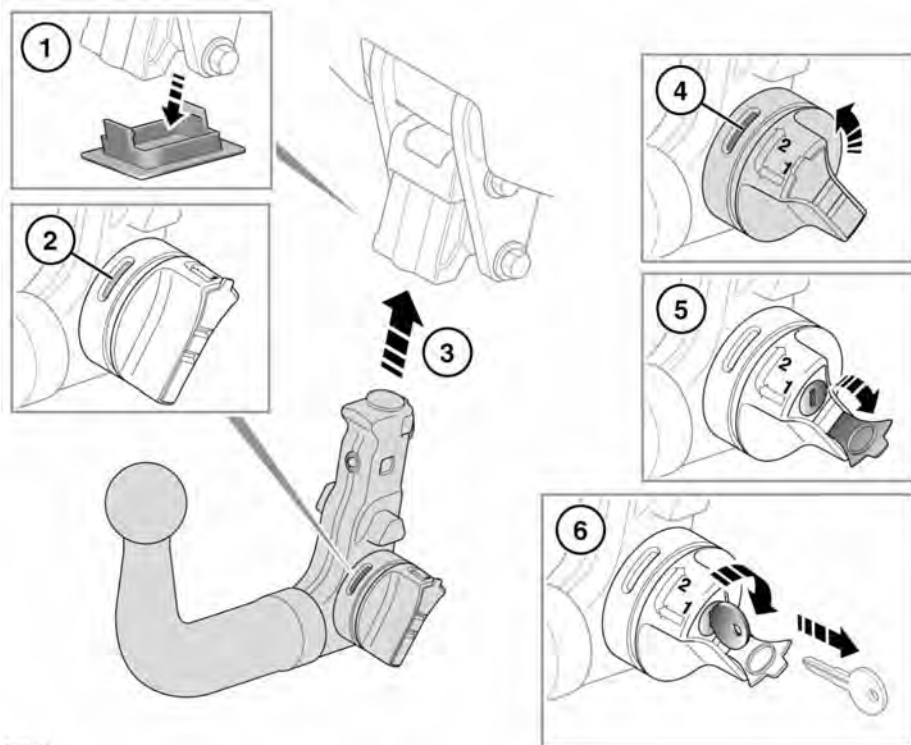

E100119

1. Remove the protective cover from the vehicle mounting and stow it in the tow ball stowage area.
2. The tow ball can only be installed when the locking lever is in the unlocked position (red showing).
3. Insert the tow ball into the mounting and push firmly upwards until the tow ball locks into position.
4. Turn the locking lever towards you until green is showing.
5. Remove the protective cover from the key slot.
6. Insert the key and turn it clockwise to lock the tow ball, then remove the key and refit the protective cover. Store the key in a safe place.



Do not exceed the maximum nose weight for the detachable tow ball. See 315, WEIGHTS.

When the detachable tow ball is not required for immediate use, it should be removed and stowed in the appropriate place.

REMOVING THE DETACHABLE TOW BALL

1. Insert the key and turn it counter-clockwise to unlock.
2. Remove the key, then supporting the tow ball, press and turn the locking lever away from you to release.
3. Remove the tow ball and stow it in the loadspace stowage area or in the bag provided.

POWERED TOW BALL

Before activating the powered tow ball, make sure that:

- Any trailer is unhitched.
- Any trailer electrical connections are disconnected.
- The vehicle is stationary with the Electric Parking Brake (EPB) applied.
- The tailgate is open.
- The gearbox is in Park (P) or Neutral (N).

If not carried out, any of the above conditions will stop the tow bar from operating. Also a short warning tone will sound if the tow bar button is pressed.

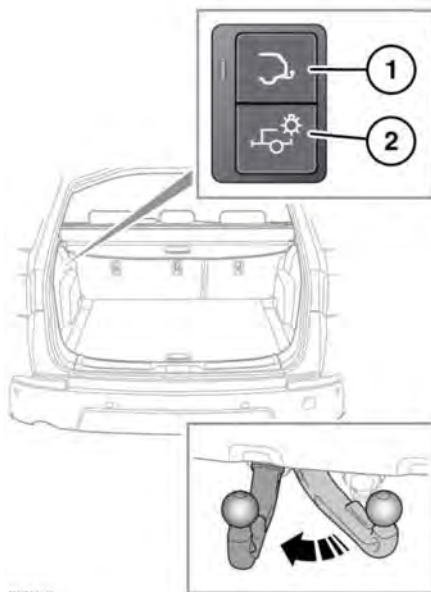

1. Press the powered tow ball button to deploy/stow.



The powered tow ball is stowed underneath the middle of the rear bumper. Make sure that no obstructions are in close proximity during operation.

- The button's LED indicator lamp will flash slowly while the powered tow bar is being deployed or stowed, an audible tone will also sound.
- Once deployed, the LED indicator lamp will stop flashing and then illuminate constantly.
- Once stowed, the LED indicator lamp will stop flashing, illuminate for 2 seconds and then extinguish.

- To stop movement of the powered tow ball at any time, press the powered tow ball button. Press the button again to reset the tow ball.
- If an obstruction occurs during the operation of the powered tow ball, the tow ball movement will stop. The LED indicator lamp will flash faster, accompanied by a 2 second warning tone. When the obstruction has been cleared, press the tow ball button to reset the tow ball.
- Do not tow when the powered tow ball is not fully deployed. If this does occur, a warning tone will sound for 10 seconds.
- If the tow ball fails to stow in extreme low temperatures, press and hold the powered tow ball button for 10 seconds to initiate the stow operation.
- In the event of an unexpected operation, press the tow ball button to reset the tow ball. During the reset operation, the powered tow ball will fully stow and then fully deploy.



Make sure the powered tow ball is fully deployed before connecting a trailer/caravan.

2. Trailer lamp test button: Press to start a 3 minute sequence for a vehicle and trailer light test.
 - For the test to operate, the vehicle's lights should be switched off, the Electric Parking Brake (EPB) should be engaged and the ignition should be switched off.

- The vehicle's lights and the trailer's lights will operate at the same time so that a visual check can be made of all the lights.
- The 3 minute sequence can be stopped at any time by any the following actions; pressing the trailer lamp test button again, by switching on the vehicle's lights or switching the ignition on.

TRAILER HITCH (Australia only)

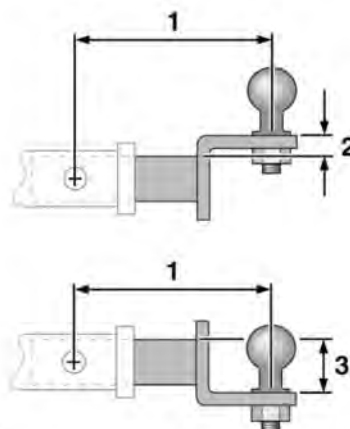

E158673



Never leave the trailer hitch loose in the vehicle. It could become a projectile in the event of an accident, or during heavy braking.

Consult a Retailer/Authorised Repairer for the latest information.

5 seat vehicles and 7 seat vehicles without a spare wheel

When selecting a trailer hitch, the following dimensions must be adhered to:

1. The maximum recommended length is 204 mm.

2. To achieve the maximum ball height, a rise of 75 mm is recommended.
3. To achieve the maximum ball height, a drop of 12.5 mm is recommended.

7 seat vehicles with a spare wheel

When selecting a trailer hitch, the following dimensions must be adhered to:

1. The maximum recommended length is 154 mm.
2. To achieve the maximum ball height, a rise of 50 mm is recommended.
3. To achieve the maximum ball height, a drop of 37.5 mm is recommended.

Note: *These dimensions have been calculated with a ball centre to the trailer hitch plate height of 50 mm. If a different ball size is used, then the dimensions need to be adjusted accordingly.*

TRAILER ELECTRICAL CONNECTION



Connect only approved electrical circuits, which are in good condition, to the vehicle's electrical tow bar socket. Failure to do so may result in damage, or affect the correct operation of the vehicle's electrical systems.

When a trailer's electrical connection is made and the vehicle's direction indicators are used, the trailer's warning indicator will flash in time with the direction indicators. See **64, TRAILER DIRECTION INDICATORS (GREEN)**.

If when a direction indicator is used the symbol does not flash, the trailer's connection should be checked and appropriate action taken to make sure the trailer's direction indicators are functioning.

The information, in the following table, will help to confirm if a trailer or a lighting board with LED lamps, will be compatible for use with this vehicle. If these conditions are not met, the vehicle will not detect the electrical connection of a trailer or a lighting board with LED lamps.

Function	Minimum load: amps (Watt)	Maximum load: amps (Watt)
Brake lamps	1.75 (21)	5 (60)
Direction indicators*	1.75 (21)	5 (60)*
Side markers/Tail lamps**	-	10 (120)**
Reverse lamps	-	5 (60)
Fog lamp	-	5 (60)
Permanent battery feed	-	15 (180)
Ignition feed	-	15 (180)

* For each side.

** Total for both sides.

ESSENTIAL TOWING CHECKS

 **Do not exceed the Gross Vehicle Weight (GVW), maximum rear axle weight, maximum trailer weight, or nose weight. Exceeding any of these limits could cause instability and a loss of control.**

 **Do not loop the breakaway cable or safety chain over the tow ball, as it may slide off.**

- To maintain vehicle stability, the trailer's nose load should be set at approximately 7% of the caravan/trailer's gross weight (and a minimum of 4%).
- When towing a trailer with more than one axle, the trailer should be loaded to achieve even weight distribution between axles.
- When calculating the laden weight of the trailer, remember to include the weight of the trailer, plus the weight of the load.
- If the load can be divided between the vehicle and trailer, loading more weight into the vehicle will generally improve stability. Do not exceed the vehicle's weight limits.
- Increase the rear tyre pressures on the towing vehicle to those for maximum vehicle loading conditions.
- Make sure that a suitable breakaway cable, safety chain, or secondary coupling is used. Refer to the trailer manufacturer's instructions for guidance.

- Always connect the breakaway cable or safety chain to the provided connection point. Do not loop it over the tow ball.
- Make sure that the tow ball is secure.
- Check the operation of all the lamps on the trailer.

TOWING A TRAILER

 **Never exceed the maximum weights for either the vehicle, or the trailer. Doing so can cause accelerated wear and damage to the vehicle. It can also adversely affect vehicle stability and braking, which in turn can lead to a loss of control and an increased braking distance, resulting in a rollover or crash.**

 **Only fit towing accessories approved by the vehicle manufacturer. These have been designed to help make sure that the handling and stability of the vehicle is not affected, if used correctly, and according to the manufacturer's instructions.**

 **Never use towing eyes or lashing points to tow a trailer. They have not been designed for this purpose and doing so may cause them to fail, resulting in injury or death.**

Note: *A reduction in the performance of the Air conditioning system is a normal function under high load towing conditions.*

Note: Engine power output always reduces with increased altitude. At 1 000 metres above sea level and for every additional 1 000 metres, deduct 10% from the Gross Train Weight (GTW). See **104, TOWING WEIGHTS**.

The Touch screen can display a rear view to assist with the reversing of the vehicle with a trailer attached. See **143, SURROUND CAMERA SYSTEM** and also **106, TOW ASSIST**.

TOW BALL MOUNTED ACCESSORIES

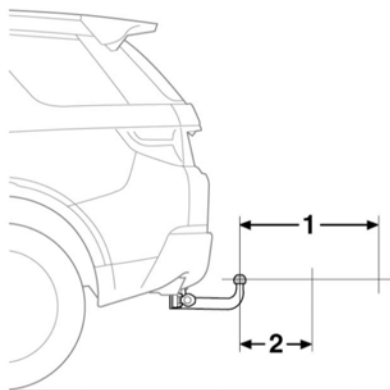

E166369



Before fitting a tow ball mounted accessory, make sure that it has been approved for use on this vehicle.

The use of unsuitable equipment can result in severe damage to the towing bracket.

Before fitting an accessory to the tow ball, observe the following guidelines:

1. The attached accessory must not protrude more than 700 mm from the tow ball.
2. The centre of gravity of the tow ball mounted equipment and the load combined, should not exceed a distance of 390 mm from the ball. The maximum weight at this distance must not exceed 82.4 kg.

Note: The forces exerted by the trailer nose weight and the tow ball mounted accessories are different in nature, hence a separate limit applies to both.

Note: Only use an approved bicycle rack, catering for a maximum of 4 bicycles.

TOW BAR DIMENSIONS AND MOUNTING POINTS

5 seat vehicles and 7 seat vehicles without a spare wheel

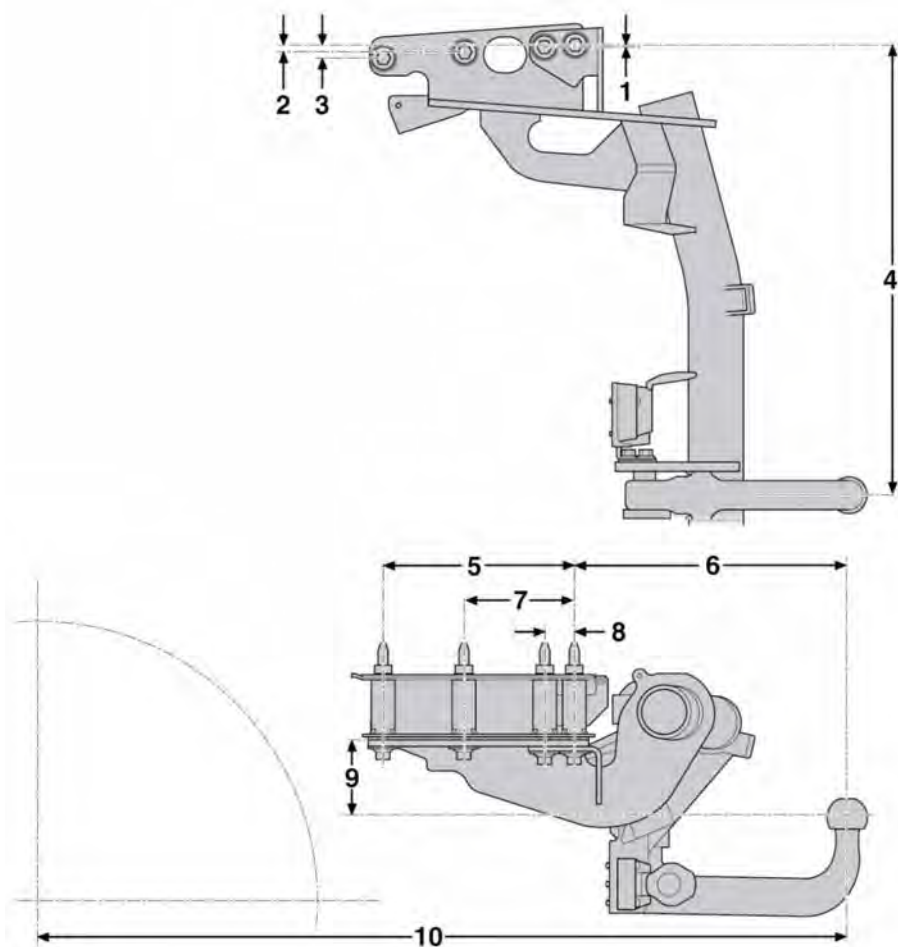

E104665

Ref.	Dimension	(mm)
1	Fixing points	3
2	Fixing points	10
3	Fixing points	17

Ref.	Dimension	(mm)
4	Fixing point to the centre of the tow ball	573
5	Fixing points	245
6	Centre of tow ball to fixing point	348
7	Fixing points	142
8	Fixing points	40
9	Centre of tow ball to tow bar attachment	101
10	Wheel centre to the centre of the tow ball	1 029

Note: Dimensions refer to towing equipment officially released by the vehicle manufacturer.

7 seat vehicles with a spare wheel

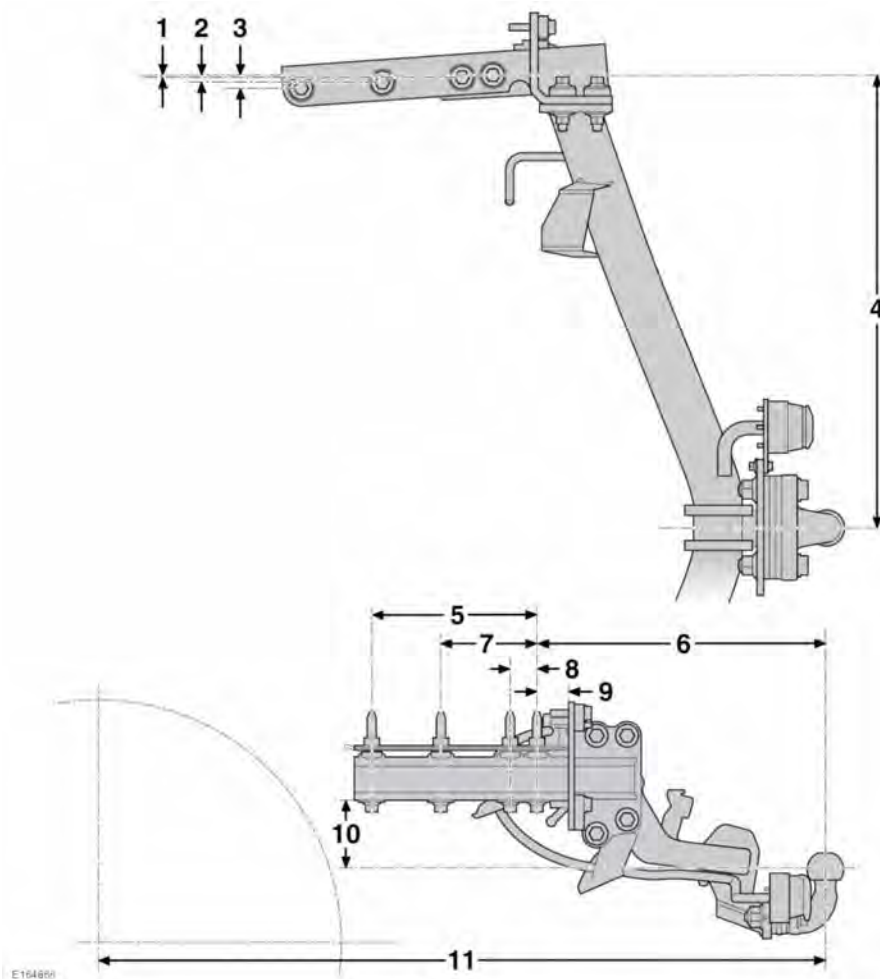

Ref.	Dimension	(mm)
1	Fixing points	3
2	Fixing points	10
3	Fixing points	17
4	Fixing point to the centre of the tow ball	573

Ref.	Dimension	(mm)
5	Fixing points	244
6	Centre of tow ball to fixing point	423
7	Fixing points	142
8	Fixing points	40
9	Fixing points	47
10	Centre of tow ball to tow bar attachment	101
11	Wheel centre to the centre of the tow ball	1 104

Note: Dimensions refer to towing equipment officially released by the vehicle manufacturer.