

CHILD SAFETY LOCKS

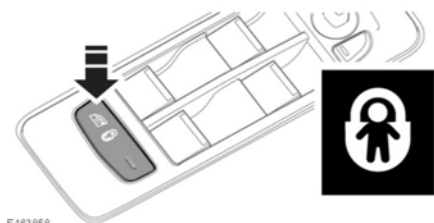

If children are to be carried in the rear seat positions, it is recommended that the rear door interior handles are disabled.

Press the switch to activate the child door locks and inhibit the rear windows. The LED indicator will illuminate when active and a message will display in the Message centre.

To switch off, press the switch again. The LED will extinguish and a message will display in the Message centre.

CHILD SEATS

⚠ For optimum safety, children should travel in the rear of the vehicle at all times; front passenger seat travel is not recommended. However, if it is essential that a child travels in the front (not permitted in Australia), set the vehicle's seat fully rearward and seat the child in an approved forward-facing child seat. Do not use a rearward-facing child seat - an inflating airbag could impact with the seat and cause serious injury.



Do not use a forward-facing child seat until the child using it is above the minimum weight of 9 kg and able to sit up unaided. Up to the age of two, a child's spine and neck are not sufficiently developed to avoid injury in a frontal impact.



Do not allow a baby or infant to be held or carried on the lap. The force of a crash can increase effective body weight by as much as thirty times, making it impossible to hold onto the child. At all times, children should be restrained in age and size appropriate child seats to reduce the risk of death or serious injury in a crash.



Children could be endangered in a crash if their child restraints are not properly secured in the vehicle. Always follow the instructions that accompany the child seat carefully.



Children typically require the use of a booster seat appropriate to their age and size, thereby enabling the seat belts to be properly fitted, reducing the risk of injury in a crash. Children could be endangered in a crash if their child restraints are not properly secured in the vehicle.



Do not use a child seat that hooks over the seatback. This type of seat cannot be satisfactorily secured and is unlikely to be safe for your child.

Child safety

The seat belts fitted to your vehicle are designed for adults and larger children. For their safety, it is very important for all infants and children under 12 years of age to be restrained in a suitable child safety seat, appropriate to their age and size.

If it is essential that a child travels in the front passenger seat (and national or state legislation permits this), Jaguar Land Rover Limited recommends that the following preparations are made before fitting the child restraint:

- Disable the front passenger airbag. See **52, DISABLING THE PASSENGER AIRBAG**.
- Adjust the front passenger seat fully rearwards.
- Adjust the lumbar support to its minimum support position.
- Adjust the seat cushion to its highest position. If cushion front tilt adjustment is possible, adjust it to its lowest position.
- Adjust the seatback to an upright position to support the child restraint.

 **Extreme hazard! Do not use a rearward-facing child restraint on a seat protected by an airbag in front of it!**

 **NEVER use a rearward-facing child restraint on a seat protected by an ACTIVE AIRBAG in front of it, DEATH or SERIOUS INJURY to the CHILD can occur.**



E132397

This symbol, affixed to the front door B-post on the passenger side, warns against the use of a rearward-facing child seat in the front passenger seat, when a front passenger airbag is fitted and operational.



E145193

This symbol, affixed to the passenger side sun-visor, warns against the use of a rearward-facing child seat in the front passenger seat, when a front passenger airbag is fitted and operational.

CHILD SEAT POSITIONING

 Crash statistics show that children are safest when properly restrained in a child or infant restraint system that is secured in a rear seating position.

 Seat belts (or suitable child restraints) should be used by all vehicle occupants, for every trip, no matter how short. Failure to do so will greatly increase the risk of death or serious injury in the event of an accident.

Information given within the table is correct at the time of going to press. However, availability of child restraints may change. Please consult your Retailer/ Authorised Repairer for the latest recommendation.

Note: The information contained in the following tables may not be applicable to all countries. If you are in any doubt regarding the type and fitment of child seats, seek advice from a Retailer/ Authorised Repairer.

Note: Ages given are approximate. In case of doubt, the child's weight, not age, should be used when considering an appropriate child seat.

Note: The legislation which governs how and where children should be carried when travelling in a vehicle, is subject to change. It is the responsibility of the driver to comply with all regulations in force.

Seating positions	Mass group				
	0 = Up to 10 kg 0-9 months	0+ = Up to 13 kg 0-18 months	I = 9-18 kg 9 months to 4 years	II = 15-25 kg 4-9 years	III = 22-36 kg 8-12 years
Front passenger*	U	U	U	U	U
Second row seats**	U	U	U	U	U
Third row seats***	X	X	X	UF	UF

U = Suitable for universal category restraints, approved for this mass group.

X = Not suitable for the use of child restraints of this mass group.

UF = Suitable for universal forward-facing child restraints of this mass group.

* Always make sure the passenger airbag has been disabled before using a child restraint in this seating position. See **52, DISABLING THE PASSENGER AIRBAG**. The front passenger seat should be positioned fully rearward, the seat cushion to its highest position and the seatback adjusted to an upright position to support the child restraint.

** For vehicles fitted with sliding second row seats:

- Adjust the seatback to the upright position.
- Adjust the seat to the rear most position, unless the third row seats are occupied.

*** Adjust the second row seatback to the upright position and move the seat forward, to give sufficient clearance to allow fitment of the third row child restraint.

ISOFIX Child Seat Positioning

Mass group as shown on child restraint	Size class	Fixtures	Second row outboard*	Recommended child restraint system
Carry-cot	F	ISO/L1	X	-
	G	ISO/L2	X	-
0 Up to 10 kg (0 - 9 months)	E	ISO/R1	IL	Britax/Römer Baby-Safe Plus with Baby-Safe ISOFIX Base
0+ Up to 13 kg (0 - 18 months)	E	ISO/R1	IL	
	D	ISO/R2	IL	-
	C	ISO/R3	IL	-
I 9 to 18 kg (9 months - 4 years)	D	ISO/R2	IL	-
	C	ISO/R3	IL	-
	B	ISO/F2	IUF	Britax/Römer Duo Plus
	B1	ISO/F2X	IUF	
	A	ISO/F3	IUF	
II/III 15 to 36 kg (4 - 9 years)	-	-	-	-

IUF = Suitable for ISOFIX forward child restraint systems of universal category, approved for use in the mass group.

IL = These ISOFIX child restraint systems are of the specific vehicle, restricted or semi-universal categories.

X = Not suitable for ISOFIX child restraint fitment in this mass group.

*For vehicles fitted with sliding second row seats:

- Adjust the seatback to the upright position.
- Adjust the seat to the rear most position, unless the third row seats are occupied.

Note: ISOFIX anchorages are provided for second row outer seating positions. ISOFIX child restraints should be securely attached, following the manufacturer's instructions at these locations only.

RECOMMENDED CHILD SEATS

Child size/age	Recommended seat
Groups 0 and 0+	Britax/Römer Baby-Safe plus with Baby-Safe ISOFIX Base
Group I	Britax/Römer Duo Plus
Group II and III	Britax/Römer Kid Plus

CHILD RESTRAINT CHECK LIST

Every time a child travels in the vehicle, observe the following:

- Use appropriate child restraints.
- Carefully follow the instructions provided by the manufacturer of the restraint system.
- Adjust the harnesses for every child on every journey.
- Make sure that all slack is removed from the adult seat belt.
- Always attach the top tether when installing an ISOFIX seat.
- Always check the security of the child restraint.
- Do not dress a child in bulky clothing, or place any objects/padding between the child and the restraint.
- Regularly check the fit and condition of child restraints. If the fit is poor, or wear/damage is visible, replace the restraint immediately.
- Set a good example - always wear your seat belt.
- For child seats fitted with a support leg, adjust the leg so that it rests firmly on the floor.
- For some child seats, it may be necessary to remove the head restraint to make sure of a stable fit. Always refit a removed head restraint after the child seat is removed.



Child restraint anchorages are designed to withstand only those loads imposed by correctly fitted child restraints. Under no circumstances are they to be used for adult seat belts, harnesses, or for attaching other items or equipment to the vehicle.

BOOSTER SEATS

In a situation where a child is too large to fit into a child safety seat, but is still too small to safely fit the 3-point belt, a booster seat is recommended for maximum safety. Follow the manufacturer's instructions for fitting and use, then adjust the seat belt to suit.

INSTALLING ISOFIX CHILD RESTRAINTS



Do not attempt to fit ISOFIX restraints to the centre rear seating position. The anchor bars are not designed to hold an ISOFIX restraint in this position.



If the restraint is not correctly anchored, there is a significant risk of injury to the child in the event of a collision or emergency braking.



WARNING: child restraint anchorages are designed to withstand only those loads imposed by correctly fitted child restraints. Under no circumstances are they to be used for adult seat belts, harnesses, or for attaching other items or equipment to the vehicle.

ISOFIX anchorages are provided at the outer seat positions on the second row seats.



To install an ISOFIX child seat:





1. Locate the ISOFIX anchor bars and, if fitted, remove the covers.
2. Slide the child seat into position and attach the locking mechanism to the ISOFIX anchor bars.

If an upper tether is fitted to the child seat, see **46, INSTALLING TETHER ANCHORAGE CHILD RESTRAINTS**.

Test the security of the child restraint. To do this, attempt to pull the restraint away from the vehicle's seat and twist the restraint from side to side. Even if the restraint appears secure, you should still check the anchor points visually, to make sure they are correctly attached.

Note: Always make sure that if an upper tether is provided, it is fitted and tightened correctly.

INSTALLING TETHER ANCHORAGE CHILD RESTRAINTS

-  Always follow the child seat or restraint system manufacturer's instructions when fitting tether straps.
-  When fitting a child seat or restraint system, always pass the tether strap over the top of the seatback and beneath the head restraint.
-  If removing a head restraint in order to fit a child restraint, always secure the head restraint when storing it.
-  If a child seat or restraint system is to be fitted to the centre seating position, the centre armrest must be in the stowed position (folded into the seat).

The vehicle is equipped with tether anchorage points behind the second row seat frames. These should be used to attach straps from child seats or restraint systems.

Note: A tether anchorage is provided for the centre seat position. Do not use this anchor position with an ISOFIX child seat. Always fit the upper tether anchorage and tighten correctly.

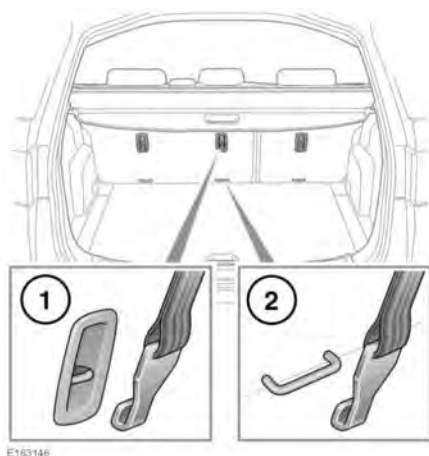

Tether strap anchor point locations:

1. Fixed rear seats.
2. Sliding rear seats.

Install the tether straps as follows:

1. Install the child restraint securely in one of the rear seating positions.
2. Pass the tether strap over the seatback, beneath the head restraint and between the seatback and the loadspace cover.
3. Attach the tether strap hook to the tether anchor point on the back of the seat. Make sure the tether strap hook is facing the correct way, as illustrated.
4. Tighten the tether strap according to the manufacturer's instructions.

Note: For 5 seat vehicles fitted with sliding seats, the loadspace floor should be lifted and moved rearwards. This is to allow access to the tether anchor points. The loadspace floor should be replaced after attaching the tether straps.

Australian vehicles only

For 5 and 7 seat vehicles fitted with sliding rear seats, the seats should be adjusted to the foremost position prior to attaching the tether straps. The seats should then be returned to the rearmost position to aid fitment of the child seat.