

## MANUAL SEATS

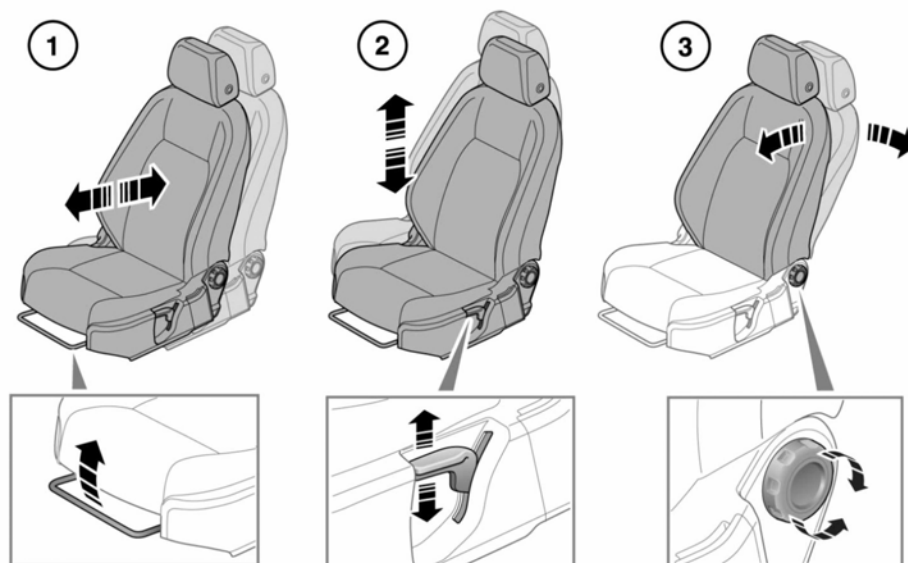

E162462

1. Forward and rearward adjustment.
2. Height adjustment.
3. Seatback angle adjustment.

For information on how to adjust the front head restraint, see **33, FRONT HEAD RESTRAINTS**.



**Do not adjust the seat while the vehicle is moving; doing so could cause a loss of vehicle control and personal injury.**

## ELECTRIC SEATS

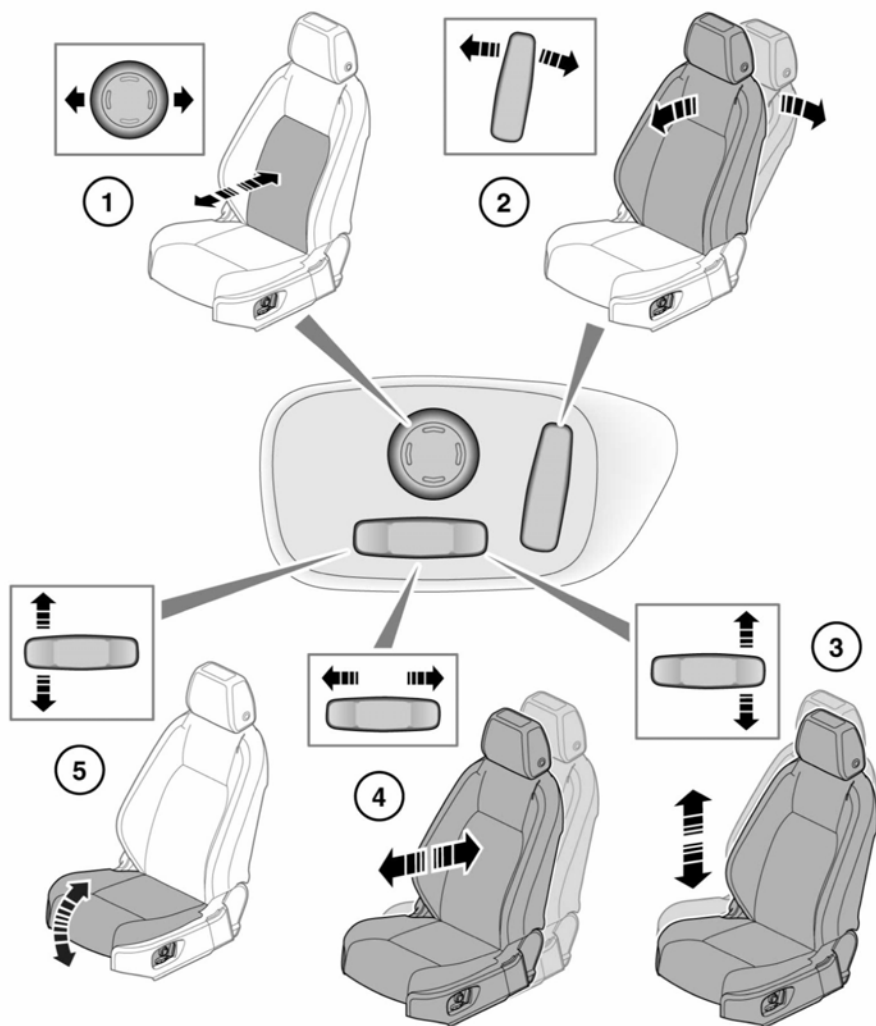

E160770

1. Lumbar support adjustment.
2. Seatback angle adjustment.
3. Height adjustment.
4. Forward and rearward adjustment.
5. Cushion angle adjustment.

To adjust the seats, the Smart key must be inside the vehicle.

For information on how to adjust the front head restraints, see **33, FRONT HEAD RESTRAINTS**.



**Do not adjust the seat while the vehicle is moving; doing so could cause a loss of vehicle control and personal injury.**

## RESTRICTED FRONT SEAT TRAVEL



If seat movement stops unexpectedly during adjustment, check for and remove any obstructions.

Once any obstructions have been removed, the seat adjustment mechanism can be reset as follows:

Operate the button again to continue the stalled adjustment. When seat movement resumes, hold the button until the end of travel in that direction has been reached. Seat adjustment can now be carried out as normal.

**Note:** If no obstructions can be seen, but normal adjustment cannot be carried out without stalling, contact your Retailer/ Authorised Repairer.

## SITTING IN THE CORRECT POSITION



**The driver and front seat passenger must not ride with the seat fully reclined.**



**Do not adjust the seat while the vehicle is moving.**

The seat, head restraint, seat belt and airbags, all contribute to the protection of the user. Correct use of these components will give you greater protection. Therefore, you should always observe the following points:



1. Sit in an upright position, with the base of your spine as far back as possible. To achieve optimum benefit of the seat belt in the event of an accident, do not recline the seat excessively.
2. Do not move the driver's seat too close to the steering wheel. Ideally, a minimum distance of 254 mm is recommended between the breastbone and the steering wheel airbag cover. Hold the steering wheel in the correct position, with your arms slightly bent.
3. Adjust the head restraint so that the top of the head restraint is above the centre line of the head.
4. Position the seat belt so that it is midway between your neck and your shoulder. Fit the strap tightly across your hips; not across your stomach.

Make sure that your driving position is comfortable and enables you to maintain full control of the vehicle.

### DRIVING POSITION MEMORY

The front seat and exterior mirror positions can be saved to the vehicle's memory.

Once you have adjusted the power-operated driver's seat and the exterior mirrors, the vehicle can memorise the settings for future use. See **75, EXTERIOR MIRRORS**.

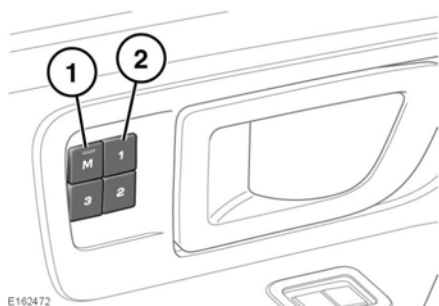

1. On the driver's door, press the memory store button (**M**) to activate the memory function. The switch indicator will illuminate.
2. Press one of the preset buttons within 5 seconds to memorise the current settings. **Memory (1, 2 or 3) Settings Saved** will be displayed in the Message centre, accompanied by an audible chime to confirm the settings have been saved to the memory.

**Note:** A seat position will be saved to the memory, only during the 5 second active period.

**Note:** Any existing settings will be over-written when a new position is saved to the memory.

To recall a saved position, press the relevant preset button (**1**, **2** or **3**).

**Memory (1, 2 or 3) Recalled** will be displayed in the Message centre.

### EASY ENTRY/EXIT

When Easy entry/exit is enabled, the driver's seat will automatically lower when the ignition is switched off and the door is opened. Upon returning to the vehicle, when the driver's door is closed and the ignition is switched on, the seat will return to its previously set position.

This feature can be enabled/disabled via the Instrument panel menu. See **56, INSTRUMENT PANEL MENU**.