

Exiting the vehicle

MISLOCK

When locking the vehicle with the Smart key, a mislock can occur if:

- One or more of the doors, the bonnet or the luggage area is not fully closed.
- The ignition is ON.
- A Smart key is left inside the vehicle.

If any of the above are present, the vehicle will NOT lock and there will be an audible mislock error warning. The hazard warning lamps will NOT flash and the door mirrors (if enabled) will NOT fold in. Check that all of the doors, the bonnet and the luggage area are closed properly. Make sure the ignition is switched OFF and lock the vehicle again. If the mislock persists, consult your Retailer/Authorised Repairer.

DEACTIVATING THE ALARM WHEN TRIGGERED

If the alarm has been triggered, it can be deactivated by any one of the following methods:

1. Pressing the unlock button on the Smart key.
2. Opening a door using Keyless entry.
3. Pressing the **START/STOP** button with a valid Smart key positioned correctly. See **121, KEYLESS START BACKUP**.

The cause of the last alarm activation can be displayed in the Message centre. See **53, INSTRUMENT PANEL MENU**.

EMERGENCY LOCKING

In the event of the battery discharging, or a fault with the locking system, each of the doors must be locked manually.

The emergency key blade is required for this procedure. See **5, UNLOCKING THE VEHICLE**.

Note: Do not leave the emergency key blade in the vehicle at any point during the emergency locking procedure.

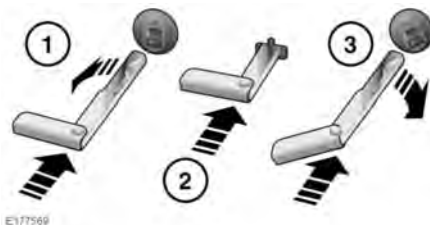

1. Open a door and locate the emergency lock access cover on the edge of the door. The cover has an embossed lock icon. Insert the emergency key blade into the cover slot, rotate the cover counter-clockwise to first release it, then pull to remove it from the door. Keep the lock access cover safe.
2. Insert the emergency key blade firmly into the emergency lock. A firm push activates the door locking mechanism. Remove the emergency key blade.
3. Refit the emergency lock access cover and rotate it clockwise to secure it firmly.
4. Close the door and check that it is locked.

Repeat the procedure for all other unlocked doors.