

## OPENING AND CLOSING THE POWERED TAILGATE



Before operating the tailgate, make sure that anyone in the vicinity does not have any part of their body in a position where it could be trapped. Note that the 'soft close' action does not incorporate object detection. Death or serious injury could occur, even with an object detection system.

While the tailgate is open, the locking latch is exposed. Do not attempt to manually close the latch, as it may also automatically 'soft close' and trap items or body parts.



Make sure there is sufficient space above and at the rear of the vehicle, before operating the tailgate. Insufficient opening space may result in damage to the vehicle.



Do not operate the tailgate if a cycle rack is fitted to the tailgate. Remove any cycles and/or racks before operating the tailgate.

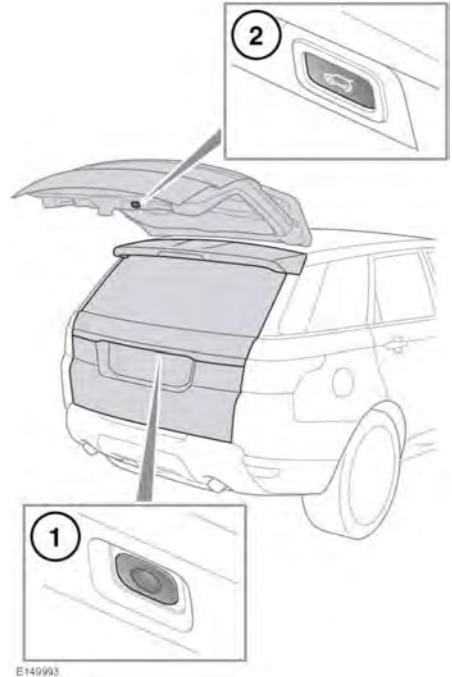

1. Tailgate open/close: Press to open, stop, reverse direction or close the tailgate.
2. Tailgate close: Press to close/stop the tailgate.

**Note:** The tailgate external release operates when all of the doors are unlocked and the gear selector is in the Park (**P**) position. When the gear selector is in the Neutral (**N**) position, the external release operates only if all of the doors are unlocked, and the ignition is in Convenience mode or switched off. It will not operate if the gear selector is in any other position.

The tailgate can also be opened or closed using the following methods:

- The interior tailgate release switch.