





HEAD RESTRAINTS

-  Adjust so that the top of the head restraint is above the centre line of the head. Incorrect adjustment increases the risk of death or serious injury in the event of a collision.
-  It is possible to swivel the head restraint forwards or backwards. For greater protection in the event of a collision, the head restraint should be adjusted so that it is as close to the back of the head as possible.
-  Do not drive or carry passengers with the head restraints removed from occupied seats. The absence of a correctly adjusted head restraint increases the risk of neck injury in the event of a collision.
-  Never adjust the head restraints while the vehicle is in motion.
-  Always store a removed head restraint securely.

ELECTRIC HEAD RESTRAINTS

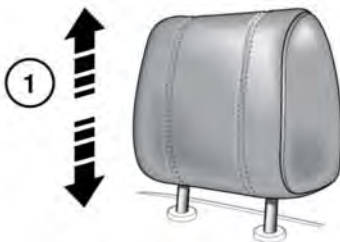

E150730

1. To adjust the height of the head restraint. See **21, ELECTRIC SEATS**.

Note: It is not possible to remove electric head restraints.

MANUAL HEAD RESTRAINTS

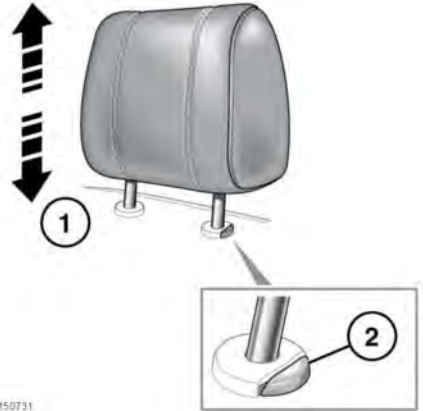

E150731

1. To raise, pull the head restraint upwards. It will click and lock into position.
2. To lower, press the locking button and push down on the restraint.

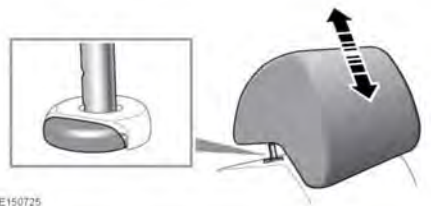

E150725

1. To raise, pull the head restraint upwards. It will click and lock into position.
2. To lower, press the locking button and push down on the restraint.