

## HEADLAMP BULB REPLACEMENT

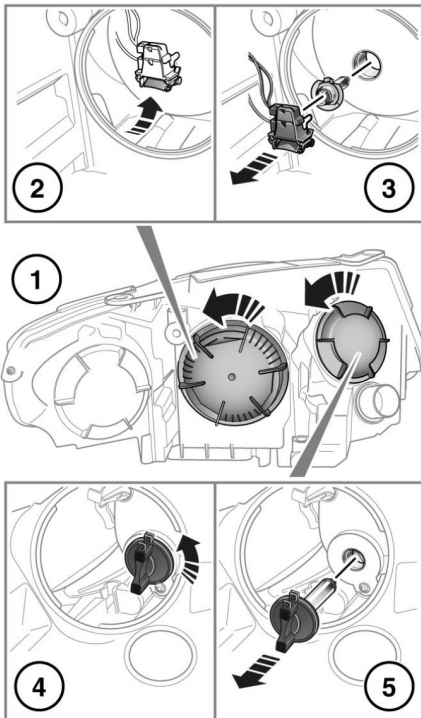

E165252

1. At the back of the headlamp unit, rotate the appropriate bulb cover counter-clockwise and then lightly pull to remove it.
2. Remove the low beam bulb holder from the headlamp.
3. Unclip the low beam bulb and remove it from the bulb holder.
4. Rotate the DRL/high beam bulb unit counter-clockwise.
5. Remove the DRL/high beam bulb unit from the headlamp housing.

Reverse the removal procedure to install a bulb holder/bulb unit.

**Note:** Note the orientation of any removed components to aid refitting.

## DIRECTION INDICATOR BULB REPLACEMENT

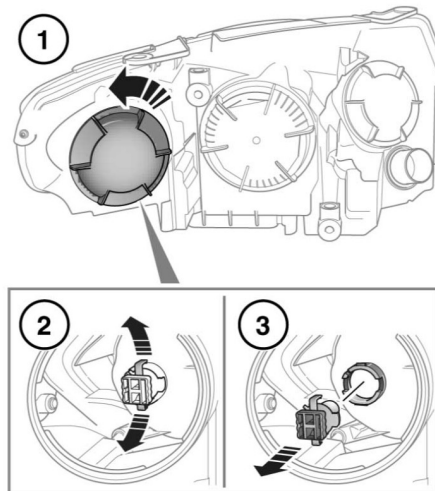

E165254

To gain more room for accessibility, follow the process for removing the headlamp unit. See **192, HEADLAMP REMOVAL**.

1. At the back of the headlamp unit, rotate the appropriate bulb cover counter-clockwise and then lightly pull to remove it.
2. Release the sides of the bulb holder.
3. Pull the holder to remove it from the headlamp and access the indicator bulb.

Reverse the removal procedure to install a bulb holder/bulb unit.

**Note:** For Xenon headlamp units, the bulb cover for the direction indicator is located on the inboard side.

**Note:** Note the orientation of any removed components to aid refitting.