

## AUDIO STEERING WHEEL CONTROLS

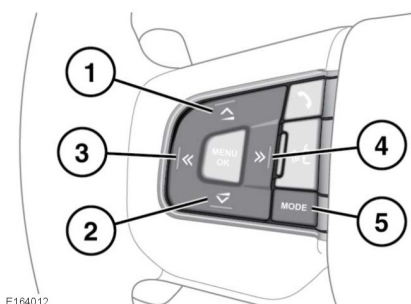

1. Press to increase the volume for any source.
2. Press to decrease the volume for any source.
3. Skip/scan backwards: Press to skip back to the beginning of the current track being played, or press and hold to scan backwards through the current track being played. Playback resumes when the button is released.
4. Skip/scan forwards: Press to skip forwards to the start of the next track, or press and hold to scan forwards through the current track being played. Playback resumes when the button is released.
5. **MODE**: Press repeatedly to scroll through all of the available, or connected, media sources.

## AUDIO SETTINGS

To view the **Audio** settings menu, select **Audio** from the **General settings** menu.

Audio settings contains the following options:

- **Traffic Announcement**. Turn on/off.
- **Sound**: Select to view the following options:
  - **Balance/Fade**.
  - **Bass/Mid/Treble**.

- **Speed dependent volume**.
- **Radio**: These setting options are dependent on the radio source selected. See **152, AM/FM RADIO CONTROLS** or **153, DAB RADIO CONTROLS**.

To adjust the balance and fade settings, touch **Balance/Fade**.

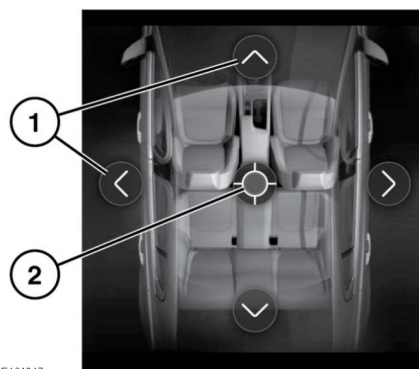

Touch the arrow soft keys (1) to move the sound focal point to the desired area of the vehicle. Alternatively, touch the sound focal point (2) and 'drag' it to the required position. To return to the default setting, touch the sound focal point (2).



1. Touch the symbol to move from the **Bass/Mid/Treble** screen to the **Balance/Fade** screen.
2. Touch the symbol to move from the **Balance/Fade** screen to the **Bass/Mid/Treble** screen.