

Exiting the vehicle

The hazard warning lamps will flash twice to confirm (with a long second flash). An audible confirmation may also be given (if enabled).

Note: When locking the vehicle via Keyless locking, if one or more of the doors, the bonnet or the tailgate is not fully closed, or the ignition is ON, the vehicle will NOT lock. There will be NO audible mislock error warning. The hazard warning lamps will NOT flash and the door mirrors (if enabled) will NOT fold in. Check that all of the doors, the bonnet and the tailgate are closed properly. Make sure the ignition is turned OFF and lock the vehicle again. If the mislock persists, consult your Dealer/Authorised Repairer.

GLOBAL CLOSING



Make sure no children, pets, or obstructions are in any open aperture before operating Global closing.

Make sure all of the doors are closed. Press and hold the Smart key lock button for 3 seconds. The vehicle will single lock and the alarm will be armed immediately. After 3 seconds, any open windows will be closed.

Keyless Global closing (if enabled) can be operated by touching the door lock sensor for 3 seconds. This will also single lock the vehicle and activate the alarm.

Note: The windows will close only while the door lock sensor is being touched. To fully secure the vehicle, continue to touch the door lock sensor until all of the windows are fully closed.

Note: Global closing can be enabled and disabled via the **Vehicle Set-up** Instrument panel menu. See **49, INSTRUMENT PANEL MENU**.

BATTERY-BACKED SOUNDER

In certain markets, a Battery-backed sounder is fitted. This device will sound if it, or the vehicle's battery is disconnected while the security system is armed.

TILT SENSOR

The tilt sensor detects any change to the vehicle's angle to the ground. When the alarm is armed and the vehicle is double locked, any change in the vehicle's angle will activate the tilt alarm.

Note: The tilt sensors can be temporarily disabled for the next time the vehicle is locked. See **49, INSTRUMENT PANEL MENU**. The sensors will be automatically enabled the next time the vehicle is double locked with the Smart key.

DOOR LOCKS AND RELEASE LEVERS



While a door is open, the locking latch is exposed. If your vehicle is fitted with the soft close feature, do not attempt to manually close the latch, as it may also automatically soft close and trap items or body parts.

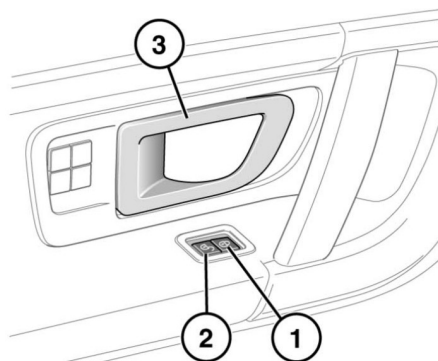

E161676