

## REMOVING THE DETACHABLE TOW BAR

Remove the Detachable tow bar as follows:

1. Insert the key and turn it counter-clockwise to unlock.
2. Remove the key, then supporting the tow bar, press and turn the locking lever away from you, to release.
3. Remove the tow bar and stow it in the dedicated stowage area under the loadspace floor. Where this is not provided, the tow bar should be stowed in the bag provided.



**Never leave the detachable tow bar loose in the vehicle. It could become a projectile in the event of heavy braking or an accident.**

## POWERED TOW BAR

Before activating the Powered tow bar, make sure that:

- Any trailer is unhitched.
- Any trailer electrical connections are disconnected.
- The vehicle is stationary.
- The tailgate is open.
- The vehicle's transmission is in Park (P) or Neutral (N).

If not carried out, any of the above conditions will stop the tow bar from operating. Also a short warning tone will sound if the tow bar button is pressed.

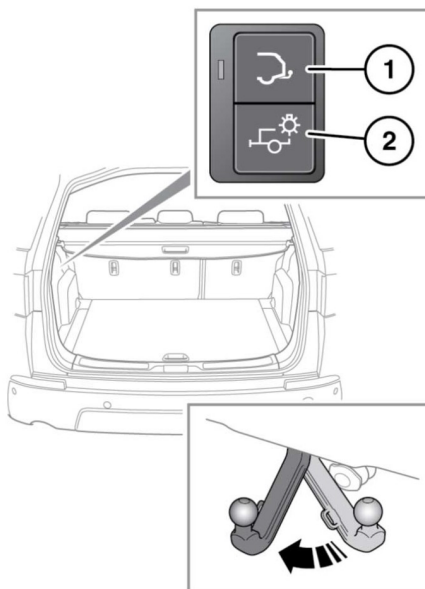

E166109

1. Powered tow bar button: Press to deploy or stow the powered tow bar.
  - The LED by the side of the button will flash slowly while the powered tow bar is being deployed or stowed, an audible tone will also sound.
  - Once deployed, the LED will stop flashing and will be solidly lit.
  - Once stowed, the LED will stop flashing and will be solidly lit for 2 seconds and will then extinguish.
  - To stop movement of the powered tow bar at any time, press the powered tow bar button. Press the button again to fully deploy or stow the tow bar.