

STORAGE COMPARTMENTS

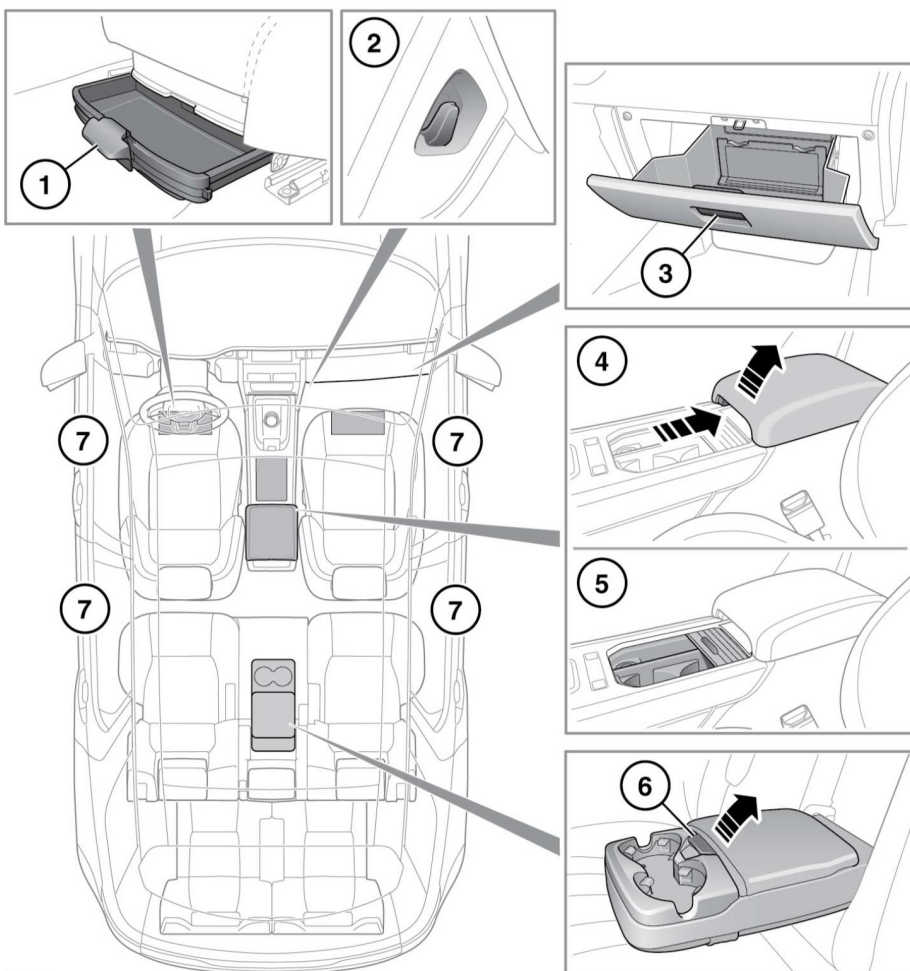

E164493

1. Under seat storage tray: To access the tray, lift the handle to release and then pull forwards. Note, there is a tray under each front seat.



Do not exceed the maximum storage weight of 1.5 kg (3 lbs).

2. Bag hook.
3. Glovebox: Pull the handle to open.
4. Armrest and cubby box: Pull the release lever and then raise the armrest to access the storage area.

Storage compartments



To avoid personal injury, keep hands and fingers clear from the front and rear edges of the armrest during the opening and closing of the cubby box.

5. Cup holders: Slide back the cover to reveal the cup holders.



Do not drink, or use the drinks holders when driving.

6. Rear armrest storage and cup holders: Press the release button to access the storage compartment.

7. Storage areas.



Make sure that any items stored in the vehicle are secure and cannot move. If the vehicle is involved in an accident, or subject to a sudden braking or direction change, loose items can cause serious injury.