

## STORAGE COMPARTMENTS

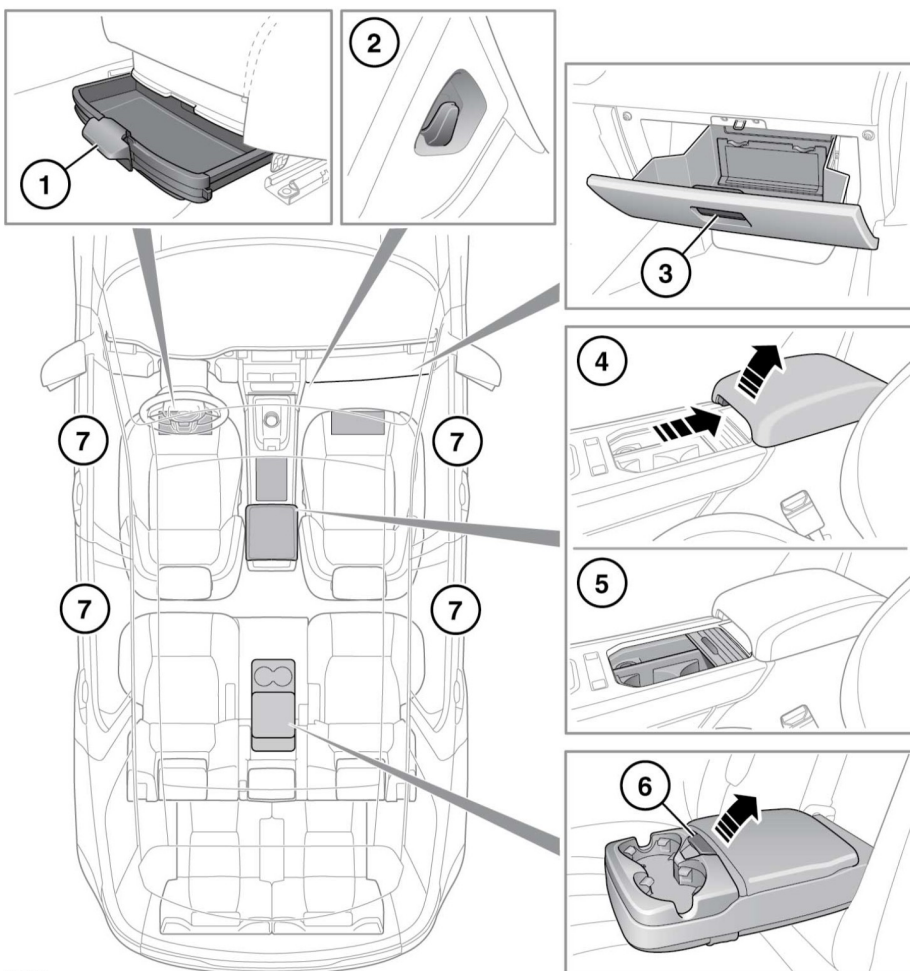

E164493

1. Under seat storage tray: To access the tray, lift the handle to release and then pull forwards. Note, there is a tray under each front seat.



Do not exceed the maximum storage weight of 1.5 kg (3 lbs).

2. Bag hook.
3. Glovebox: Pull the handle to open.
4. Armrest and cubby box: Pull the release lever and then raise the armrest to access the storage area.

## Storage compartments



**To avoid personal injury, keep hands and fingers clear from the front and rear edges of the armrest during the opening and closing of the cubby box.**

5. Cup holders: Slide back the cover to reveal the cup holders.



**Do not drink, or use the drinks holders when driving.**

6. Rear armrest storage and cup holders: Press the release button to access the storage compartment.

7. Storage areas.



**Make sure that any items stored in the vehicle are secure and cannot move. If the vehicle is involved in an accident, or subject to a sudden braking or direction change, loose items can cause serious injury.**