

# Load carrying

To allow the loadspace cover to be unrolled and retracted without fouling on the seat belt, place the seat belt into the trim clip, located at the rear of the loadspace. For more information on the third row seat belts, see **28, USING THE SEAT BELTS**.

## LUGGAGE ANCHOR POINTS

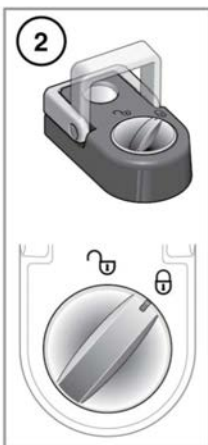

E150872



**All items carried in the loadspace should be properly secured.**

1. To assist in safely securing large items of luggage, four lashing eyes are located in the rear loadspace floor.
2. If adjustable lashing eyes are fitted, first turn the locking button counter-clockwise to unlock. Press the button and slide to the required position in the luggage rail. Release the button to latch into position. Move the lashing eye slightly, until you hear a click. The lashing eye is now secured. Turn the button clockwise to lock.

**Note:** A range of approved luggage retention accessories are available from your Dealer/Authorised Repairer.