

Seat belts

⚠ If the seat belt is twisted through 180°, the tongue will not fasten in the buckle. Remove any twists in the seat belt before continuing.

2. Connect the larger tongue into the inboard buckle. The inboard buckle is identified by a red button. Press the tongue into the buckle, until a click is heard. To release the seat belt, press the red button.

The third row seat belts can be stowed away, when not in use. With the seat belt disconnected from both buckles, insert the tongues into the slots, located at the rear of the loadspace.

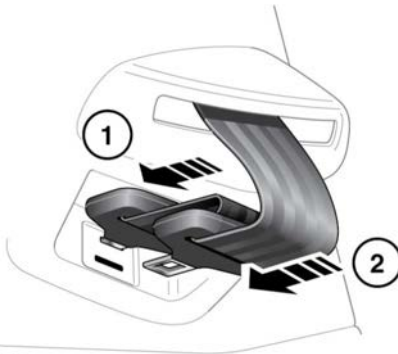

E163002

1. Small tongue.
2. Large tongue.

SEAT BELT SAFETY

- ⚠** Care should be taken to avoid contamination of the webbing with polishes, oils and chemicals, and particularly battery acid. Cleaning may safely be carried out using mild soap and water.
- ⚠** The belt should be replaced if webbing becomes frayed, contaminated or damaged.

⚠ It is essential to replace the entire assembly after it has been worn in a severe impact even if damage to the assembly is not obvious.

⚠ If any damage, wear, cuts, defects, or impaired operation are noted with the seat belts, the vehicle should be taken to a Land Rover Dealer/Authorised Repairer for immediate attention. Do not use the vehicle if the seat belts cannot be operated correctly.

⚠ Do not carry hard, fragile, or sharp items between your person and the seat belt.

⚠ Seat belts should be worn by all vehicle occupants, for every journey, no matter how short.

⚠ Never wear just the lap belt or just the shoulder belt of a lap/shoulder diagonal seat belt. Both of these actions are extremely dangerous and may increase your risk of injury.

⚠ When using seat belts to restrain items other than occupants, take care to make sure the belts are not damaged, or exposed to sharp edges.

SEAT BELT CHECKS

Note: If the vehicle is parked on an incline, the seat belt mechanism may lock. This is not a fault and the belt should be gently eased out from the upper anchorage.

The seat belts should be inspected regularly to check for fraying, cuts, wear to the webbing and the condition and security of the mechanism, buckles, adjusters and mounting points.

- With the seat belt fastened, give the webbing near the buckle a quick upward pull. The buckle must remain securely locked.