

ROOF BLIND

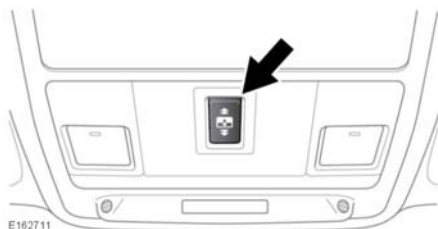

Roof blind open/close switch:

To open the blind, push from the rear of the switch and release. The blind will slide fully open.

To close the blind, push from the front of the switch to the first position and release. The blind will fully close. A further press will stop movement of the blind.

Alternatively, push from the front of the switch to the second position and hold until the blind reaches the desired position, then release.

1. Attempt to close the window, anti-trap will prevent closure and lower the window slightly.
2. Within ten seconds attempt to raise the window again, anti-trap will prevent closure and lower the window slightly.
3. Attempt to close the window for a third time, this time hold the switch in the close position. Hold until closed.

Note: If this procedure fails to remove the blockage, the window operation may need to be reset, see **216, WINDOW RESET**.

ANTI-TRAP PROTECTION



Closing a window or roof blind onto any part of the body can result in serious injury.



Before closing a window or the roof blind, make sure no occupants have any part of their body in a position where it could be trapped. Even with an anti-trap system death or serious injury could occur.

Anti-trap protection will stop window or roof blind movement if an obstruction or resistance is detected. Check the window or roof blind and its aperture and remove any obstructions (e.g. ice, etc.).

If it is still necessary to raise the window, the override procedure is as follows: