

**Note:** In an emergency - and only if the approved antifreeze is unavailable - top up the cooling system with clean water, but be aware of the resultant reduction in frost protection. Do not top up or refill with conventional antifreeze formulations. If in doubt, consult a qualified technician.

Make sure the cap is tightened fully after top up is complete, by turning the cap until the ratchet cap clicks.

## CHECKING THE BRAKE FLUID LEVEL

**⚠** Brake fluid is highly toxic - keep containers sealed and out of the reach of children. If accidental consumption of fluid is suspected, seek medical attention immediately.

**⚠** If the fluid comes into contact with the skin or eyes, rinse immediately with plenty of water.

**⚠** Do not drive the vehicle with the fluid level below the MIN mark.

If the quantity of fluid in the brake/clutch reservoir drops below the recommended level, a red warning indicator in the Instrument panel will illuminate.

**Note:** If the warning indicator illuminates while the vehicle is being driven, stop the vehicle as soon as safety permits by gently applying the brakes. Check and top up the fluid level, if necessary.

**⚠** Seek qualified assistance immediately if brake pedal travel is unusually long or if there is any significant loss of brake fluid. Driving under such conditions could result in extended stopping distances or complete brake failure.

With the vehicle on level ground, check the fluid level at least every week (more frequently in high mileage or arduous operating conditions).

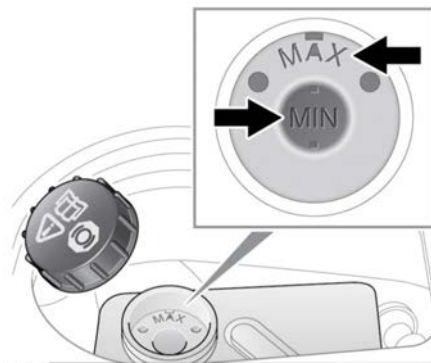

1. Clean the filler cap before removing, to prevent dirt from entering the reservoir.
2. Remove the filler cap.
3. The brake fluid level should be between the **MIN** and the **MAX** marks.

The fluid level may drop slightly during normal use as a result of brake pad wear, but should not be allowed to drop below the **MIN** mark.

## TOPPING UP THE BRAKE FLUID

**⚠** Brake fluid will damage painted surfaces. Soak up any spillage with an absorbent cloth immediately, and wash the area with a mixture of car shampoo and water.

**⚠** Only use new fluid from an airtight container. Fluid from opened containers or fluid previously bled from the system will have absorbed moisture, which will adversely affect performance and must not be used.

1. Top up the reservoir to the **MAX** mark. See **199, LUBRICANTS AND FLUIDS**.
2. Replace the cap.
3. Fit the reservoir cover in the reverse order of removal.