

WIPER OPERATION

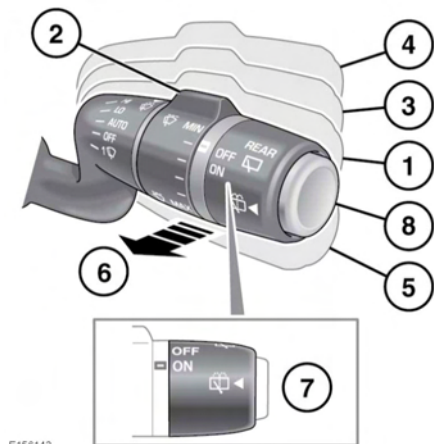

E156142

- ❗ Do not operate the wipers on a dry screen.
- ❗ In freezing or hot conditions, make sure the wipers have not stuck to the glass. Lift the wiper blades away from the screen when the ignition is off.
- ❗ Remove any snow, ice, or frost from the windscreen, around the wiper arms and blades, and the windscreen scuttle, before operating the wipers.

Note: If the wipers leave smears on the glass after the car has been washed, this may be due to wax or other residue. Should this occur, clean the glass with the recommended Land Rover screen cleaning paste. See **252, LUBRICANTS AND FLUIDS**.

Note: The windscreen will no longer be wiped effectively and the automatic Rain sensing function will degrade if the wipers become worn. Always replace worn or damaged wiper blades as soon as possible.

Note: If the wiper blades become stuck or jammed, an electronic cut-out will temporarily halt operation of the wipers. If this happens, switch off the wipers and the vehicle's ignition, when safe to do so. Clear any obstructions and free the wiper blades, before attempting to switch on the ignition.

Vehicles with rain sensor fitted:

1. Automatic Rain sensing mode: The front wipers will respond and adapt automatically to the ambient rain conditions, selecting the appropriate wiper frequency for the prevailing conditions. The sensitivity of the system can be adjusted by rotating the collar (2).
- ❗ Make sure the wipers are switched off before entering a car wash. If the automatic Rain sensing system operates during the car washing process, damage may occur to the wiper mechanism.
2. Rotate the collar to adjust the sensitivity of the automatic Rain sensing mode when position (1) is selected. The higher the sensitivity position the more responsive the system will become. When automatic rain sensing mode is selected, or when sensitivity is increased, the system will perform a single wipe.
3. Low speed continuous wipe.
4. High speed continuous wipe.
5. Single wipe of the windscreen, or hold down for further continuous wipes.
6. Windscreen wash/wipe: Pull and release to operate the front washers and wipers. The wipers will operate for 2 further wipes after the control is released. After a few seconds, a drip wipe will clear any residual washer fluid from the windscreen. If more washer fluid is required, pull and hold the control position.