

## STORAGE COMPARTMENTS

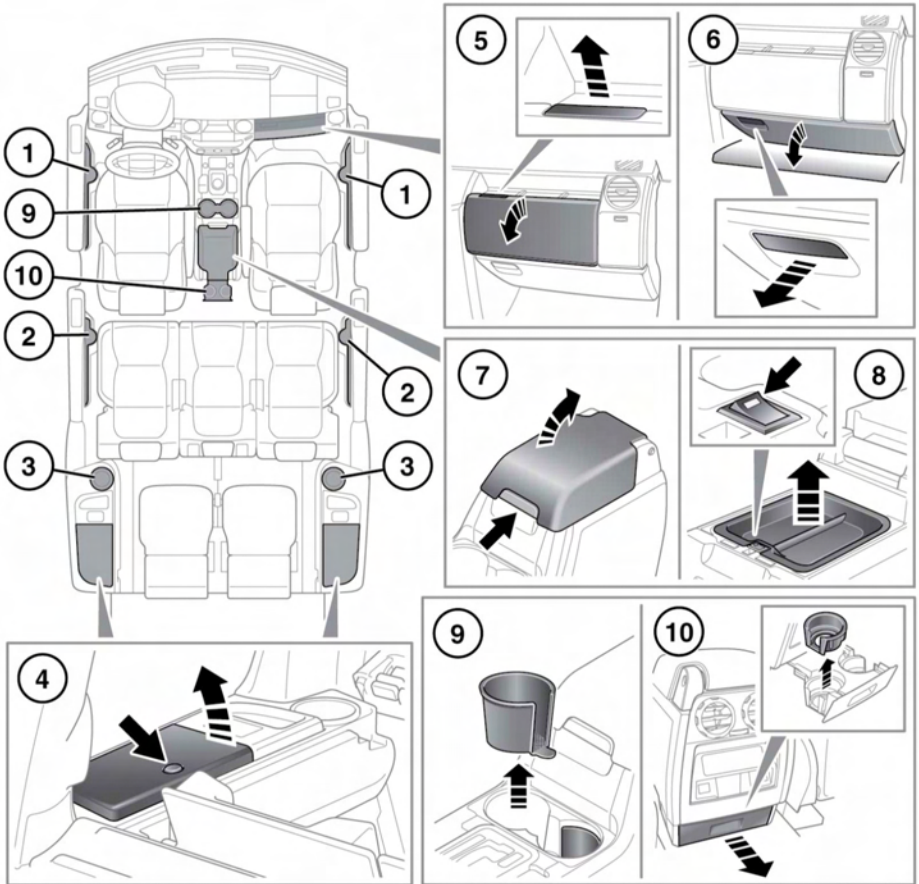

E 155559



**Make sure that any items stored in the vehicle are secure and cannot move. If the vehicle is involved in an accident, or subject to sudden braking or a change of direction, loose items can cause serious injury.**

1. Door cup holders.
2. Second row seat cup holders.
3. Rear compartment cup holders.
4. Rear storage bins.
5. Upper glovebox.
6. Lower glovebox.
7. Centre console storage: The rubber mat at the bottom of the centre console is designed to hold CD cases.

## Storage compartments

8. Cool box: Switch on and off using the switch on the inside front lip. There is a short delay between pressing the switch and illumination of the indicator. The cool box will work best when the cooling tray is used.

**Note:** *The cool box will only operate with the ignition turned on.*

**Note:** *The cool box is not a refrigerator, and will not attain the temperatures attained by a refrigerator. Repeated or prolonged opening of the cool box will reduce its ability to maintain temperature.*



The cool box should be switched off when it is not needed, to preserve battery charge.

9. Centre console cup holders.
10. Second row seat cup holders.