

AUDIO/VIDEO CONTROLS

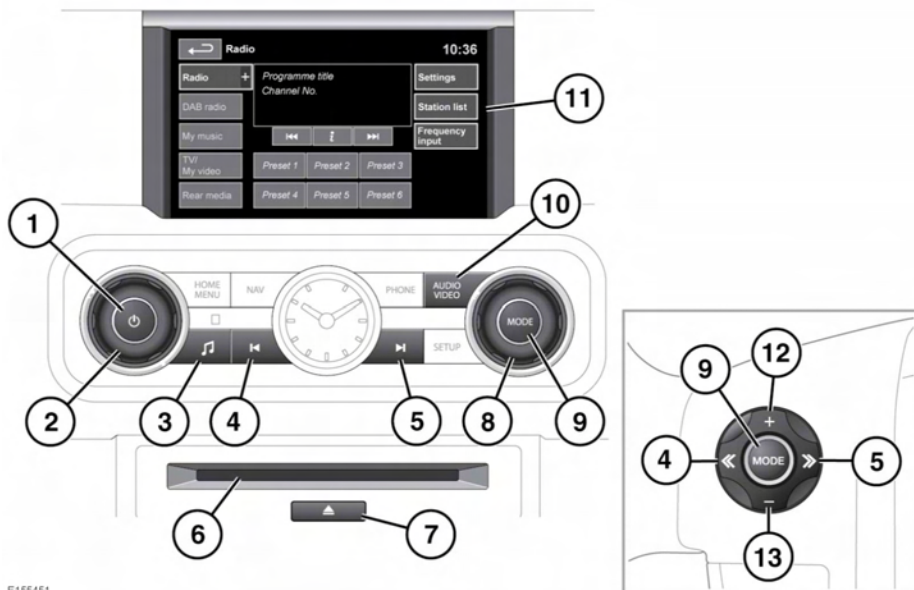

E155451



In the interest of safety, only operate, adjust or view the system when it is safe to do so.



Sustained exposure to high sound levels (greater than 85 decibels) can damage your hearing.

1. Press to switch the audio system on/off.

Note: The audio system will operate with the ignition on or off, but will always switch off when the ignition is switched off. Switch the audio on again if required.

2. Rotate to adjust the volume level.

Note: If the volume is turned to zero while a Compact Disc (CD) is playing, the CD will pause play. Play will resume when a greater volume is selected.

3. Press to display audio settings. When proximity cameras are fitted, this icon is changed and the button will turn cameras on/off.

4. Seek down:
Short press:

- To select the previous radio preset.
- To select the previous track or start of current track on chosen audio source - CD, MP3 etc.
- When the telephone is in use, press to scroll down lists of calls or phonebook entries.
- To select the previous TV channel on the channel list or the previous DVD chapter.

Long press: