

TRANSMISSION PARK RELEASE

When recovering the vehicle, it is essential that the Transmission park release mechanism is activated. This will lock the transmission in Neutral (N) and prevent the transmission from automatically selecting Park (P). The Transmission park release mechanism is activated by a lever, beneath the floor console cup holders.

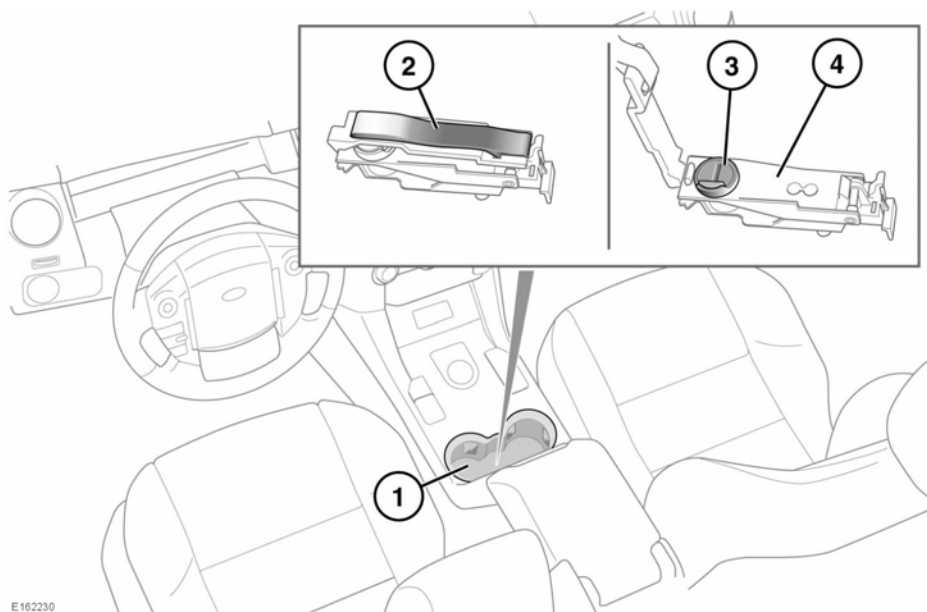

Make sure that the vehicle is secured with wheel chocks, apply the Electric Parking Brake (EPB), or firmly press the brake pedal. Failure to do so can result in unexpected movement of the vehicle, causing serious injury or death.



To activate the Transmission park release mechanism, carry out the following:

1. Remove both cup holders and the cup holder trim panel.
2. Pull the strap until the Transmission park release locking mechanism is accessible.
3. Turn the locking mechanism 90° anti-clockwise.
4. Use the strap to pull the Transmission park release mechanism upwards, until it latches in the vertical position.

When the transmission park release mechanism is activated, the gear selector will remain in **P**, but the selector indicator and the Instrument panel will both display a flashing **N**.

E162230