

## DIRECTION INDICATOR BULB REPLACEMENT

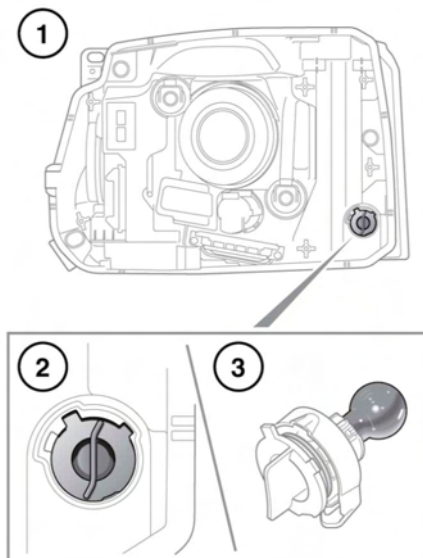

E156703

**Note:** The direction indicator bulb location is dependent on the vehicle specification.

1. Rotate the bulb holder 45 degrees anticlockwise.
2. Rotate to remove the bulb assembly from the lamp.
3. Push and twist to remove the bulb.

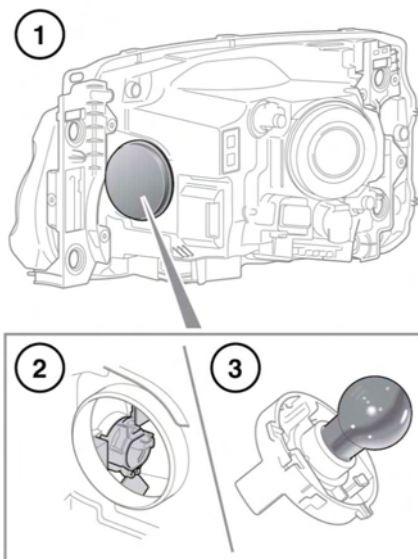

E156737

1. Twist and lift off domed cap.
2. Pull off the electrical connector and remove the bulb assembly.
3. Push and twist to remove the bulb.