

Fluid level checks

FLUID FILLER LOCATIONS

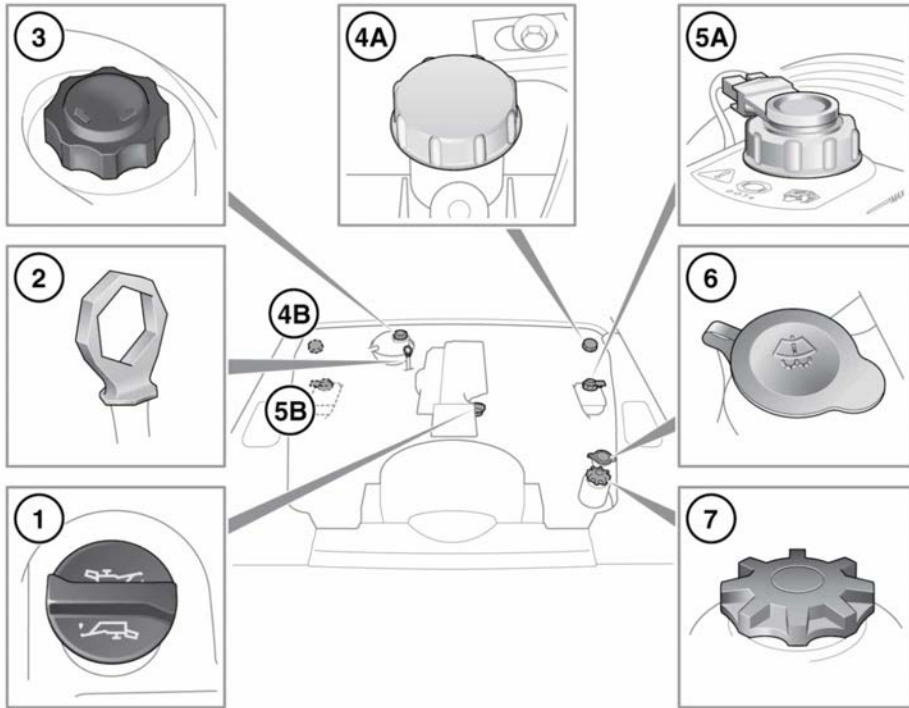

E135728

1. Engine oil filler cap - Black.
2. Engine oil dipstick - Yellow.
3. Engine coolant reservoir cap - Black.
4. Clutch fluid reservoir cap - Grey.
5. Brake fluid reservoir cap - White/Clear.
6. Screen washer fluid reservoir cap - Blue.
7. Power steering fluid reservoir cap - Black.

Note: *A and B* are designations for Left Hand Drive (LHD) and Right Hand Drive (RHD) vehicles.

For fluid and lubricant specifications, see **115, LUBRICANTS AND FLUIDS**.

It is essential that only the correct fluids as listed are used.

CHECKING THE ENGINE OIL LEVEL

- ⚠ Always top up with fluid of the correct specification. See **115, LUBRICANTS AND FLUIDS**.
- ⚠ Never allow the engine oil level to fall below the **MIN** mark on the dipstick. Damage could be caused to the engine.

Check when the engine is cold and the vehicle is on level ground.