

TOW BAR DIMENSIONS AND MOUNTING POINTS

Vehicles without rear tow step

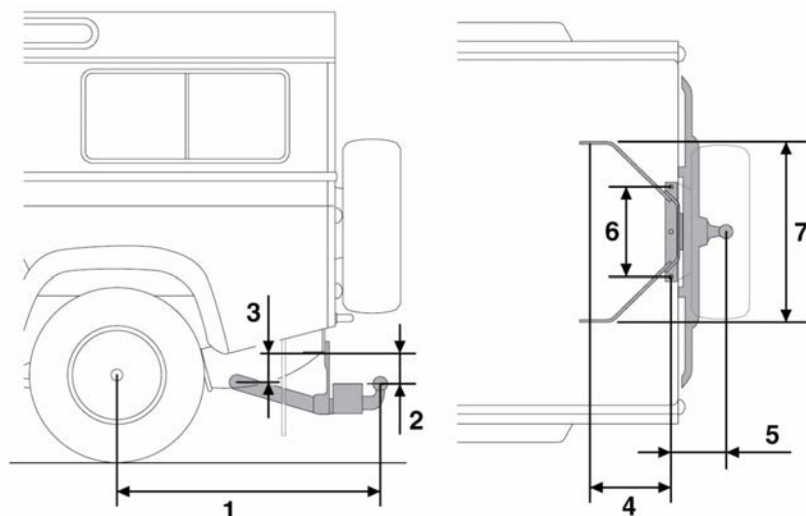

E135709

Note: Dimensions are in millimetres and apply to officially released Land Rover towing equipment.

| | | 90 | 110 | 110* & 130 |
|---|--|-----|------|------------|
| 1 | Wheel centre to centre of towball | 796 | 1005 | 1201 |
| 2 | Centre of inner attachment points to centre of towball | 86 | 86 | 86 |
| 3 | Centre inner attachments to centre outer attachments | 86 | 82 | 85 |
| 4 | Centre inner attachments to centre outer attachments | 208 | 301 | 301 |
| 5 | Centre of inner attachments to centre of towball | 107 | 107 | 303 |
| 6 | Distance between centres of inner attachments | 313 | 313 | 313 |
| 7 | Distance between centres of outer attachments | 744 | 635 | 635 |

*110 (High capacity pick-up).

- ❗ if a NATO hook or a Jaw and Pintle type towing accessory is to be fitted, do not attach them directly to the chassis rear cross member. It is essential that an adapter plate kit is also fitted. Consult your Dealer/Authorised Repairer.

A variety of tow bar mounting points are available. The precise points to use will depend upon the type of hitch. If unsure, consult your Dealer/Authorised Repairer.

Vehicles fitted with rear tow step

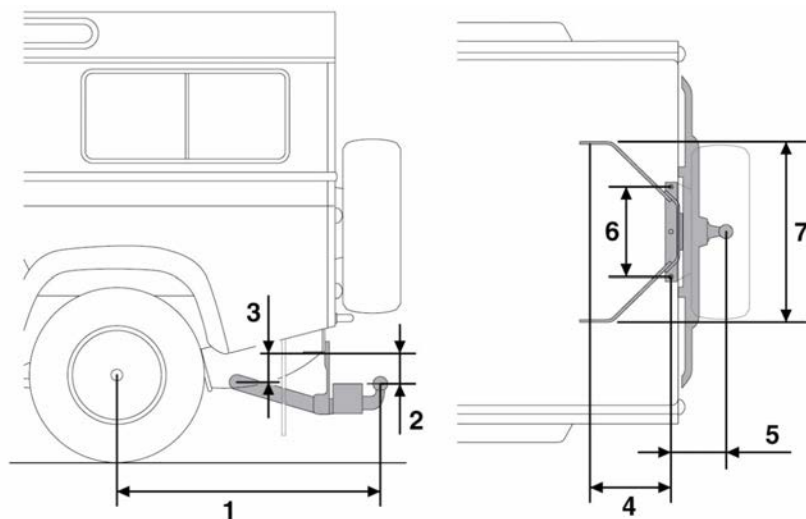

E135709

Note: Dimensions are in millimetres and apply to officially released Land Rover towing equipment.

| | | 90 SW | 110 SW |
|---|--|-------|--------|
| 1 | Wheel centre to centre of towball | 850 | 1135 |
| 2 | Centre of inner attachment points to centre of towball | 36 | 36 |
| 3 | Centre inner attachments to centre outer attachments | 137 | 85 |
| 4 | Centre inner attachments to centre outer attachments | 213 | 301 |
| 5 | Centre of inner attachments to centre of towball | 238 | 238 |
| 6 | Distance between centres of inner attachments | 313 | 313 |
| 7 | Distance between centres of outer attachments | 744 | 635 |