

FRONT SEAT BASE REFIT

 **Make sure that the seat base is securely fitted in place before driving.**

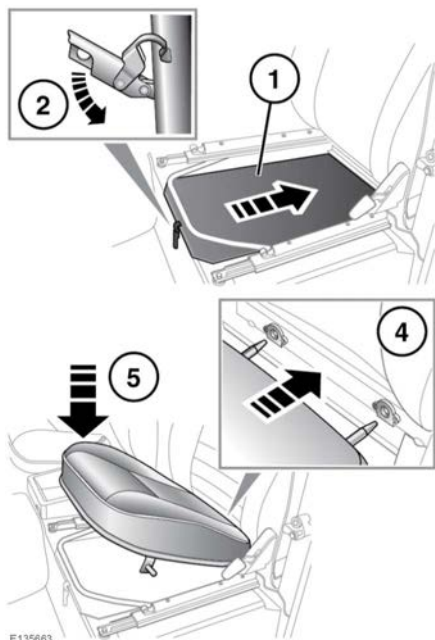

Refit a seat base as follows:

1. Slide the lid back into position and close it.
2. Secure the catch at the front of the compartment.
3. If applicable, reconnect the electrical connection.
4. Engage the 2 pins at the rear of the seat base into the receivers.
5. Push down firmly on the front edge of the base to engage the retaining clips.