

MANUAL HEAD RESTRAINTS

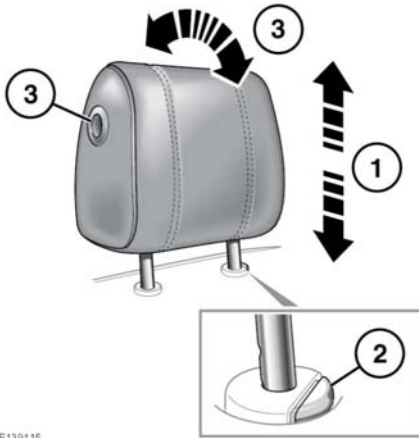

E139115

1. To raise, pull the head restraint upwards. It will click and lock in to position.
2. To lower, press the locking button and push down on the restraint.
3. To adjust the angle of the head restraint, press the locking button on the side of the restraint and tilt to the desired position.

Note: *There is no angle adjustment on front head restraints where a rear media screen is fitted.*

HEAD RESTRAINT REMOVAL



Always store a removed head restraint securely.



Do not drive, or carry passengers with the head restraints removed from occupied seats. The absence of a correctly adjusted head restraint increases the risk of neck injury in the event of a collision or sudden stop.

Manual head restraints may be removed, if required (e.g.: to fit larger child seats).

1. Raise the head restraint to its uppermost position and press the locking collar.

2. Lift the restraint out of the seatback.

Make sure the head restraint is refitted before the seat is used by a passenger.

1. Make sure the restraint is facing the correct direction.
2. Insert the stems of the head restraint into the sockets on the seatback.
3. Push the restraint downwards until at least the first click.

Note: *See 34, RECOMMENDED CHILD SEATS, for details on correct child restraint installation.*