

FOLDING AND RAISING THE REAR SEATS

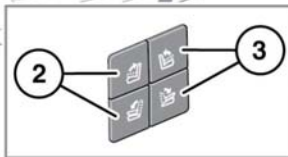

E140665

! Always make sure that objects carried in the vehicle are secured properly.

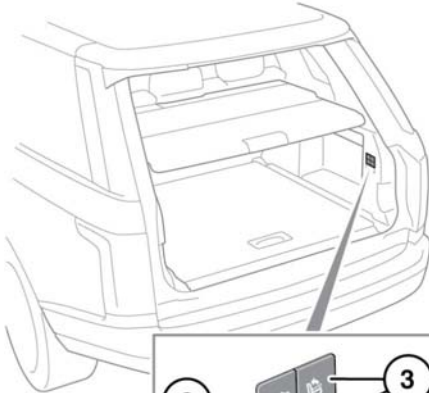
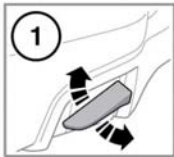

Never allow passengers to travel in the loadspace, under any circumstances.



Make sure that when the seatback is raised, the locking mechanism is fully engaged.



When erecting the rear seats, make sure that seat belts are correctly routed in the seat belt guides and not trapped behind the seats.



Make sure the head restraints are raised to the correct position before the seats are used by a passenger.

The split-fold rear seat can be folded completely to accommodate large loads, or partially to accommodate large loads and still retain seating for passengers.

1. Manual seats: raise the release lever. The seatback will fold down against the seat cushion. Lift the seatback to raise to the upright position and make sure the seatback is locked firmly in position.
2. Electric seats: press to fold/raise the left side seatback.
3. Electric seats: press to fold/raise the right side seatback.

Note: If the electric seats are operated more than 3 times through the full fold/raise sequence in quick succession, the system will be disabled for 2 minutes.

RESTRICTED REAR SEAT TRAVEL



If electric seat movement stops unexpectedly during folding or raising, check for and remove any obstructions.

Once any obstructions have been removed, continue the seat movement by pressing the appropriate fold/raise button for 2 seconds.

Note: If no obstructions can be seen, and normal movement cannot be carried out, contact your Dealer/Authorised Repairer.