

## OPENING AND CLOSING THE TAILGATE

**⚠** While the tailgate is open, the locking latch is exposed. Do not attempt to manually close the latch, as it may also automatically 'soft close' and trap items or body parts.

**ⓘ** Make sure there is minimum space of 1.5 metres (58 inches) above and at the rear of the vehicle before operating the tailgate. Insufficient space may result in damage to the vehicle.

**ⓘ** Do not operate the tailgate if a cycle rack is fitted to the tailgate. Remove any cycles and/or racks before operating the tailgate.

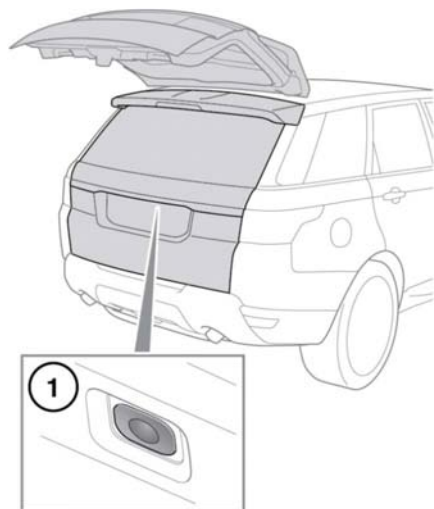

E149756

1. Tailgate release. Lift the tailgate to open.

**Note:** The tailgate external release button will operate if all of the doors are unlocked and the gear selector is in the Park (P) position. If the gear selector is in the Neutral (N) position, the button will only operate if all of the doors are unlocked, and the ignition is in convenience mode or switched off. The button will not operate if the gear selector is in any other position.

The tailgate can also be released using the following methods.

- The interior tailgate release button. See **314, DRIVER CONTROLS**.
- The Smart key tailgate release button. See **4, UNLOCKING THE VEHICLE**.

**Note:** The tailgate will not open if the vehicle is travelling at or above approximately 5 km/h (3 mph).

## OPENING AND CLOSING THE POWERED TAILGATE

**⚠** While the tailgate is open, the locking latch is exposed. Do not attempt to manually close the latch, as it may also automatically 'soft close' and trap items or body parts.

**ⓘ** Do not operate the tailgate if a cycle rack is fitted to the tailgate. Remove any cycles and/or racks before operating the tailgate.

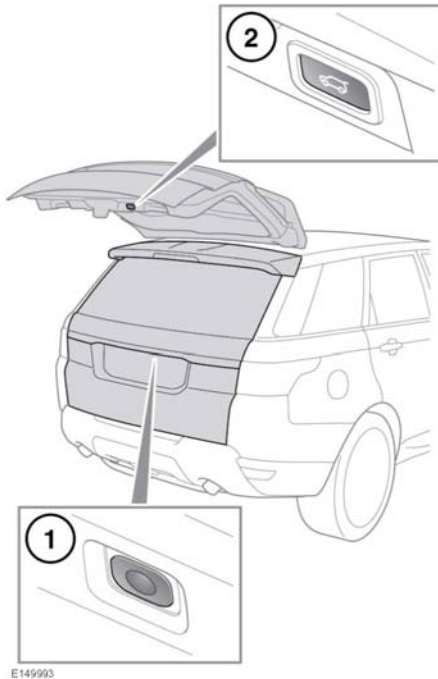

1. Tailgate open/close using the exterior button. Press to open, stop, reverse direction or close the tailgate.

**Note:** The tailgate external release button will operate if all of the doors are unlocked and the gear selector is in the Park (P) position. If the gear selector is in the Neutral (N) position the button will only operate if all of the doors are unlocked, and the ignition is in convenience mode or switched off. The button will not operate if the gear selector is in any other position.

2. Tailgate close button. Press to close/stop the tailgate.

The tailgate can also be opened or closed using the following methods.

- The interior tailgate release button. See **314, DRIVER CONTROLS**.

- The Smart key tailgate release button. See **4, UNLOCKING THE VEHICLE**.

After the tailgate has opened to its set height, it can be manually raised or lowered. If the tailgate fails to open or close correctly, close it manually and then press the tailgate release button again.

As the closing tailgate approaches the closed position, it will 'soft close' to the fully closed position. If the vehicle was previously locked, the alarm will re-arm. The hazard warning lamps will flash to confirm the alarm status. An audible confirmation may also be given.

**Note:** If a tailgate button is pressed while the tailgate is opening or closing, all movement will stop. However, if a button is pressed during the 'soft close' stage, the open request will be ignored.

**Note:** The tailgate has a minimum closing height, below which it will not power close. Open the tailgate manually, or using a release button, to the fully open position and then press the tailgate complete close button.



**Before operating the tailgate, make sure that anyone in the vicinity does not have any part of their body in a position where it could be trapped. Note that the 'soft close' action does not incorporate object detection. Death or serious injury could occur, even with an object detection system.**

Object detection while opening: If an object is detected that would interfere with the tailgate opening, tailgate movement will stop. Remove any obstructions and press the tailgate button again to open.