

## AUXILIARY POWER SOCKETS

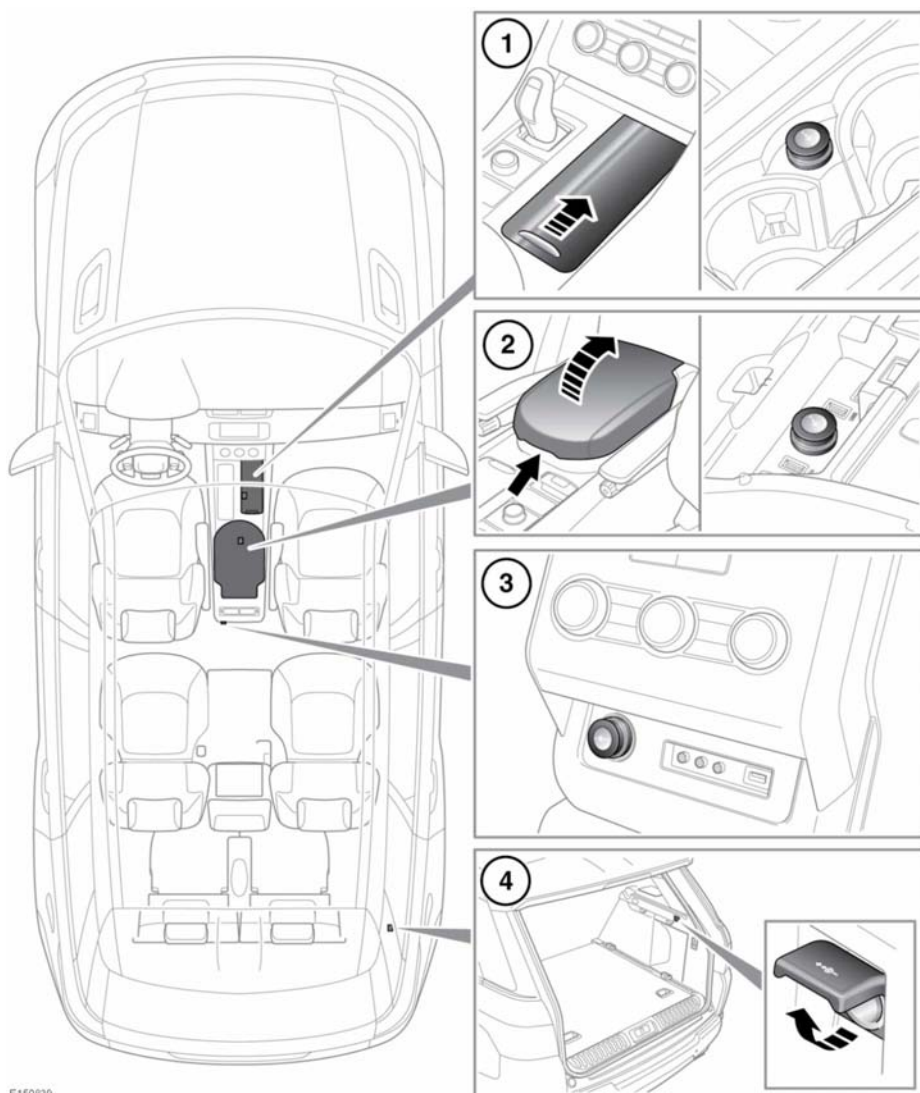

- 1. Front power socket.
- 2. Centre power socket.

- 3. Rear power socket.
- 4. Loadspace power socket.

E150839

## Storage compartments

- ⓘ Only use Land Rover approved accessories. Using any other equipment may damage the vehicle's electrical system. If you are in any doubt contact a Dealer/Authorised Repairer.
- ⓘ The engine should be running when using accessories for long periods. Failure to do so can discharge the battery.

**Note:** *Power sockets can be used to power approved accessories that use a maximum of 180 Watts.*