

## INSTRUMENT PANEL MENU

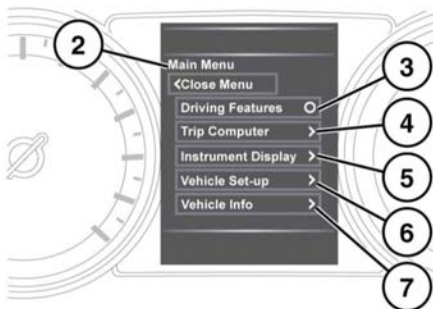
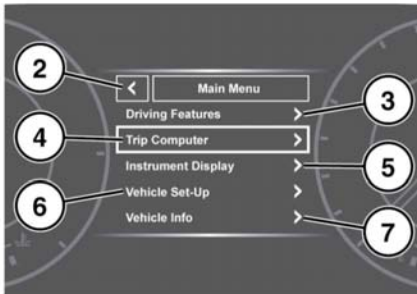
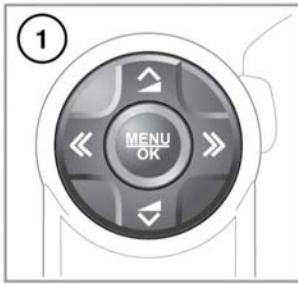

E150518

A number of vehicle features and display settings may be configured via the Instrument panel menu.

1. Steering wheel menu control. Press the relevant buttons to display and navigate through the Instrument panel menus.
2. Close and return to the **Main Menu**.
3. Access the **Driving Features** menu.
4. Access the **Trip Computer** menu.
5. Access the **Instrument Display** menu.
6. Access the **Vehicle Set-Up** menu.



**Before making any changes to the Vehicle Set-Up, you must make sure that you have read and fully understood the relevant topics/sections of the handbook.**

7. Access the **Vehicle Info** menu.

**Note:** Can only be accessed when the engine is not running.

### Digital Speedometer

A Digital speedometer is available in some markets. Dependent on the market specification, the driver may choose to turn the Digital speedometer on or off, or change the units from imperial to metric. The Digital speedometer can be accessed through the Digital speedometer option in the **Instrument Display** menu.

## WARNING AND INFORMATION MESSAGES



**Do not ignore warning messages, take appropriate action as soon as possible. Failure to do so may result in serious damage to the vehicle.**

For information regarding the individual messages, their meanings, and any action required, please refer to the relevant section within this handbook.

If more than 1 message is active, each is displayed in turn for 2 seconds in order of priority.