

AUXILIARY POWER SOCKETS

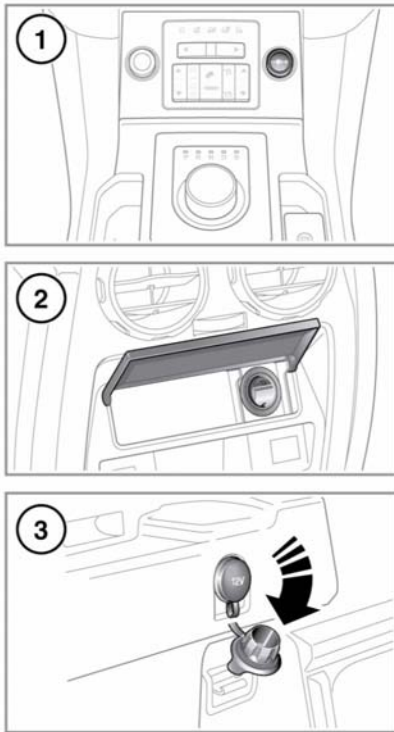

E155560

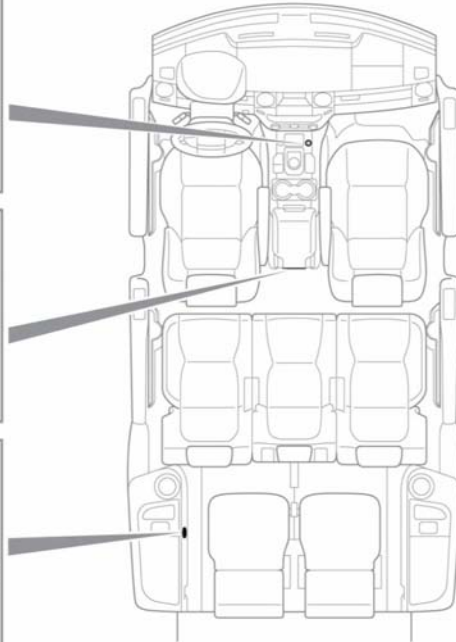

1. Front power socket.
2. Second row power socket.
3. Loadspace power socket.

NOTICE

Only use Land Rover approved accessories. Using any other equipment may damage the vehicle's electrical system. If you are in any doubt, contact a Retailer/Authorized Repairer.

NOTICE

The engine should be running when using accessories for long periods. Failure to do so can discharge the battery.

Note: Power sockets can be used to power approved accessories that use a maximum of 180 Watts.