

LASHING POINTS

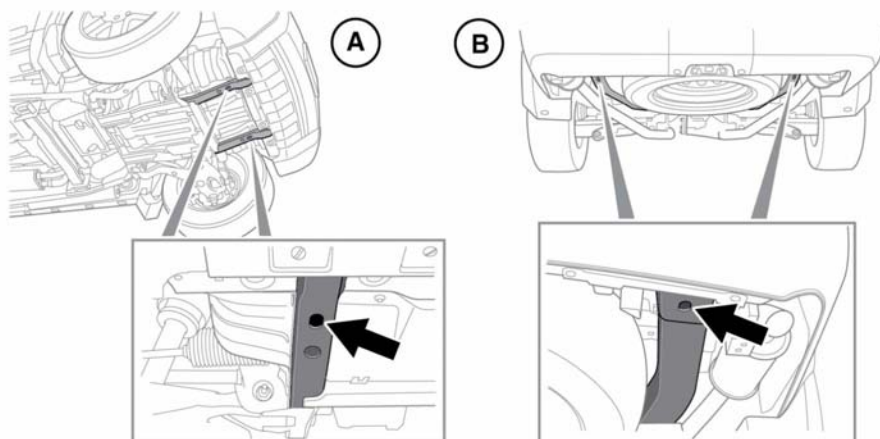

E135511

A. Front lashing points.

B. Rear lashing points.

⚠ WARNING

The front and rear lashing points must only be used to secure the vehicle during transportation. If they are used for any other purpose, it may result in vehicle damage and serious injury.

Note: The front and rear lashing points are for lashing only and must not be used for towing.

The two pairs of lashing points on the underside of the vehicle are provided for the insertion of appropriate hooks.

NOTICE

Do not secure lashing hooks to any other part of the vehicle.

TRANSPORTING THE VEHICLE

Recovery by trailer is the recommended method for transporting the vehicle.

Always use qualified persons to perform recovery and to make sure the vehicle is secured correctly.

⚠ WARNING

Use extreme caution when moving or towing the vehicle. Death or serious injury may occur.

NOTICE

If the vehicle electronics are operational, the air suspension must be set to access height, before securing the vehicle to a recovery vehicle or trailer. See **101, ACCESS HEIGHT**.

TOWING THE VEHICLE ON FOUR WHEELS

The vehicle should be recovered with all four wheels clear of the ground, i.e., on a trailer. However, if the vehicle cannot be recovered by using the correct method, in an emergency the vehicle can be towed on all four wheels for a short distance. Please adhere to the following guidelines: