

ELECTRIC PARKING BRAKE (EPB)

⚠ WARNING

Do not rely on the Electronic Parking Brake (EPB) to hold the vehicle stationary if the brake warning lamp is illuminated or the EPB warning lamp is flashing. Seek qualified assistance urgently.

NOTICE

The EPB operates on the rear wheels; therefore, secure parking of the vehicle is dependent on being on a hard and stable surface.

NOTICE

Do not rely on the EPB to operate effectively, if the rear wheels have been immersed in mud or water.

Note: If the vehicle is used in severe off-road conditions (e.g., wading, deep mud, etc.), additional maintenance and adjustment of the EPB will be required. Consult your Retailer/Authorized Repairer.

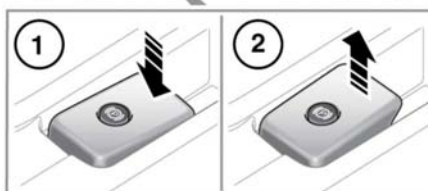
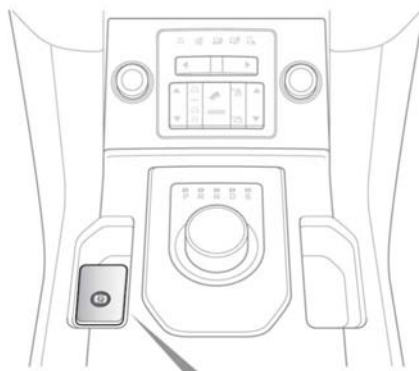

E158190

The switch which operates the EPB is mounted on the center console, to the side of the gear selector.

To disengage the EPB (1): With the ignition system on or with the engine running, apply the brake pedal and press the EPB switch down.

If the EPB is applied while the vehicle is stationary and Drive (D) or Reverse (R) is selected, applying the throttle will automatically release the EPB.

The EPB is also automatically released when the gear selector is moved from the Park (P) position.

If the EPB is inadvertently applied when the vehicle is moving at above 1.8 mph (3 km/h),

Caution! Park Brake Applied is displayed in the Message center, the warning lamp in the Instrument panel will illuminate and a warning chime will sound.

If the EPB is applied while the vehicle is moving, releasing the switch will disengage the EPB. The EPB cannot be applied when the vehicle is moving, if the accelerator pedal is pressed.

Note: *If the vehicle is in motion, the EPB should only be used as an emergency brake.*

NOTICE

Always apply the EPB when the vehicle is parked.

To engage the parking brake (2): Pull the EPB switch upwards and release. The switch will return to the neutral position.

The EPB warning lamp in the Instrument panel will illuminate, see **51, PARKING BRAKE (RED)**.

The Drive-away release feature allows the EPB to release automatically as the vehicle is driven away.

The warning lamp in the Instrument panel will remain on for a short time, if the EPB is applied when the ignition system is on after the engine is switched off.

If a fault in the system is detected, **Park Brake Fault** or **Cannot Apply Park Brake** will be displayed in the Message center. Seek qualified assistance as soon as possible.

If the battery has been discharged or disconnected, **Apply Foot And Park Brake** will be displayed in the Message center when the ignition is next switched on. Depress the brake pedal and pull the EPB switch up to apply the parking brake. This is required to reset the EPB system. The EPB will now function correctly.