

TOWING EYES

⚠ WARNING

The towing points at the front and rear of the vehicle are designed for on-road recovery only. If they are used for any other purpose, it may result in vehicle damage and serious injury.

NOTICE

Remove the front and rear towing point covers before driving off-road, to prevent damage or loss.

OFF-ROAD RECOVERY

⚠ WARNING

If the towing points are to be used for off-road recovery, it is essential that off-road driver training covering recovery techniques is undertaken.

Further information on off-road driver training can be found at:
<http://www.landroverexperience.com>.

ATTACHING THE FRONT TOWING EYE

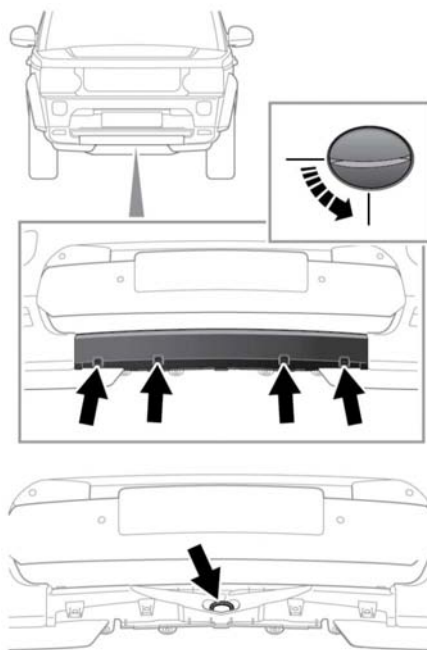

E155600

The front towing point is located behind a removable cover in the lower front bumper.

1. Rotate each of the fasteners 90 degrees counter-clockwise with a coin (or similar).
2. To remove the cover, lower the top edge and then pull the cover forward.
3. To refit, offer up the cover and make sure the two lugs at the bottom edge engage with the holes in the body panel.
4. Secure the cover in position by rotating each of the fasteners 90 degrees clockwise.

REAR TOWING POINT

The rear towing point is located behind a removal panel in the lower rear bumper.

Vehicle recovery

The rear towing point may be used to tow another vehicle if required.

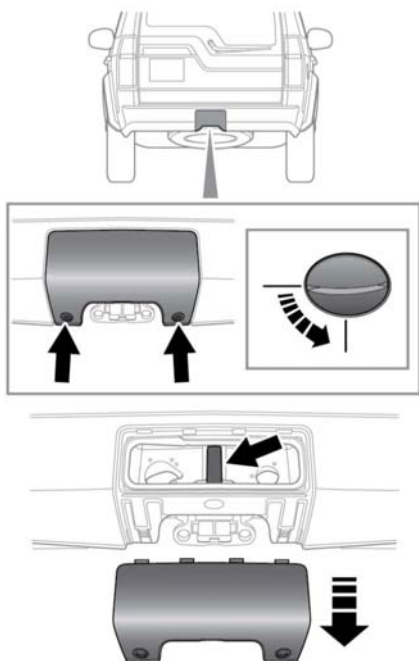

E155608

1. Rotate each of the fasteners 90 degrees counter-clockwise with a coin (or similar), to release the lower edge.
2. Rotate the cover to release the hooks at the top.
3. Remove the cover.
4. To refit, position the cover in place and make sure that the 4 hooks on the top edge engage in the body panel.
5. Rotate the fasteners 90 degrees clockwise to secure the cover.