

Vehicle battery

CALIFORNIA PROPOSITION 65 SECOND WARNING STATEMENT

⚠ WARNING

Battery posts, terminals and related accessories contain lead and lead compounds. Wash hands after handling.

BATTERY WARNING SYMBOLS



Do not allow open flames or other sources of ignition near the battery, as the battery may emit explosive gases.



Make sure that when working near or handling the battery, suitable eye protection is worn, to protect the eyes from acid splashes.



To prevent risk of injury, do not allow children near the battery.



Be aware that the battery may emit explosive gases.



The battery contains acid which is extremely corrosive and toxic.



Consult the handbook for information, before handling the battery.

BATTERY CARE

⚠ DANGER

If swallowed, battery fluid can be fatal. Seek medical assistance immediately.

⚠ WARNING

If battery fluid comes into contact with your eyes, skin, or clothes you should remove the affected clothing and flush the skin/eyes with plenty of water. Seek medical assistance immediately.

⚠ WARNING

Do not connect any 12 volt equipment directly to the battery terminals. Doing so may cause a spark, which can result in an explosion.

⚠ WARNING

The cell plugs and vent pipe must be in place at all times when the battery is connected to the vehicle. Make sure that the vent pipe is clear of obstructions and not kinked. Failure to do so may cause a pressure build up in the battery, resulting in an explosion.

⚠ WARNING

Do not expose the battery to an open flame or spark as the battery produces explosive, flammable gas.

⚠ WARNING

Never jump start, boost, charge, or try to start a vehicle with a frozen battery. Doing so can result in an explosion.

⚠ WARNING

To prevent the chance of an electric shock, remove all metal jewelry before working on or near the battery, and never allow metal tools or vehicle components to come into contact with the battery terminals.

WARNING

Do not allow the battery posts or terminals to come into contact with your skin. They contain lead and lead compounds, which are toxic. Always wash your hands thoroughly after handling the battery. Also see 176, CALIFORNIA PROPOSITION 65 SECOND WARNING STATEMENT.

NOTICE

Do not allow battery fluid to come into contact with fabrics or painted surfaces. If battery fluid comes into contact with any surface, the surface should be washed down immediately with plenty of clean water.

Your vehicle is fitted with a low maintenance battery, which is located under the floor of the luggage compartment.

In hot climates more frequent checks of the battery fluid level and condition are required. If necessary, the battery cells can be topped up using distilled water.

BATTERY MONITORING SYSTEM (BMS)

The Intelligent Power System Management (IPSM) continuously monitors the condition of the main vehicle battery. If excessive battery discharge occurs, the system will begin to shut down non-essential electrical systems in order to protect the battery.

If the IPSM calculates that battery condition is not within set parameters, there are 2 levels of action which can be taken. Both levels have an accompanying message on the Touch screen, and in the case of the low battery warning, in the Message center.

- **Energy Management:** Will be displayed on the Touch screen if the engine is not running, and system features are causing excessive battery discharge. After 3 minutes the IPSM will begin shutting down vehicle systems. Normal system operation will resume when the engine is started.
- **Low Battery - Please Start Engine:** Will be displayed on the Touch screen and Message center if the engine is not running. After 3 minutes the IPSM will begin shutting down vehicle systems. Normal system operation will resume when the engine is started.

NOTICE

Only start the engine if it is safe to do so.

Note: *If the message **Low Battery - Please Start Engine** is displayed, drive the vehicle for at least 30 minutes in temperatures above 32°F (0°C) or at least 60 minutes if temperatures are below 32°F (0°C). This will allow the battery to recover to an acceptable level. If normal system operation is not resumed when the engine is switched back off, the battery may not have been sufficiently charged. If safe to do so, re-start the engine. If problems still exist, contact your Dealer/Authorized Repairer.*

Vehicle battery

CONNECTING JUMP LEADS

⚠ WARNING

Always wear appropriate eye protection when working with batteries.

Make sure both batteries are of the 12 volt type and that the jump leads have insulated clamps and are approved for use with 12 volt batteries.

Do not disconnect the discharged battery.

Do not connect a jump lead to the negative (-) terminal of the battery. Always connect to the recommended earthing point.

Make sure the bodywork of the donor and disabled vehicles do not touch.

Note: Before connecting jump leads, make sure that the battery connections on the disabled vehicle are correct and that all electrical equipment has been switched off. To access the luggage compartment when the battery is discharged, see **85, LUGGAGE COMPARTMENT RELEASE WHEN BATTERY IS DISCHARGED**.

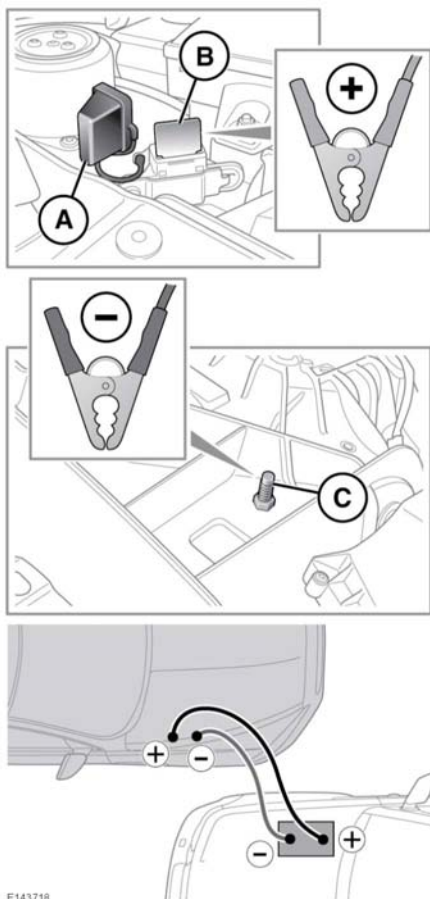

E143718

With the hood open and the engine cover removed (see **161, UNDER HOOD COVERS - REMOVAL**):

1. Connect the positive jump lead (Red) to the positive terminal on the donor vehicle's battery.
2. Remove the positive terminal cover (A) and connect the other end of the positive jump lead to the positive terminal (B).

3. Connect the negative jump lead (Black) to the recommended jump starting earth point of the donor vehicle.
4. Connect the other end of the negative jump lead to the negative post (C).

NOTICE

Check that all cables are clear of any moving components and that all 4 connections are secure.

5. Start the engine of the donor vehicle, and allow it to idle for a few minutes.
6. Start the engine of the disabled vehicle.
If repeated attempts to start the disabled vehicle are needed, allow the donor vehicle to idle for a few minutes between attempts.
7. Allow both vehicles to idle for 2 minutes.
8. Switch off the donor vehicle.

DISCONNECTING JUMP LEADS

⚠ WARNING

To avoid serious injury use extreme caution when removing the jump leads as the engine will be running on the previously disabled vehicle. This means that you may be working close to components which are moving at high speed, carry high voltage, or may be hot.

Note: Do not switch on any electrical equipment until after the cables have been disconnected.

The engine should be running on the previously disabled vehicle and the engine switched off on the donor vehicle. Disconnect the jump leads in the exact reverse order of that used for connection.

CONNECTING A STARTING AID

⚠ WARNING

Do not connect the starting aid to any battery terminal on your vehicle. Doing so may cause a spark, which can result in an explosion. It may also result in damage to the charging system.

To start the vehicle using a starting aid or a booster battery, follow the instructions in the sequence given.

1. Connect the positive (Red) cable to the positive terminal (in the engine compartment) of the disabled vehicle.
2. Connect the negative (Black) cable to the negative terminal (in the engine compartment) of the disabled vehicle.
3. Connect/switch on the starting aid.
4. Start the engine and allow it to idle.
5. Disconnect/switch off the starting aid.
6. Disconnect the negative (Black) cable from the negative terminal of the vehicle.
7. Disconnect the positive (Red) cable from the positive terminal of the vehicle.

CHARGING THE VEHICLE BATTERY

NOTICE

The battery must be disconnected and removed from the vehicle before charging.

NOTICE

Battery disconnection, removal and replacement, should only be carried out by qualified personnel. Consult your Dealer/Authorized Repairer.

REPLACING THE VEHICLE BATTERY

NOTICE

Battery disconnection, removal and replacement, should only be carried out by qualified personnel. Consult your Dealer/Authorized Repairer.



Used batteries must be disposed of correctly, as they contain a number of harmful substances. Seek advice from your Dealer/Authorized Repairer and/or your local authority.