

USING THE PARKING AID

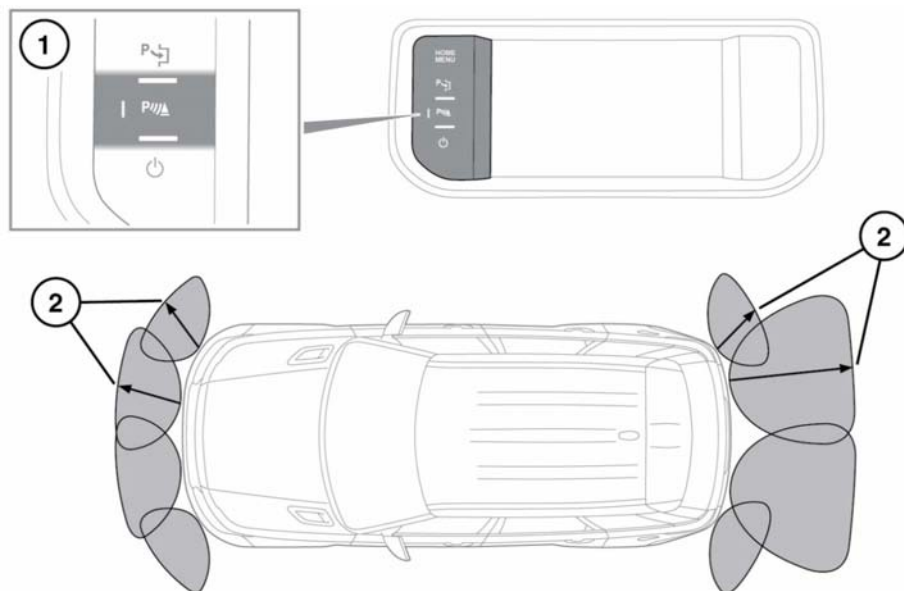

1. Parking aid button.
2. Parking aid sensor detection zones.

⚠ Parking aid sensors will not detect moving objects such as children and animals, until they are dangerously close. Always use extreme caution when manoeuvring.

ⓘ Parking aid sensors may not detect some obstructions, for example narrow posts or small objects close to the ground.

ⓘ If accessories, e.g., tow bar, are fitted to the rear of the vehicle, particular care must be taken when reversing. The rear sensors will only indicate the distance from the bumper to the obstacle.

Note: If a trailer is connected to a Land Rover approved trailer socket, the rear sensors will be disabled.

The Parking aid system is automatically activated when the vehicle speed decreases to less than 10 km/h (6 mph) or when Reverse (**R**) gear is selected. The Parking aid button indicator will illuminate to inform the driver that the system is active. To switch the Parking aid system off, press the button.

The Parking aid system will remain off until the next ignition cycle, Reverse (**R**) gear is selected, or the system is manually switched back on again.

The Parking aid system assists the driver while manoeuvring the vehicle in confined spaces. When active, object tracking along the front or rear of the vehicle will be displayed on the Touch screen.

When Reverse (**R**) gear is selected, both front and rear sensors will be active. When Drive (**D**) is selected, only the front sensors will be active.

Note: If the system does not detect an object likely to come into contact with the vehicle, it will not display any tracking information in the Touch screen.

When in Reverse (**R**) both the front and rear sensors are active, when in Drive (**D**) only the front sensors are active.

When objects are detected, the Parking aid systems emit a warning tone which increases in frequency as the vehicle gets closer to an object. The tone becomes constant when the obstacle is within 300 mm (12 inches).

The Parking aid system operates up to a speed of 16 km/h (10 mph).

CLEANING THE SENSORS

- ⚠ When washing the vehicle do not aim high pressure water jets directly at the sensors. Do not use abrasive materials or hard/sharp objects to clean the sensors. Only use approved vehicle shampoo.

The sensors should be kept clean to maintain accuracy and performance.

PARKING AID SYSTEM FAULT

If a system fault is detected, a long high-pitched tone will sound, the switch indicator will flash and the message **Parking Aid is not available**.

Please consult your dealer will be displayed on the Touch screen. Contact your Dealer/Authorised Repairer as soon as possible.

REAR CAMERA



It remains the driver's responsibility to detect obstacles and estimate the vehicle's distance from them when reversing.



Some overhanging objects or barriers which could cause damage to the vehicle, may not be detected by the camera.

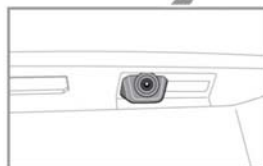
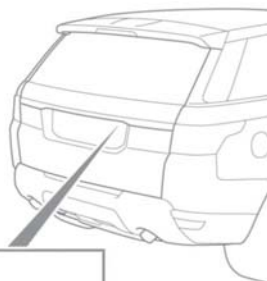

E149980

When reverse gear is selected, the screen automatically displays a wide angle, colour image from the rear of your vehicle.

The rear view camera system provides a rear view image to assist in reversing the vehicle. Overlaid on the image are reversing guidelines.

To adjust the camera settings while in reverse, touch anywhere on the Touch screen to display the user options or select **Extra features**, from the home menu, touch **Cameras** and select **Settings**.

Note: A camera icon will be displayed on the user options screen, when selected from **Extra features**. Touch the camera icon, to return the rear view camera screen

Parking aids

Note: The rear camera display has priority over the Parking aids display. To cancel the camera display at any time, push the **Home Menu** button or touch the back soft key.

Rear view camera display on the Touch screen will discontinue when either of the following apply:

- Drive is selected for longer than 5 seconds.
- Drive is selected and/or vehicle speed is greater than 18 km/h (11 mph).

4. Parking sensor activation: A coloured area appears, to indicate which rear sensor(s) has been activated.
5. Touch to enable/disable (1), (2) and (3).
6. Touch to enable/disable (4) Parking sensor.
7. Touch to enable/disable Hitch Assist guidance lines. (5) and (6) will be disabled when the Hitch Assist guidance is active.

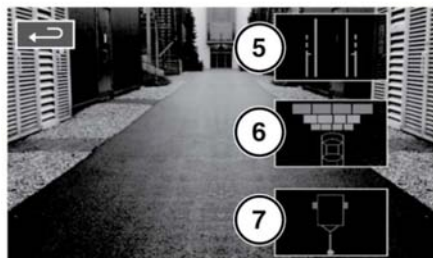
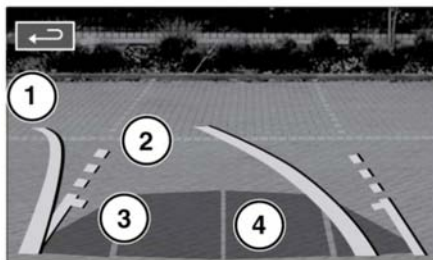

E153094

1. Solid line: The projected path based on current steering wheel position.
2. Dotted line: The safe working width of the vehicle (including exterior mirrors).
3. Tailgate access guideline: Do not reverse beyond this point if tailgate access is required.

REVERSE TRAFFIC DETECTION

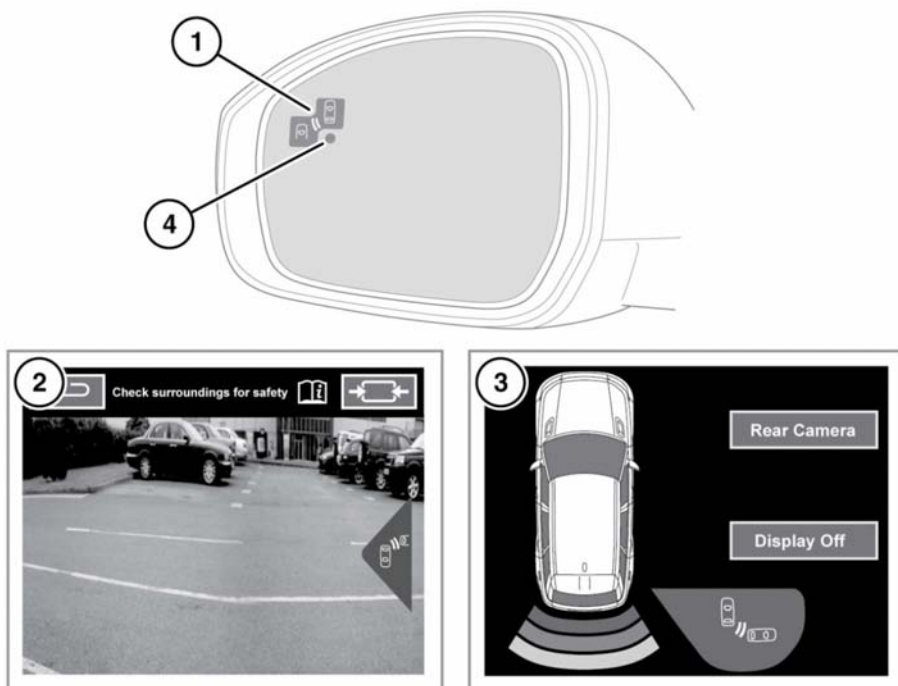

E149959



The Reverse Traffic Detection (RTD) system is a supplement to, not a replacement for, safe driving, good observation and use of the exterior and rear-view mirrors.

Note: RTD is automatically disabled when a trailer is connected and when Park assist is active.

In addition to the functionality provided by the rear view camera, the RTD system provides a warning to the driver of any moving vehicle, at either side, that may pose an accident risk during a reversing manoeuvre.

An amber warning icon (1) will flash in the relevant exterior mirror and an audible warning will be emitted to indicate the presence of a moving vehicle. The rear view camera screen (2) or the parking aid screen (3) will also show a warning on the relevant side(s) of the screen. To switch between the rear view camera and the parking aid screen, touch the camera image or the **Rear camera** icon accordingly.

The system can be enabled or disabled via the relevant panel menu. See **46, INSTRUMENT PANEL MENU**. When RTD is disabled, an amber dot (4) will be displayed in both exterior mirrors.

REVERSE TRAFFIC DETECTION SENSORS

The RTD system will automatically disable if any of the sensors become partially or completely obscured. The amber warning indicator dot will illuminate in the exterior mirrors and the message **Reverse Traffic Sensor Blocked** appears in the message centre.

Check that there is nothing obscuring the rear bumper and it is clear from ice, frost, snow, mud and dirt.

If a fault with a radar sensor is detected, an amber warning indicator dot will illuminate in the exterior mirrors and the message **Reverse Traffic Detection System Not Available** is displayed in the message centre.

Note: *Even if the detected fault only affects the radar sensor on one side of the vehicle, the whole system is disabled. If the fault is temporary, the system will operate correctly once the engine has been switched off and then on again.*

If a fault occurs, consult your Dealer/Authorised Repairer.