

## AIR SUSPENSION SYSTEM

**⚠ Make sure that the vehicle is clear of people and obstacles before lowering the suspension. The difference between Off-road height and Access height can be 115 mm (4.5 in).**

The air suspension system may be used to raise or lower the height of the vehicle, using the air suspension control switch.

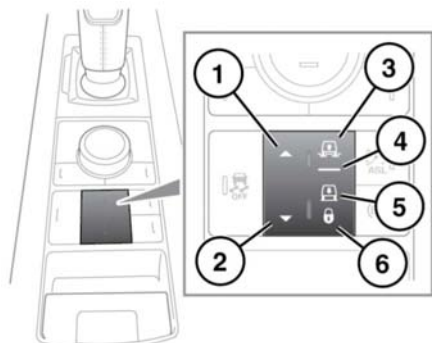

E 150 103

1. Raise the suspension height.
2. Lower the suspension height.
3. Off-road height indicator.
4. Normal height indicator.
5. Access height indicator: Access height is 50 mm (2.0 in) lower than normal height.
6. Suspension locked in Access height indicator.

**Note:** The system may raise or lower the vehicle automatically (e.g. if a terrain response program requires it, or if the vehicle is travelling at high speed).

Changes to the height of the vehicle must be made when all doors are closed. Except for remote operation (see **109, REMOTE OPERATION**) the engine must also be running or in Intelligent stop/start mode. If a door is opened during a height change, the height change will be suspended. If the door is closed within 90 seconds, the height change will resume. If the doors are not closed in time the message centre will display a message **CONFIRM REQUIRED SUSPENSION HEIGHT**. Driving off will return the vehicle to normal height.

**Note:** If the air suspension is used many times in succession, speed of operation may slow.

## OFF-ROAD HEIGHT

Off-road height can be selected from normal height by pressing up on the raise/lower switch (1) at any speed up to 70 km/h (43 mph). The message centre will display **OFF-ROAD HEIGHT SELECTED**.

The Off-road height is dependent upon vehicle speed. The Off-road height selected will be confirmed with an **Off-Road (1) or (2)** icon in the Touch screen display when in the **4x4 info** menu.

**Off-Road 1** height is 35 mm (1.4 in) above normal height up to 80 km/h (50 mph).

**Off-Road 2** height is 65 mm (2.6 in) above normal height up to 50 km/h (31 mph). The suspension height can change automatically between these heights. **Off-Road 2** can be selected when at **Off-Road 1** height by pressing up on the raise/lower switch when travelling less than 40 km/h (25 mph).

To select normal height, press down on the raise/lower switch (2) or increase the speed above 80 km/h (50 mph).

## EXTENDED MODE

If the vehicle body is raised (e.g. by jacking) or grounded in severe off-road conditions, the system may automatically enter Extended mode. Symbols in the raise/lower switch will flash and the message centre will display **SUSPENSION IN EXTENDED MODE**. The suspension can rise automatically to assist in clearing the obstacle.

Once extended mode height has been achieved, the driver may request additional lifting if required. This is achieved by pressing up and holding the raise/lower switch for longer than 3 seconds while pressing the brake pedal.

Extended mode is cancelled by pressing down on the raise/lower switch (2) or when the vehicle speed confirms that the body is no longer lifted or grounded.

**Note:** *Extended mode cannot be selected manually.*

## ACCESS HEIGHT

To select Access height, press down on the raise/lower switch (2). If the suspension is at Off-Road height then press down twice on the raise/lower switch. **ACCESS HEIGHT SELECTED** will be displayed in the message centre. Access height can be selected at any speed, but the height will not change until travelling slowly. Access selection is cancelled if the vehicle speed does not slow sufficiently within 1 minute.

**Note:** *Access height may be selected up to 1 minute after the ignition is switched off, provided the driver's door has not been opened.*

Normal driving will automatically return the suspension from Access height to the previous selected setting.

Normal height can be selected by pressing up on the raise/lower switch (1).

## LOCKED ACCESS HEIGHT

When the vehicle is at Access height and travelling less than 35 km/h (22mph), press down on the raise/lower switch (2) for longer than 1 second. The system lock indicator (5) will illuminate and **SUSPENSION LOCKED AT ACCESS HEIGHT** will be displayed in the message centre.

The vehicle may then be driven slowly at Access height, to assist with manoeuvring in confined areas (e.g. multi-storey car parks).

To cancel this mode, press up on the raise/lower switch (1) for longer than 1 second or increase the speed to 40 km/h (24 mph).

## REMOTE OPERATION



**The Smart key can be operated from inside or outside the vehicle. It is therefore important that it is kept out of the reach of children at all times.**



**Make sure the vehicle is clear of people and obstacles before lowering the suspension. The difference between Off-road height and Access height can be 115 mm (4.5 in).**



Care should be taken with all height changes when a trailer is attached to the vehicle.

The buttons on the Smart key may be used to operate the air suspension system, allowing the vehicle to be raised or lowered remotely. This may be useful in attaching a trailer or loading the vehicle.

To change the suspension height using the Smart key, the vehicle must be stationary, all the doors closed and the hazard warning lamps switched on.

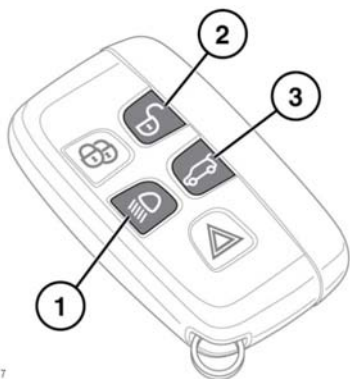

E134947

To raise the vehicle press and hold button (1) and button (2) together.

To lower the vehicle press and hold button (1) and button (3) together.

**Note:** If the starting height is above or below normal height, movement will cease when normal height is reached. Release the Smart key buttons and press again to continue.

## ADAPTIVE DYNAMICS

If a fault is detected the Instrument panel will illuminate either the Critical or General warning lamp. See **49, CRITICAL WARNING MESSAGE (RED)** **49, GENERAL WARNING/INFORMATION MESSAGE (AMBER)** The warning messages **ADAPTIVE DYNAMICS FAULT** or **SUSPENSION FAULT VEHICLE LEAN WHEN CORNERING** will also be displayed in the message centre. Some reduction in ride comfort may be experienced. If the fault persists, consult a Land Rover Dealer/Authorised Repairer.

## SUSPENSION LOWERED FOR SAFETY



The vehicle ride height will be reduced. Exercise caution while driving off-road.

In the event of a fault with the DSC system, the ride height will be lowered to increase vehicle stability. This will be accompanied by a message in the message centre and the indicators on the air suspension control switch will extinguish.



**The suspension is lowered to increase vehicle stability and overriding the suspension ride height reduction is not recommended. Doing so could result in a vehicle rollover during extreme manoeuvres.**

To override the ride height reduction:

1. Press the raise/lower switch.
2. Follow the instructions in the message centre.

**Note:** If the vehicle is driven enthusiastically while the system override is active, a message will be displayed in the message centre as a reminder that a safety system has been bypassed. A further message will provide instructions for cancelling the override.