

### SINGLE LOCKING

Press the lock button on the Smart Key briefly to single lock the vehicle and activate the perimeter alarm. The hazard warning lamps will flash to confirm.

Single locking secures the vehicle and prevents the doors from being opened from outside. The doors may still be unlocked and opened from inside the vehicle. In this state, only the perimeter alarm is activated. See **13, PERIMETER ALARM**.

**Note:** *This setting should be used in circumstances such as travelling on a ferry, when pets are to be left in the vehicle, or if a window must be left open etc.*

### DOUBLE LOCKING



**Never double lock the vehicle with people, children, or pets inside. In the event of an emergency they would be unable to escape and the emergency services would be unable to release them quickly.**

Press the lock button on the Smart Key twice within 3 seconds to double lock the vehicle and activate the full alarm system. The hazard warning lamps will flash twice to confirm.

Double locking secures the vehicle and prevents the doors being opened from inside or outside of the vehicle. The doors cannot be unlocked or opened from inside the vehicle when double locked.

This provides extra security if the vehicle is left unattended. The vehicle cannot be opened by breaking a window and operating the door locks from inside. Additionally, double locking also activates the full alarm system. See **13, FULL ALARM**.

**Note:** *In this state, an open window or sunroof will cause the alarm to sound due to the movement of air currents. For this reason, make sure that all windows and the sunroof are fully closed before double locking the vehicle.*

### PERIMETER ALARM

The perimeter alarm system is activated when the vehicle is single locked. See **13, SINGLE LOCKING**. Once activated, the alarm system will sound if:

- The bonnet, tailgate or a door are opened.
- The vehicle battery is disconnected.
- An attempt is made to disconnect the alarm siren.

### FULL ALARM

The full alarm system is activated when the vehicle is double locked. See **13, DOUBLE LOCKING**. Once activated the alarm system will sound if:

- The bonnet, tailgate or a door are opened.
- Movement is detected within the vehicle interior.
- A window, front or rear windscreen or sunroof glass are broken.
- The vehicle is raised or tilted.
- The vehicle battery is disconnected.
- An attempt is made to disconnect the alarm system.

### INTERIOR PROTECTION

The interior protection feature of the full alarm system may be temporarily disabled via the **Vehicle Set-Up** menu. see **64, INSTRUMENT PANEL MENU**.

**Note:** *Once enabled, this setting will activate the next time the vehicle is double locked with the Smart Key.*

## Exiting the vehicle

### KEYLESS LOCKING



**Never double lock the vehicle with people, children or pets inside. In the event of an emergency they would be unable to escape and the emergency services would be unable to release them quickly.**



The Smart Key may not be detected if it is placed within a metal container or if it is shielded by a device with a back-lit LCD screen, such as a smart phone, laptop (including laptop bag), games console etc.

**Note:** Loose coins in the same pocket as the Smart Key may also affect its detection.

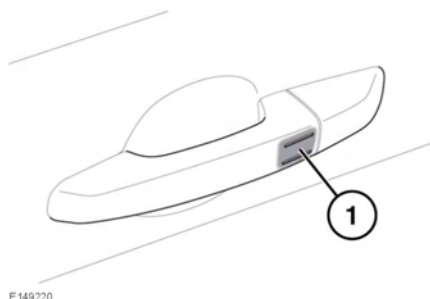

The vehicle will not lock automatically.

**Note:** Keyless locking will activate only if the Smart Key is detected outside the vehicle. If no Smart Key is present, no locking will occur.

- To single lock the vehicle touch only the keyless locking sensor (1) once without grabbing the door handle.

**Note:** Do not place your fingers around the back of the door handle while touching the sensor. Doing so will prevent the vehicle from locking.

- The hazard warning lamps will flash once to confirm locking and the power fold mirrors will fold in (if enabled).

- To double lock the vehicle, touch only the keyless locking sensor (1) twice within 3 seconds.

**Note:** Do not place your fingers around the back of the door handle while touching the sensor. Doing so will prevent the vehicle from locking.

- The hazard warning lamps will flash twice accompanied by an audible sound to confirm locking.

**Note:** When locking the vehicle via Keyless locking, if 1 or more of the doors, the bonnet or the tailgate is not fully closed, or the ignition is ON, the vehicle will NOT lock. There will be NO audible mislock error warning. The hazard warning lamps will NOT flash and the door mirrors (if enabled) will NOT fold in. Check that all doors, the bonnet and the tailgate are closed properly. Make sure that the ignition is turned OFF and lock the vehicle again. If the mislock persists, consult a Land Rover Dealer/Authorised Repairer.

### GLOBAL CLOSING



**Make sure that no children, pets, or obstructions are in any open aperture before operating global closing. Safety mechanisms are in place to prevent serious injury, however injuries can still occur.**

Press and holding the lock button on the Smart Key for 3 seconds. The vehicle will single lock and the full alarm will be activated immediately. After 3 seconds any open windows will be closed. Press the lock button once more to double lock the vehicle.

**Note:** Global closing does not close the sunroof.

This feature can be enabled/disabled via the **Vehicle Set-Up** menu. see **64, INSTRUMENT PANEL MENU**.

## DOOR LOCKS AND RELEASE LEVERS

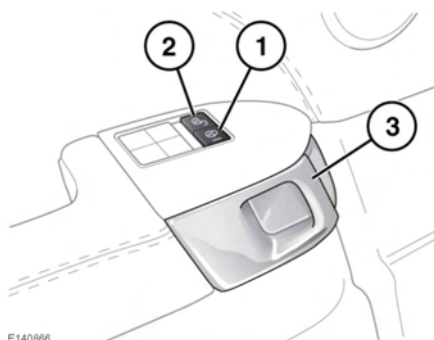

1. Lock:
  - Press the driver or front passenger lock button to lock all doors.
  - Press a rear passenger lock button to lock the individual door.
2. Unlock:
  - Press the driver or front passenger door unlock button to unlock all doors. Alternatively, pull the door release handle (3) once to unlock the individual door.
  - Press a rear passenger door unlock button to unlock the individual door. Alternatively, pull the door release handle (3) once.
3. Door release handle: pull to open the door. If the door is locked, pulling the handle once will unlock the door.

**Note:** The unlock button is inhibited when the vehicle is locked with the Smart Key.

## MISLOCK

When attempting to lock the vehicle with the Smart Key, if 1 or more of the doors, the bonnet or the tailgate is not fully closed or the ignition is ON, the vehicle will NOT lock and an audible warning will sound twice. Ensure the ignition is turned off and lock the vehicle again. The vehicle will NOT fully lock until all doors, the bonnet and the tailgate are completely closed.

## DEACTIVATING THE ALARM WHEN TRIGGERED

If the alarm has been triggered it can be deactivated by pressing the Smart Key unlock button, or by positioning the Smart Key against the steering column. See **99, KEYLESS START BACKUP**.

## EMERGENCY LOCKING

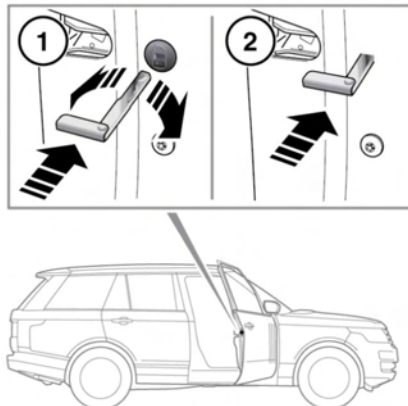

E145208

In the event of the battery discharging or a fault with the keyless locking system, the doors must be locked manually.

## Exiting the vehicle

**Note:** Do not leave the emergency key blade in the vehicle at any point during the emergency locking procedure.

1. Open the door and locate the emergency lock access cover. Using the emergency key blade (see **5, UNLOCKING THE VEHICLE**) rotate the cover to release it from the door.

Remove the cover and store it safely.

2. Insert the emergency key blade firmly into the emergency lock.

The emergency key blade can now be removed.

3. Refit the emergency lock access cover and rotate it clockwise to secure it firmly.

4. Close the door and check to make sure the door is locked.

Repeat the procedure for all other unlocked doors.