

WIPER OPERATION

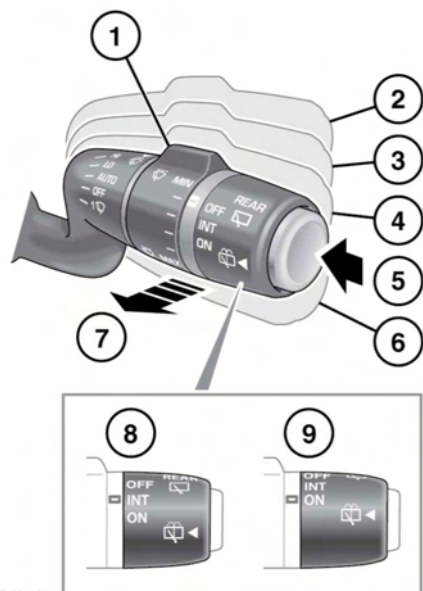

1. Rotate the collar to adjust the front wipers intermittent period. The intermittent delay period will vary and is controlled by either vehicle speed or a rain sensor. The wiper control must be in position (4) to be operational.
2. High speed wipe.
3. Low speed wipe.
4. In this position intermittent wipe is controlled by either a rain sensor (see 47, **RAIN SENSOR**) or vehicle speed (see 47, **SPEED-DEPENDENT MODE**). The rain sensor is located at the upper edge of the windscreen becomes active and will determine when the wipers are required to operate. If the rain sensor is not enabled by your Land Rover Dealer/Authorised Repairer, intermittent wipe will operate in conjunction with the setting of control (1).

5. Rear window wash/wipe. Press and hold to operate the rear washer and wiper. The wiper will operate for 2 further wipes after the button is released. After a few seconds a drip wipe will clear any residual water.
6. Single wipe of windscreen, or hold down for further continuous wipes.
7. Windscreen wash/wipe. Pull and hold to operate the front washers and wipers. The wipers will operate for 3 further wipes after the stalk is released. After a few seconds a drip wipe will clear any residual water.
8. INT - rear wiper, intermittent operation. The delay period and number of wipes will be adjusted automatically depending on vehicle speed.
9. ON - rear wiper, continuous operation.



Do not operate the windscreen wipers on a dry screen.



In freezing or very hot conditions, ensure that the wipers have not stuck to the glass. Use the Winter park position and lift the wiper blades away from the screen.



Remove any snow, ice or frost from the screen, around the wiper arms and blades and the screen scuttle, before operating the wipers.

Note: Front wipers will not operate while the bonnet is open.

Note: If wiper blades become stuck or jammed, an electronic cut-out will temporarily halt wiper operation. If this happens, switch off the wipers and the ignition. Clear any obstructions and free the wiper blades, before attempting to switch on the ignition.



Speed-dependent intermittent wipe on the front screen and intermittent wipe on the rear screen can be enabled/disabled by a Land Rover Dealer/Authorised Repairer.

Wipers service position will move the wipers for wiper blade replacement. See **199, WIPERS SERVICE POSITION**.

SPEED-DEPENDENT MODE

If vehicle speed drops below 8 km/h (5 mph) with the wipers operating, the wipers will switch to the next lowest speed. When vehicle speed increases to over 8 km/h (5 mph), the original wiper speed setting is restored automatically.



This feature can be enabled/disabled by your Dealer/Authorised Repairer.

In vehicles not fitted with a rain sensor, the frequency of intermittent wipe adjusts according to vehicle speed.

The intermittent delay period can be adjusted via the collar on the wiper stalk, but will also reduce automatically as vehicle speed increases.



This feature can be enabled/disabled by your Dealer/Authorised Repairer.

RAIN SENSOR



Ensure that the wipers are switched off before entering a car wash. If the rain sensitive wipers operate during the car washing process, damage may occur to the wiper mechanism.

The rain sensor is able to detect the presence and amount of rain/dirt/snow on the windscreen and automatically activates the windscreen wipers accordingly. Static droplets may not be detected on initial start-up. A single wipe should be used to clear the screen.

To activate the rain sensitive wipers, move the wiper stalk to the rain sensor position and adjust the sensitivity control as required (see **46, WIPER OPERATION**). When rain sensitive wipers are activated and when sensitivity is increased, a single wipe will operate.

HEADLAMP WASHERS

If the headlamps are on, and there is sufficient liquid in the washer reservoir, operating the screen wash will also power-wash the headlamps.

The headlamp power wash will operate on every fifth operation of the screen washer, provided the headlamps are still switched on and approximately 10 minutes have elapsed since the last headlamp wash.

Switching the headlamps or ignition off and back on again, will reset the cycle.

Note: The headlamp washers are inhibited when the washer fluid reservoir level is low.

WINTER PARK POSITION

The wipers can be set to park in a higher position than normal. This allows the wiper blades to be lifted from the screen to prevent freezing. The 'Wipers winter park' option can be selected from the **Vehicle Set-Up** menu. See **64, INSTRUMENT PANEL MENU**.