

## HEADLAMP REMOVAL

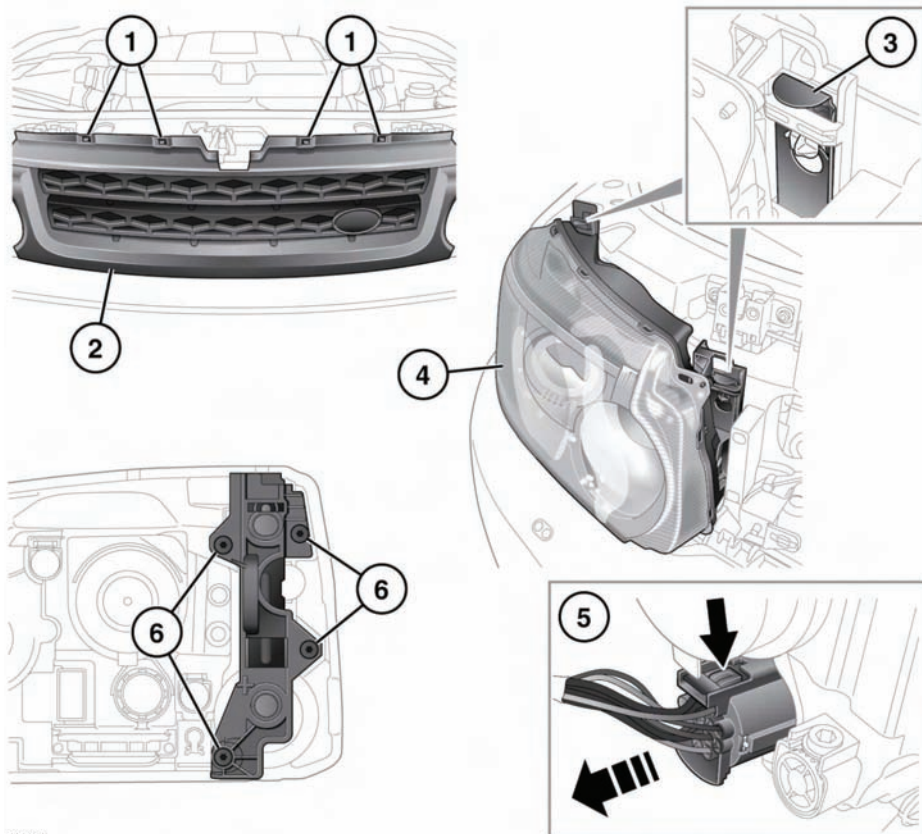

E134987

**⚠ WARNING**

Do not attempt to change any bulb with the lighting switched on. If the lighting has just been switched off, give the bulbs time to cool down. Handling them in a hot condition may cause personal injury.

**NOTICE**

Do not place the removed lamp unit face down on hard or abrasive surfaces. Doing so may scratch the surface of the lens.

1. Press down on the four upper clips, and gently pull the grille forwards.
2. Lift the grille clear of the vehicle and place it where it will not be damaged.
3. Carefully lever up the locking tabs securing the rear of the headlamp. Hold the headlamp in position while doing so.
4. Holding the front of the lamp, lift forwards and clear of the body.