



**WARNING - THAT NO PERSON SHOULD PLACE ANY PORTION OF THEIR BODY UNDER A VEHICLE THAT IS SUPPORTED BY A JACK.**

1. Assemble the cranking lever as shown.
2. Attach the cranking lever to the jack using the adaptor.
3. Fit the wheel nut brace onto the end of the cranking lever. With the jack located under the correct jacking point, rotate the cranking lever clockwise to raise the vehicle.

## LOCKING WHEEL NUTS

Locking wheel nuts can only be removed and installed using the special adapter provided in the tool kit.

**Note:** A code number is stamped onto the underside of the adapter. Ensure the number is recorded in the Service Portfolio supplied with the literature pack. If a replacement adapter is required, you will be asked to quote this number. The Service Portfolio must be kept safe, but should not be kept in the vehicle.

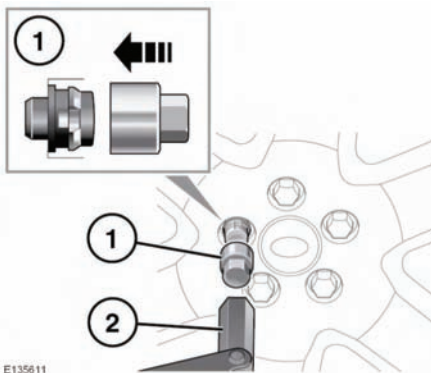

To release:

1. Insert the wheel nut adapter into the locking wheel nut, ensuring that it is fully engaged.

2. Use the wheel brace to turn the wheel nut and adapter.

**Note:** After use store the wheel nut adapter correctly in the tool kit.

## WHEEL CHANGING

1. Read and observe the WARNINGS before changing a wheel, see **217, WHEEL CHANGING SAFETY**.
2. Before raising the vehicle, use the wheel nut brace to slacken the wheel nuts half a turn anti-clockwise.
3. Position the jack under the relevant jacking point. For coil suspension vehicles this is located on the lower suspension arm, for air suspension vehicles this is under the chassis. Refer to the correct diagram above for your vehicle.
4. Turn the jack lever clockwise to raise the jack cradle until it engages with the jacking point. Ensure that the base of the jack is in full contact with the road surface.
5. Raise the vehicle using the jack with a slow steady operation. Avoid rapid, jerky actions as they may cause the vehicle/jack to become unstable.
6. Remove the wheel nuts and place them together where they cannot roll away.
7. Remove the wheel and place to one side. Do not lay the wheel on its face, as this may damage the finish.
8. Fit the spare wheel to the hub.
9. Re-fit the wheel nuts, and lightly tighten them. Ensure that the wheel is making contact with the hub evenly.
10. Ensure that the space under the vehicle is clear of obstructions, and lower the vehicle slowly and smoothly.