

USING THE NAVIGATION SYSTEM

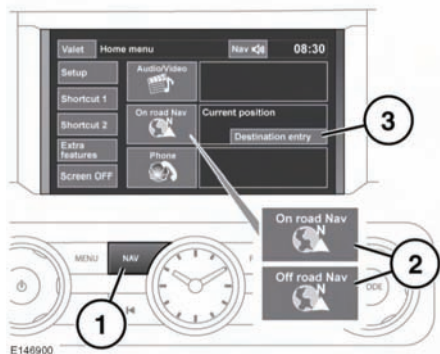

1. **NAV** shortcut button, press for navigation.
2. **Navigation** soft key, touch for navigation.
3. **Destination entry**. Touch for shortcut to destination entry menu.

Note: On vehicles with off-road navigation, the soft key includes **On road** or **Off road**, to show the current Navigation mode.

If the navigation screen language has not been set, select **Language**, and touch **OK** to confirm. The **CAUTION** screen will return.

After touching **Agree**, the touch screen will display the previously displayed map view. This will show the current vehicle position. Touch the **Nav menu** soft key to display the main menu screen.

At this point, the first time user should set up personal preferences in the **Nav set-up** area. These settings are applied whenever navigation is used.