

WIPER OPERATION

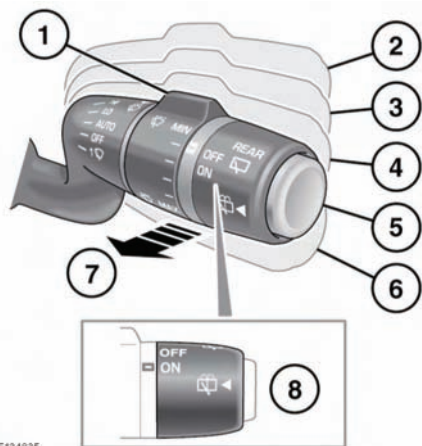

Feature (1) can be enabled/disabled by your Dealer/Authorised Repairer.

1. Intermittent wipe delay: Rotate the control to adjust the intermittent period. The intermittent delay period will vary and is controlled by either vehicle speed or a rain sensor. The control must be in position (4) to be operational.
2. High speed wipe.
3. Low speed wipe.
4. AUTO or intermittent wipe: AUTO is controlled by either a rain sensor or vehicle speed. In this position, the rain sensor becomes active and will determine when the wipers are required to operate.
If your rain sensor is not configured by your Dealer/Authorised Repairer, intermittent wipe will operate in conjunction with the setting of control (1).

5. Rear window wash/wipe: Press and hold to operate the rear washer and wiper. The wiper will operate for two further wipes after the button is released. After a few seconds a drip wipe process will clear any residual water.
6. Single wipe of windscreen, or hold down for further continuous wipes.
7. Windscreen wash/wipe: Pull and hold to operate the front washers and wipers. The wipers will operate for three further wipes after the stalk is released. After a few seconds a drip wipe will clear any residual water.
8. Rear wiper: To operate, rotate to **ON**.



Do not operate the windscreen wipers on a dry screen.



In freezing or very hot conditions, ensure that the wipers have not stuck to the glass.



Remove any snow, ice or frost from the screen, around the wiper arms and blades and the screen scuttle, before operating the wipers.

Note: If the wiper blades become stuck or jammed, an electronic cut-out may temporarily halt wiper operation. If this happens, switch off the wipers and the ignition. Clear any obstructions and free the wiper blades, before attempting to switch on the ignition.

SPEED-DEPENDENT MODE

If vehicle speed drops below 8 km/h (5 mph) with the wipers operating, the wipers will switch to the next lowest speed. When vehicle speed increases to over 8 km/h (5 mph), the original wiper speed setting is restored automatically.

In vehicles not fitted with a rain sensor, the frequency of intermittent wipe adjusts according to vehicle speed.