

# Load carrying

The maximum load for a Land Rover approved roof rack system is 165 lb (75 kg) while driving on road. Off road driving reduces the limit to 110 lb (50 kg). The weight of the approved roof rack system is not calculated as part of the load.

If an alternative roof rack system is used, the weight of that system must be included as part of the load weight.

Loads must be evenly distributed without overhanging the rack. After traveling 30 miles (50km) check the security of the roof rack and any load.

## LUGGAGE ANCHOR POINTS

1. Bag hooks.
  - The bag hooks should be used only to secure light items such as shopping bags.
2. Load securing lashing eyes.
  - To assist in safely securing large items of luggage, four lashing eyes are located in the rear loadspace floor. If adjustable lashing eyes are fitted, first turn the locking button counter clockwise to unlock. Press the button and slide to the required position in the luggage rail. Release the button to latch into position. Move the lashing eye slightly until you hear a click. The lashing eye is now secured. Turn the button clockwise to lock.

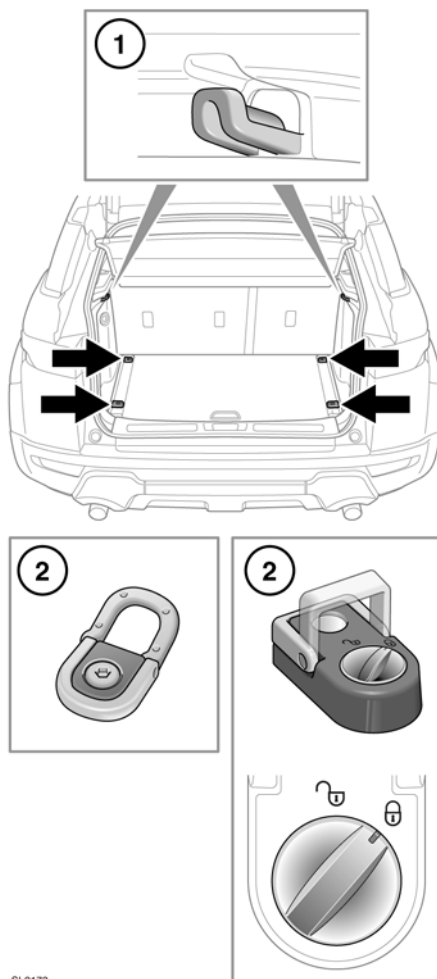

SL2173

**Note:** A range of approved luggage retention accessories is available from your Land Rover Retailer.