

⚠ WARNING

Remove all metal jewelry before working on or near the battery, and never allow metal objects or vehicle components to come into contact with the battery terminals.

NOTICE

Do not allow battery fluid to come into contact with fabrics or painted surfaces. If battery fluid comes into contact with any surface, the surface should be washed down immediately with plenty of clean water.

Your vehicle will be fitted with either an 80 amp hr low maintenance battery or an 80 amp hr Absorbed Glass Mat (AGM) battery. AGM batteries are sealed for life and require no maintenance.

⚠ CAUTION

Do not attempt to open or remove the top from an AGM battery.

In hot climates more frequent checks of the low maintenance battery electrolyte level and condition are required. If necessary, the battery cells can be topped up using distilled water.

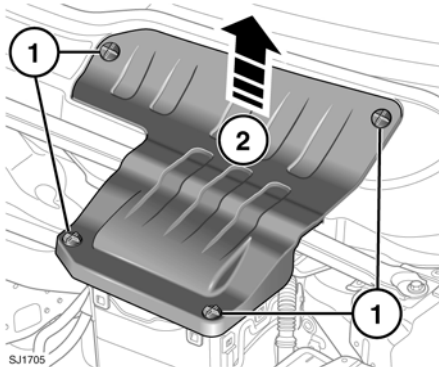

1. Turn the four fasteners 90 degrees counter-clockwise to release.

2. Remove the battery cover.

Unscrew the six battery cell plugs and store carefully.

Check that the surface of the liquid (electrolyte) is level with the plastic level indicator. If necessary, top up with distilled water, but never overfill. Refit the six cell plugs.

The battery cover must be refitted as soon as possible to ensure that the battery positive terminal is insulated.

STARTING A DISABLED VEHICLE USING JUMP LEADS

⚠ WARNING

Always wear appropriate eye protection when working with batteries.

⚠ WARNING

Make sure both batteries are of the 12 volt type and that the jump leads have insulated clamps and are approved for use with 12 volt batteries.

⚠ WARNING

Do not disconnect the discharged battery.

⚠ WARNING

Ensure the bodywork of the donor and disabled vehicles do not touch.

⚠ WARNING

Do not connect a jump lead to the negative (-) terminal of the battery. Always connect to the recommended earthing point.

⚠ WARNING

Before attempting to start the disabled vehicle, make sure that the parking brake is applied, or suitably chock the wheels. Make sure that Park is selected.

⚠ WARNING

To avoid serious injury use extreme caution when removing the jump leads as the engine will be running on the previously disabled vehicle. This means that you may be working close to components which are moving at high speed, carry high voltage, or may be hot.

Note: Do not switch on any electrical equipment until after the cables have been disconnected.

Note: Before connecting jump leads ensure that the battery connections on the discharged battery are correct and that all electrical equipment has been switched off.

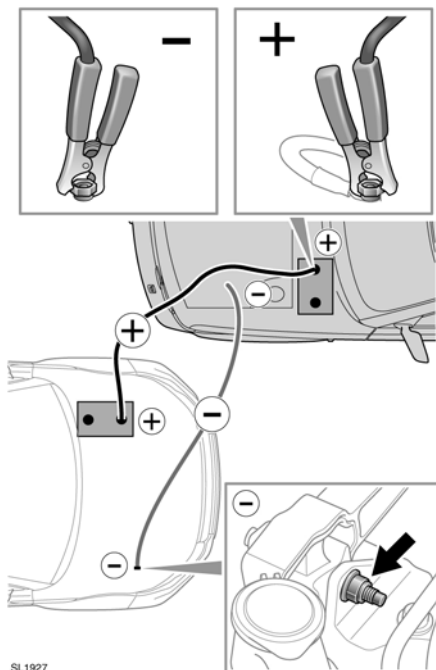

SL1927

1. Connect the positive (Red) jump lead to the positive (+) terminal on the donor vehicle's battery.
2. Connect the other end of the positive jump lead to the positive (+) terminal on the discharged battery.
3. Connect the negative (Black) jump lead to the recommended jump starting earth point of the donor vehicle.
4. Connect the other end of the negative jump lead to the earth point indicated.

Note: Check that all cables are clear of any moving components and that all four connections are secure.

5. Start the engine of the donor vehicle and allow it to idle for a few minutes.