

## LATCH CHILD RESTRAINT ANCHOR POINTS

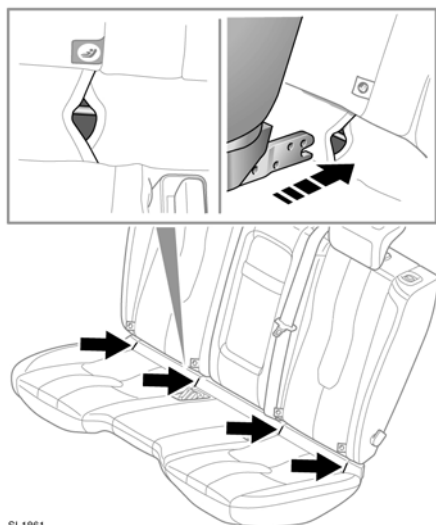

SL1861

LATCH anchorage child restraints can be fitted only to the outer seat positions on the second row of seats.



This symbol is shown on a label sewn into the seats to indicate the position of the LATCH lower anchorages.

To install a LATCH anchorage child seat:-

1. Locate the LATCH locking mechanism.
2. For child seats fitted with **rigid** lower LATCH connectors, slide the child seat locking mechanism into the protective sleeves and onto the anchor bars.

For child seats fitted with **non-rigid** LATCH connectors, connect the lower tether strap hooks to the anchor bars and tighten the straps.

3. If an upper tether is fitted to the child seat, ensure it is properly secured to the upper tether anchorages on the rear of the seats.

Test the security of the child restraint. To do this, attempt to pull the restraint away from the vehicle seat and twist the restraint from side to side. Even if the restraint appears secure, you should still check the anchor points visually, to ensure correct attachment.

### **⚠ WARNING**

Do not attempt to fit a LATCH child restraint to the center rear seating position. The anchor bars are not designed to hold a LATCH child restraint in this position. Install only using seat belts (non-LATCH system) and the top tether at this position.

### **⚠ WARNING**

If the restraint is not correctly anchored, there is a significant risk of injury to the child in the event of a collision or emergency braking.

### **⚠ WARNING**

Child restraint anchorages are designed to withstand only those loads imposed by correctly fitted child restraints. Under no circumstances are they to be used for adult seat belts, harnesses or for attaching other items or equipment to the vehicle.

## ATTACHING TETHER ANCHORAGE STRAPS

### **⚠ WARNING**

Always follow the child seat or restraint system manufacturer's instructions when fitting tether straps.

### **⚠ WARNING**

**When fitting a child seat or restraint system, always pass the tether strap over the top of the seat back and beneath the head restraint.**

### **⚠ WARNING**

**If removing a head restraint in order to fit a child restraint, always secure the head restraint when storing it.**

### **⚠ WARNING**

**If a child seat or restraint system is to be fitted to the center seating position, the center armrest must be in the stowed position (folded into the seat).**

Your vehicle is equipped with tether strap anchorage points behind the second row seat frames. These should be used to attach straps from child seats or restraint systems.

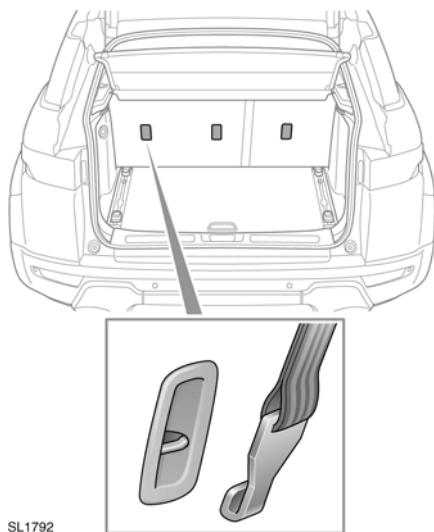

SL1792

1. Install the child restraint securely in one of the rear seating positions.
2. Pass the tether strap over the seat back and beneath the head restraint.
3. Attach the tether strap hook to the tether anchor point on the back of the seat. Ensure that the tether strap hook is facing the towards the back of the seat.
4. Tighten the tether strap according to the child restraint manufacturer's instructions.