

## EXTERIOR MIRRORS

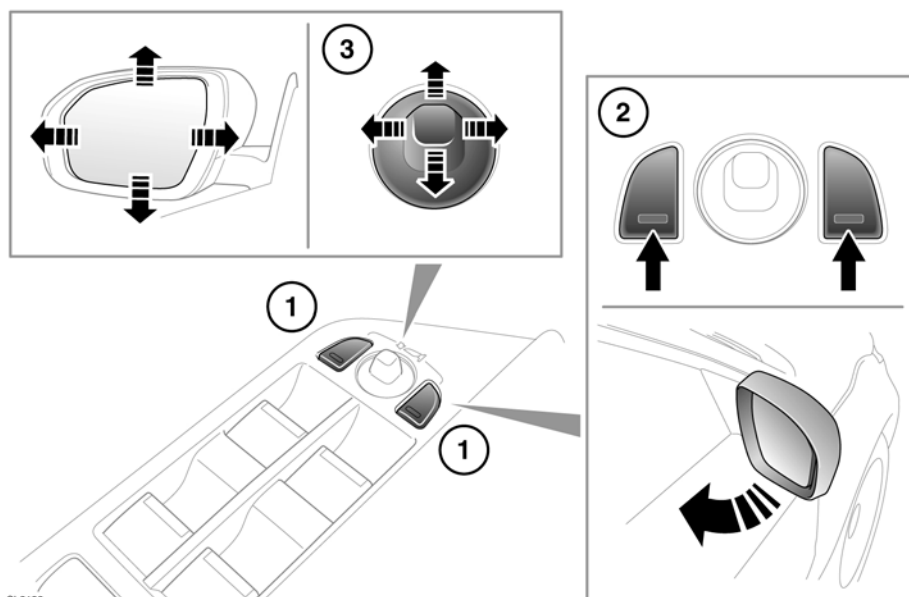

1. Mirror selector switches. Press to select the left or right mirror.
2. Press both selector switches together to fold/unfold the mirrors.
3. Mirror adjustment switch. Move up/down/left or right to adjust the mirror glass position.

The mirrors can be adjusted and folded when the ignition is on and for up to 5 minutes after the ignition is switched off, provided the driver's door is not opened.

**Note:** Powerfold will operate only if the vehicle speed is below 70 mph (113 km/h).

**Note:** The rear view door mirror heaters operate automatically according to the external temperature and windshield wiper operation.

**Note:** An amount of knock protection is designed into the door mirrors. If a mirror is accidentally knocked inwards or manually folded inwards, the mirror head will be disengaged from the folding mechanism. To re-engage the mechanism, fold then unfold the mirror using the switch.

**Note:** A thermal cut-out which will temporarily disable the powerfold feature if the switches are operated repeatedly.