

RECOVERY METHOD

The method for recovery/ transportation of the vehicle is on a transporter or trailer designed for that purpose.

Ensure that transportation is carried out by suitably qualified person and that the vehicle is secured correctly.

This vehicle should **NOT** be towed on all four wheels, nor should it be recovered with the front wheels suspended.

FRONT AND REAR TOWING POINTS

⚠ WARNING

The towing points at the front and rear of the vehicle are designed for on-road recovery only. If they are used for any other purpose, it may result in vehicle damage and serious injury.

⚠ WARNING

Use extreme caution when moving or towing the vehicle. Death or serious injury may occur.

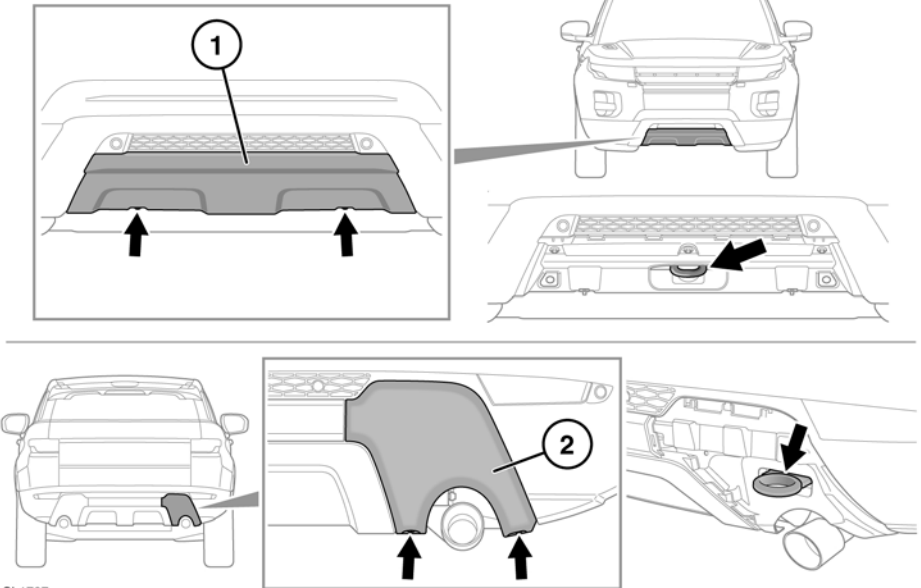

SL1787

The towing points are located behind panels in the bumpers. Panel design will vary depending on the vehicle specification.

To access the towing points:

1. Front bumper - rotate the two fasteners 90 degrees counter clockwise. Pull the panel away from the front bumper.