

Blind spot monitoring

BLIND SPOT MONITOR

⚠ WARNING

The Blind Spot Monitor (BSM) system is a supplement to, not a replacement for, a safe driving style and use of the exterior and rear-view mirrors.

⚠ WARNING

Please note that BSM may not be able to give adequate warning of vehicles approaching very quickly from behind or vehicles that are being overtaken rapidly.

⚠ WARNING

BSM may not be able to detect all vehicles and may also detect objects, such as roadside barriers, etc.

⚠ WARNING

The radar sensors may be impaired by rain, snow or road spray. This may affect the system's ability to reliably detect a vehicle/object within the blind spot.

NOTICE

Ensure that the warning indicators in the exterior mirrors are not obscured by stickers or other objects.

NOTICE

Do not attach stickers or objects to the bumpers, that may interfere with the radar sensors.

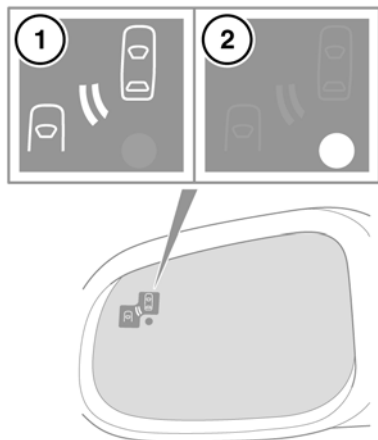

SJ1010

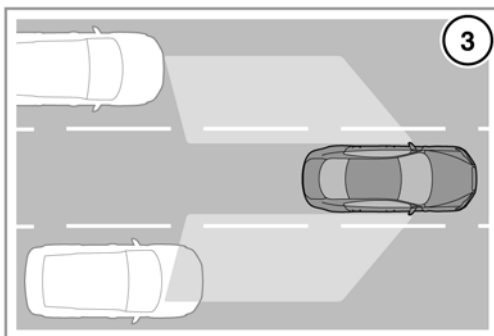

The Blind Spot Monitor (BSM) system monitors a zone that covers the area adjacent to the vehicle, that is not easily visible by the driver and is designed to identify any object overtaking the vehicle (3). The system uses a radar on each side of the vehicle to identify any overtaking vehicle/object within the blind spot

area of the vehicle, while disregarding other objects which may be stationary or traveling in the opposite direction.